

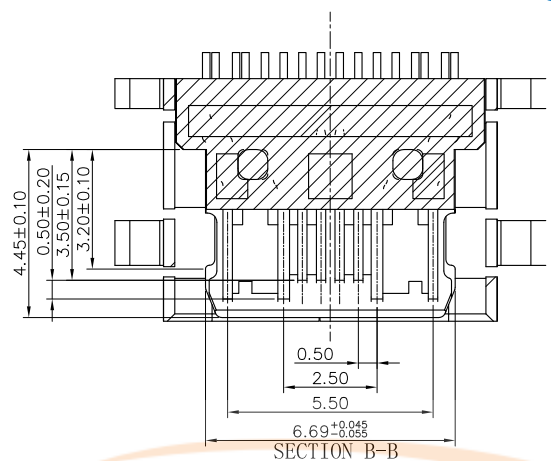

REV.	DESCRIPTION	NAME	DATE

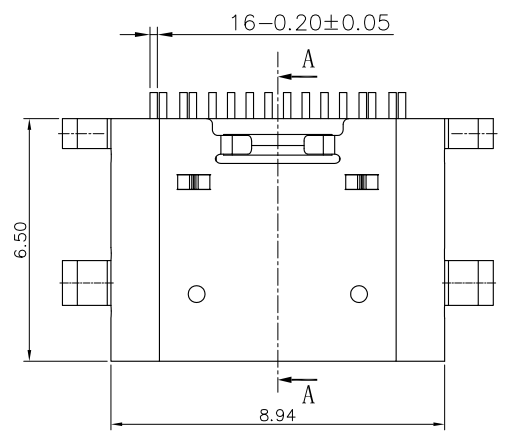

SECTION B-B
SCALE 1:1

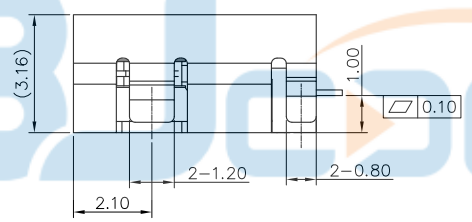
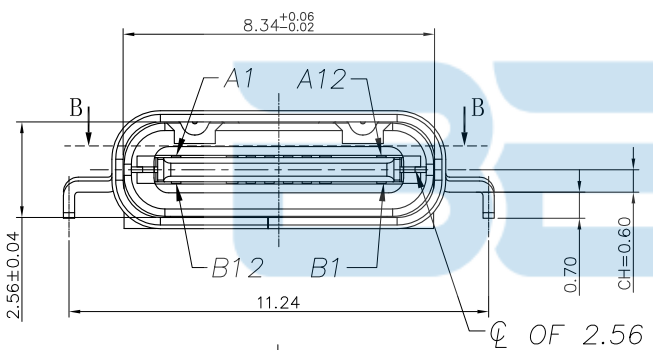

Φ OF 2.56

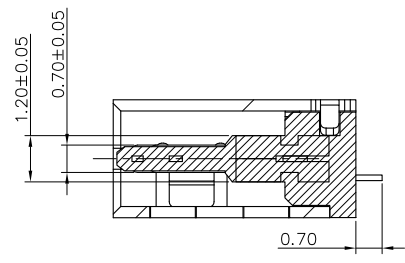
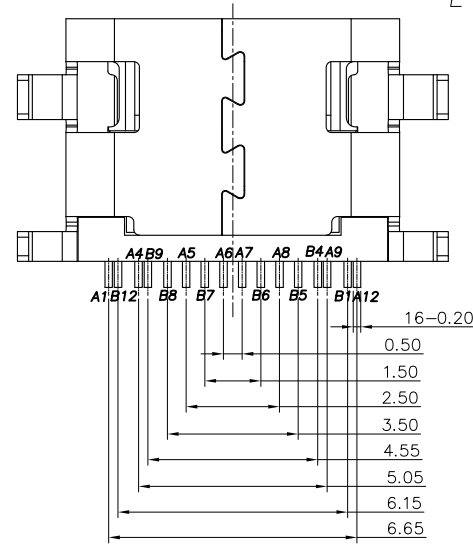

SECTION B-B
SCALE 1:1

NOTE:

- MATERIAL SPECIFICATION:
 - HOUSING: HIGH TEMPERATURE RESISTANT PLASTIC, UL94 V-0.
 - CONTACTS: COPPER ALLOY
 - MID PLATE: STAINLESS STEEL
- PLATING SPECIFICATION:
 - CONTACTS:
 - Ni 50μ" MIN. UNDER PLATED OVER ALL.
 - Au PLATED ON THE FUNCTIONAL AREA OF CONTACT.
 - GOLD FLASH PLATING ON SOLDER AREA
- FRONT SHELL:
 - Ni 30μ" MIN. UNDER PLATED OVER ALL.
- MECHANICAL PERFORMANCE,
 - INSERTION FORCE: 0.5~2.0kgf.
 - REMOVAL FORCE: 0.8kgf~2.0kgf.
 - DURABILITY: 10000 CYCLES.
- ELECTRICAL PERFORMANCE,
 - CURRENT RATING: 5A
VOLTAGE RATING: 20V
 - INSULATION RESISTANCE: 100MΩ MIN
 - DIELECTRIC WITHSTAND VOLTAGE, AC 100V FOR 1 MINUTE.
 - LOW CONTACT RESISTANCE: INITIAL 40MΩ
- ENVIRONMENTAL PERFORMANCE:
 - OPERATING TEMPERATURE: -30° C~+80° C.
- IR REFLOW:

AFTER 50MΩ
THE PEAK TEMPERATURE ON THE BOARD SHALL
BE MAINTAINED FOR 10 SECONDS AT 260° C.



TOLERANCE UNSPECIFIED	
.0	±0.35
.00	±0.25
.000	±0.15
X.°	±2.00°
ASSEMBLY DRAWING	
DRAWN/ DATE	设计 HMY
CHECKED/ DATE	审核 LYX
APPROVED/ DATE	核准 LJP

深圳市步步精科技有限公司			
TITLE: TYPE-C 16P 母座 L=6.5 沉板1.0 CH=0.6 铜合金端子			
DRAWN/ DATE	设计 HMY	SIZE:A4	UNIT:MM.
CHECKED/ DATE	审核 LYX	PART. NO: UC.01.31-11-0008	SCALE: 1:1
APPROVED/ DATE	核准 LJP	DWG. PATH	PROJECTION
		0100-2	REV.: 版本
			SHEET: 页码

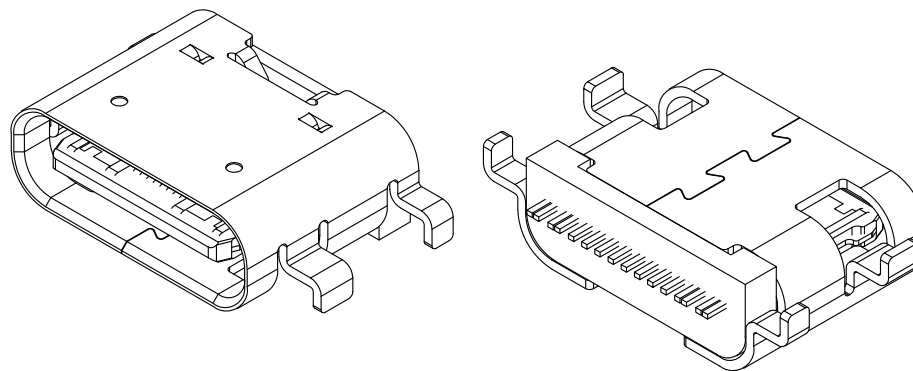

USB TYPE-C PIN ASSIGNMENTS

PIN NUMBER	SIGNAL NAME	PIN NUMBER	SIGNAL NAME
A1	GND	B12	GND
A4	VBUS	B9	VBUS
A5	CC1	B8	SBU2
A6	Dp1	B7	Dn2
A7	Dn1	B6	Dp2
A8	SBU1	B5	CC2
A9	VBUS	B4	VBUS
A12	GND	B1	GND

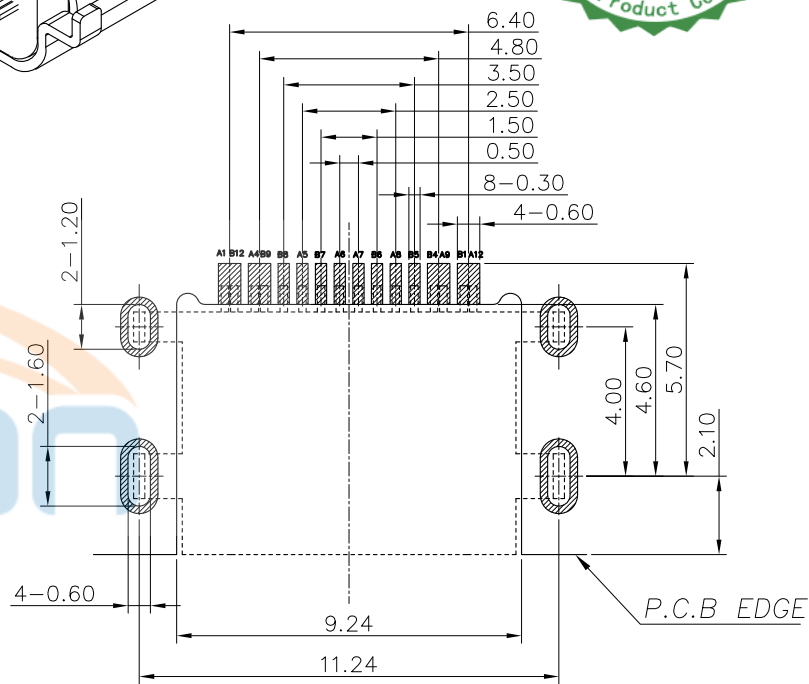

RECOMMEND P.C.B LAYOUT(COMPONENT SIDE)
TOLERANCE FOR PCB LAYOUT IS ± 0.05

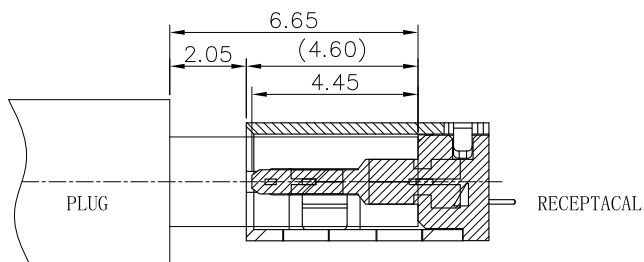

ARTER MATING
SCALE 1:1



TOLERANCE UNSPECIFIED		深圳市步步精科技有限公司 TITLE: TYPE-C 16P 母座 L=6.5 沉板1.0 CH=0.6 铜合金端子				
.0	± 0.35					
.00	± 0.25	DRAWN/ 设计 HMY		SIZE:A4	UNIT:MM.	PART. NO: UC.01.31-11-0008
.000	± 0.15	CHECKED/ 审核 LYX		SCALE: 1:1		PROJECTION
X.°	$\pm 2.00^\circ$	APPROVED/ 核准 LJP		DWG. PATH	REV.: 版本	
ASSEMBLY DRAWING				0100-2		SHEET: 页码



REV.	DESCRIPTION	NAME	DATE

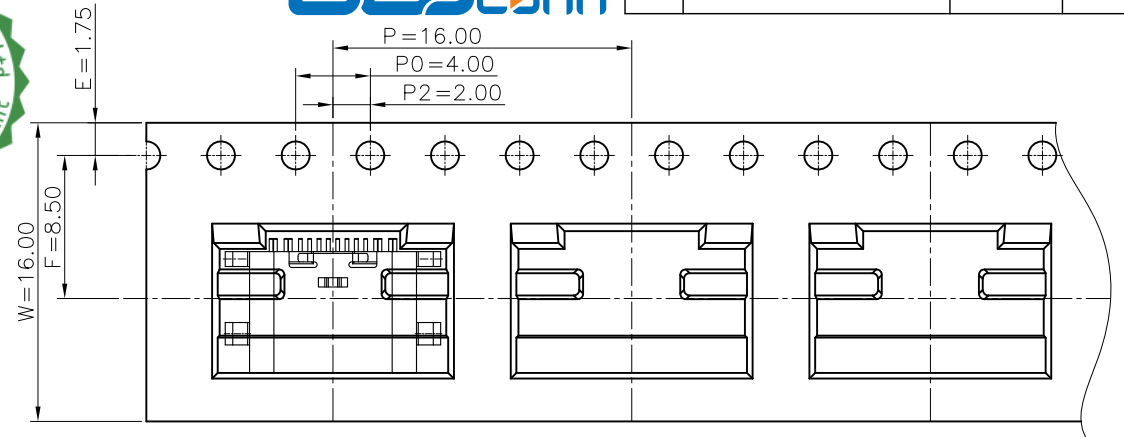
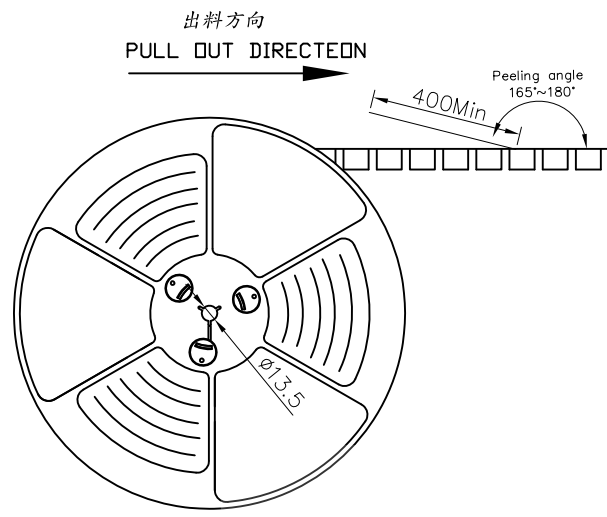

NOTES

1. 帶子引導長度
LEAD TAPE LENGTH

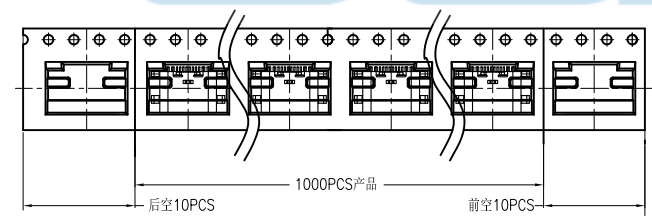

2. 上帶 剝力力為：0.1~1.3N(10.2gf~130gf)
PEELING OFF FORCE OF TOP TAPE: 0.1~1.3N(10.2gf~130gf)

出貨運輸過程中一定注意：
THIS REQUIREMENT SHOULD BE APPLIED AT SHIPMENT:
卷帶在運輸過程中不能散開
PEELING OFF SHOULD NOT BE ALLOWED DURING TRANSPORTATION

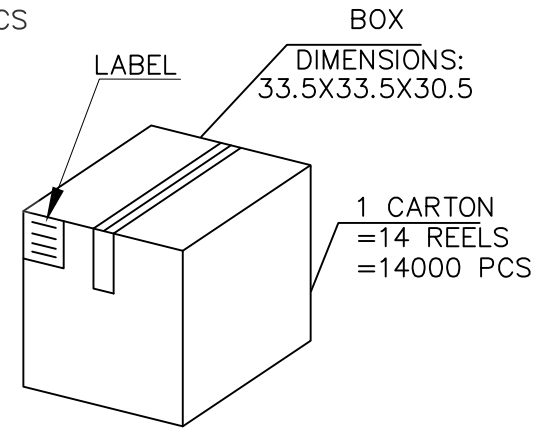
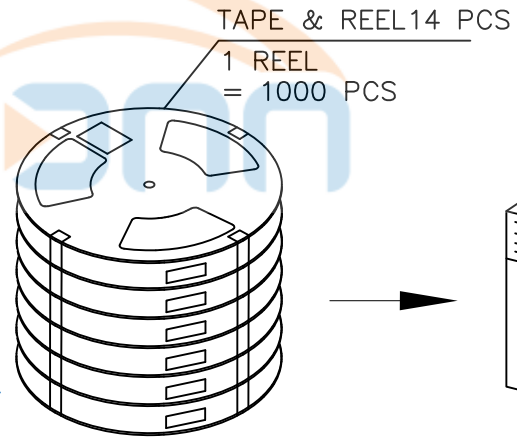

包裝明細表 (The detail of the packing) Carton					
包裝容量 (Packing Capacity)			重量 Weight (Kg)		
pcs/box	boxes/Carton	Pcs/Box	N. W. /Pcs	N. W. /Box	G. W. /Box
1000	14	14000	---	---	---

TOLERANCE UNSPECIFIED		深圳市步步精科技有限公司 TYPE-C 16P 母座 L=6.5 沉板1.0 CH=0.6 铜合金端子			
.0	±0.35	DRAWN/ DATE	设计 HMY	SIZE:A4	UNIT:MM.
.00	±0.25	CHECKED/ DATE	审核 LYX	PART. NO: UC.01.31-11-0008	SCALE: 1:1
.000	±0.15	APPROVED/ DATE	核准 LJP	DWG. PATH	PROJECTION
X. °	±2.00°				REV.: 版本
					SHEET: 页码