

SECTION B-B
SCALE 1:1

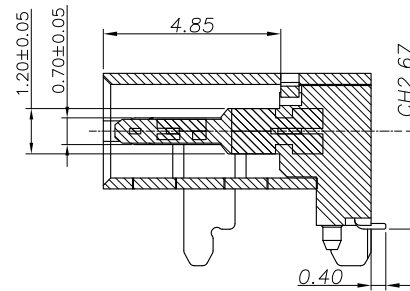

SECTION A-A
SCALE 1:1

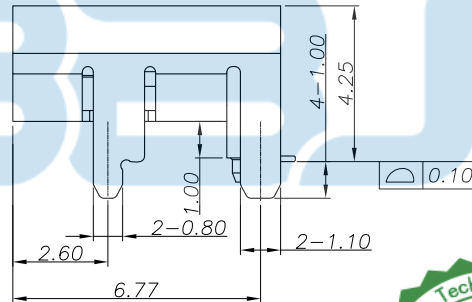
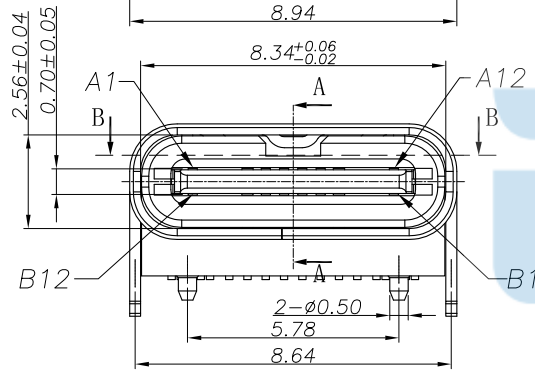
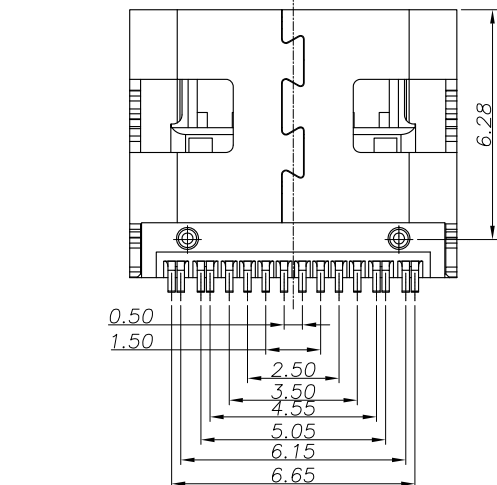

NOTE:

- 1.MATERIAL SPECIFICATION:
 - 1.HOUSING:HIGH TEMPERATURE RESISTANT PLASTIC,UL94 V-0. LCP
 - 2.CONTACTS:COPPER ALLOY H65
 - 3.MID PLATE: STAINLESS STEEL SUS301
- 2.PLATING SPECIFICATION:
 - 2-1.CONTACTS:
Ni 50u" MIN. UNDER PLATED OVER ALL.
Au PLATED ON THE FUNCTIONAL AREA OF CONTACT.
GOLD FLASH PLATING ON SOLDER AREA
 - 2-2.FRONT SHELL:
Ni 30u" MIN. UNDER PLATED OVER ALL.
- 3.MECHANICAL PERFORMANCE,
 - 3-1.INSERTION FORCE: 0.5~2.0kgf.
 - 3-2.REMOVAL FORCE: 0.8kgf~2.0kgf.
 - 3-3.DURABILITY: 10000 CYCLES.
- 4.ELECTRICAL PERFORMANCE,
 - 4-1. CURRENT RATING: 5A
VOLTAGE RATING: 20V
 - 4-2.INSULATION RESISTANCE: 100MΩ MIN
 - 4-3.DIELECTRIC WITHSTAND VOLTAGE,AC 100V FOR 1 MINUTE.
 - 4-4.LOW CONTACT RESISTANCE: INITIAL 40MΩ
AFTER 50MΩ
5. ENVIRONMENTAL PERFORMANCE:
OPERATING TEMPERATURE: -30°C~+80°C.
- 6.IR REFLOW:
THE PEAK TEMPERATURE ON THE BOARD SHALL
BE MAINTAINED FOR 10 SECONDS AT 260°C.



TOLERANCE UNSPECIFIED		深圳市步步精科技有限公司 TITLE: TYPE-C 16P 母座 板上型 L=7.35 垫高1.0 CH2.6Z			
.0	±0.35				
.00	±0.25	DRAWN/ DATE		设计	HMY
.000	±0.15	CHECKED/ DATE	审核	LYX	SIZE:A4
X. °	±2.00°	APPROVED/ DATE	核准	LJP	UNIT:MM.
CUSTOMER DRAWING		PART. NO:		UC.01.51-11-0027	
		SCALE: 1:1		PROJECTION	REV.: 版本
		DWG. PATH		0100-2	SHEET: 页码



	7	8
REV.	DESCRIPTION	NAME
A	NEWS ISSUE	
		DATE

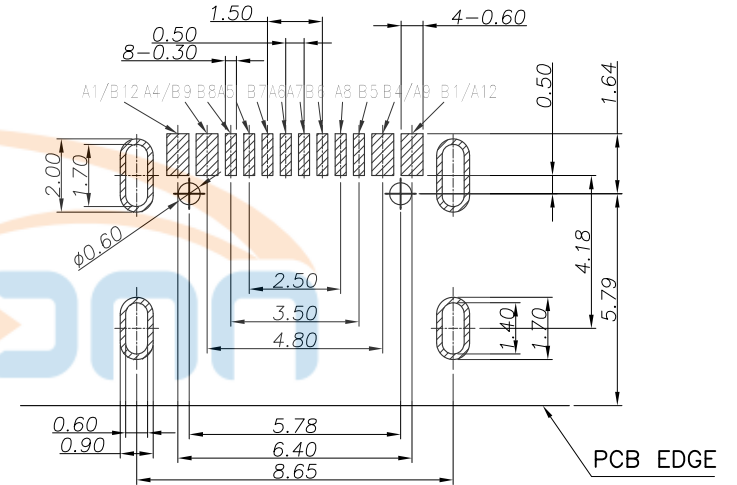
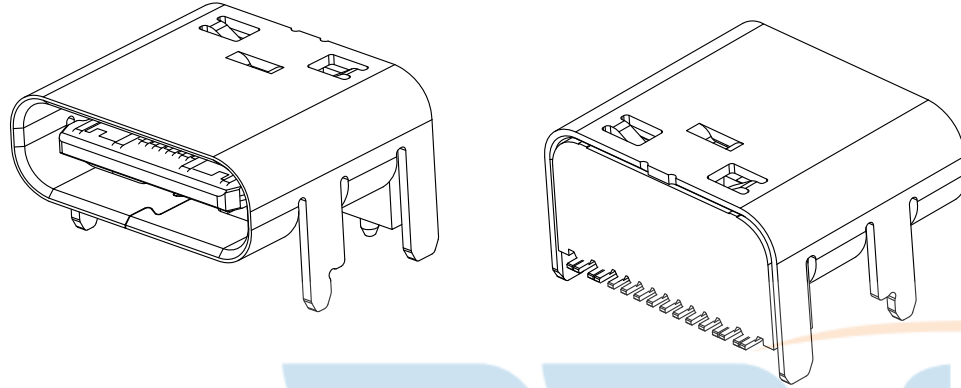

USB TYPE-C PIN ASSIGNMENTS

PIN NUMBER	SIGNAL NAME
A1	GND
A4	VBUS
A5	CC1
A6	Dp1
A7	Dn1
A8	SBU1
A9	VBUS
A12	GND

PIN NUMBER	SIGNAL NAME
B12	GND
B9	VBUS
B8	SBU2
B7	Dn2
B6	Dp2
B5	CC2
B4	VBUS
B1	GND

RECOMMEND P.C.B LAYOUT(COMPONENT SIDE)
TOLERANCE FOR PCB LAYOUT IS ± 0.05



TOLERANCE UNSPECIFIED		深圳市步步精科技有限公司 TITLE: TYPE-C 16P 母座 板上型 L=7.35 垫高1.0 CH2.67	
.0	± 0.35	DRAWN/	设计 HMY
.00	± 0.25	DATE	
.000	± 0.15	CHECKED/	审核 LYX
X.°	$\pm 2.00^\circ$	DATE	
CUSTOMER DRAWING		APPROVED/	核准 LJP
DATE		DATE	
SIZE: A4	UNIT: MM.	PART. NO:	UC.01.51-11-0027
SCALE: 1:1	PROJECTION	REV.:	版本
DWG. PATH		SHEET:	页码
		0100-2	

REV.	DESCRIPTION	NAME	DATE
A	NEWS ISSUE		



出料方向

PULL OUT DIRECTEON

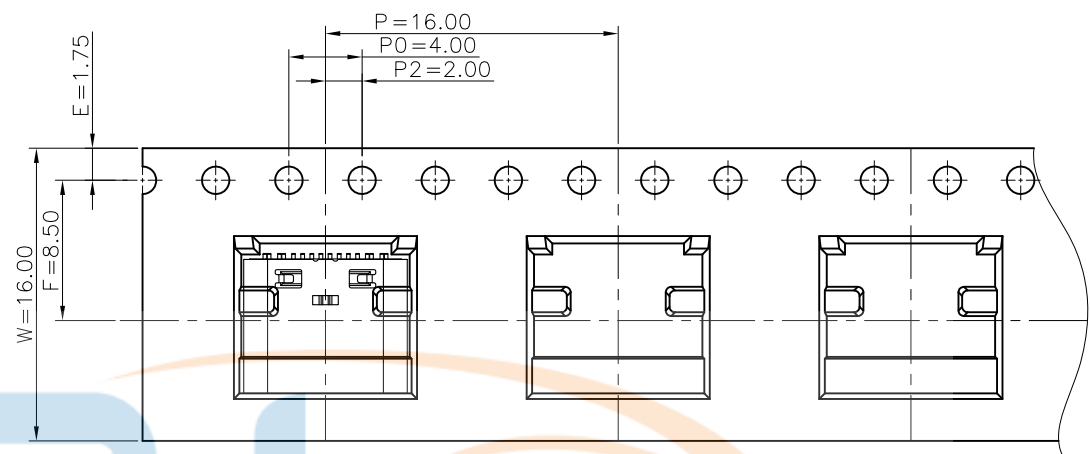
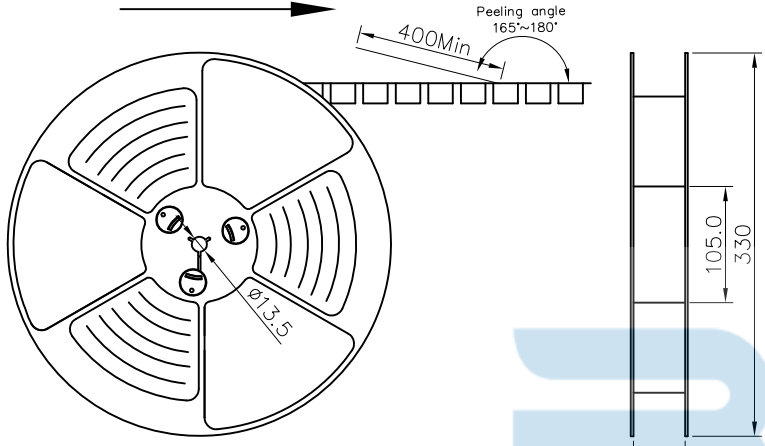

NOTES

1. 帶子引導長度
LEAD TAPE LENGTH
出料方向
PULL OUT DIRECTEON

出料方向
PULL OUT DIRECTEON

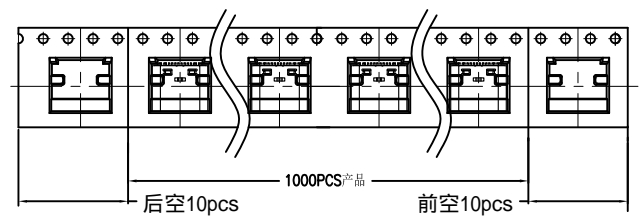

2. 上帶 剝力力為：0.1~1.3N(10.2gf~130gf)
PEELING OFF FORCE OF TOP TAPE:0.1~1.3N(10.2gf~130gf)
出貨運輸過程中一定注意：
THIS REQUIREMENT SHOULD BE APPLIED AT SHIPMENT：
卷帶在運輸過程中不能散開
PEELING OFF SHOULD NOT BE ALLOWED DURING TRANSPORTATION



TAPE & REEL 14 PCS
1 REEL = 1000 PCS

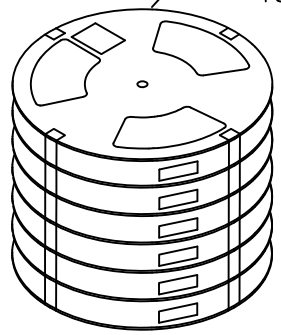

BOX DIMENSIONS: 33.5X33.5X30.5

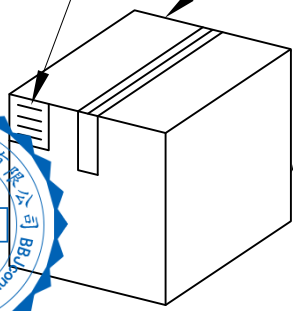

1 CARTON = 14 REELS = 14000 PCS

TOLERANCE UNSPECIFIED	
.0	±0.35
.00	±0.25
.000	±0.15
X.°	±2.00°
CUSTOMER DRAWING	

深圳市步步精科技有限公司

TITLE: TYPE-C 16P 母座 板上型 L=7.35 墊高1.0 CH2.67

包裝明細表 (The detail of the packing) Carton						
產品料號 (Product No.)	包裝容量 (Packing Capacity)			重量 Weight (Kg)		
	pcs/box	boxs/Carton	Pcs/Box	N.W./Pcs	N.W./Box	G.W./Box
	1000	14	14000	---	---	---

DRAWN/DATE	设计 HMY	SIZE:A4	UNIT:MM.	PART. NO:	UC.01.51-11-0027	
CHECKED/DATE	审核 LYX	SCALE: 1:1		PROJECTION	REV.: 版本	
APPROVED/DATE	核准 LJP	DWG. PATH			0100-2	SHEET: 页码