

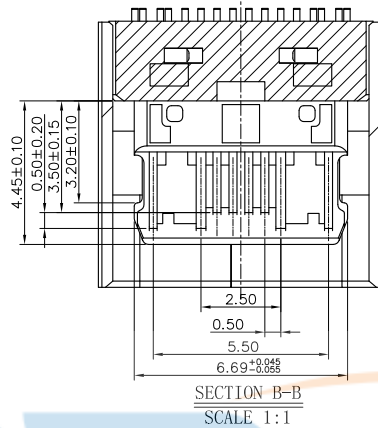

REV.	DESCRIPTION	NAME	DATE
A	NEWS ISSUE		

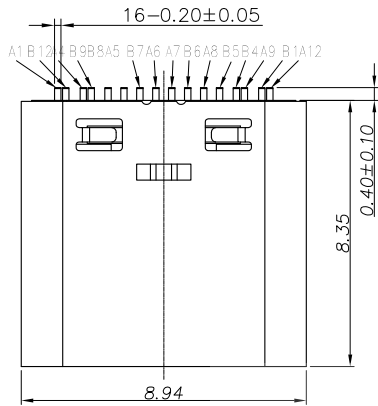

NOTE:

- MATERIAL SPECIFICATION:
  - HOUSING: HIGH TEMPERATURE RESISTANT PLASTIC, LCP UL94 V-0.
  - CONTACTS: COPPER ALLOY C2680
  - MID PLATE: STAINLESS STEEL SUS301
  - FRONT SHELL: STAINLESS STEEL SUS304
- PLATING SPECIFICATION:
  - CONTACTS:
    - Ni 50u" MIN. UNDER PLATED OVER ALL.
    - Au PLATED ON THE FUNCTIONAL AREA OF CONTACT. (GOLD G/F PLATING THICKNESS FOLLOW)
    - GOLD FLASH PLATING ON SOLDER AREA
  - FRONT SHELL:
    - Ni 30u" MIN. UNDER PLATED OVER ALL.
- MECHANICAL PERFORMANCE,
  - INSERTION FORCE: 0.5~2.0kgf.
  - REMOVAL FORCE: 0.8kgf~2.0kgf.
  - DURABILITY: 10000 CYCLES.
- ELECTRICAL PERFORMANCE,
  - CURRENT RATING: 5A  
VOLTAGE RATING: 20V
  - INSULATION RESISTANCE: 100MΩ MIN
  - DIELECTRIC WITHSTAND VOLTAGE, AC 100V FOR 1 MINUTE.
  - LOW CONTACT RESISTANCE: INITIAL 40MΩ  
AFTER 50MΩ
- ENVIRONMENTAL PERFORMANCE:
  - OPERATING TEMPERATURE: -30° C~+80° C.
  - IR REFLOW: THE PEAK TEMPERATURE ON THE BOARD SHALL BE MAINTAINED FOR 10 SECONDS AT 260° C.

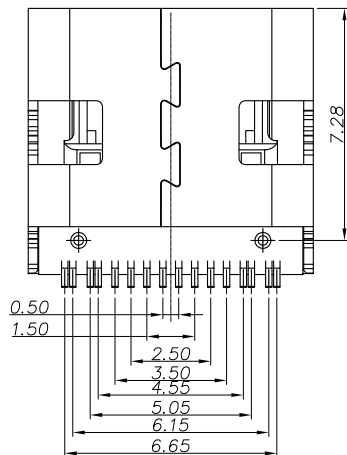
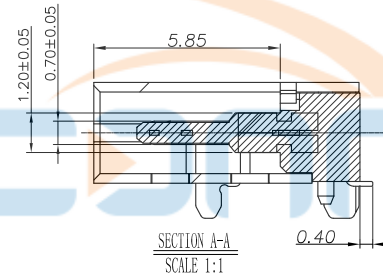
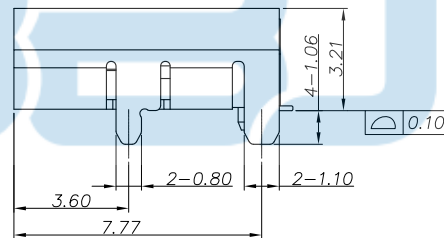
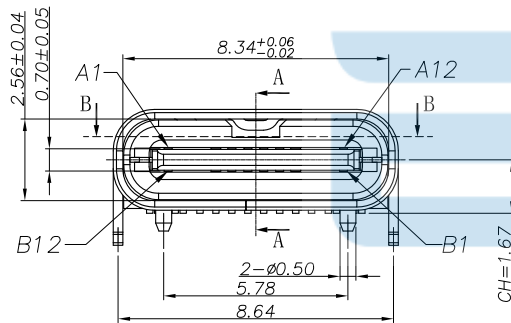

TOLERANCE UNSPECIFIED		深圳市步步精科技有限公司 TITLE: TYPE-C 16P 母座 L=8.35 CH=1.67 板上四脚插 带柱 端子SMT					
.0	±0.35	DRAWN/	设计	TSP	SIZE:A4	UNIT:MM.	PART.NO: UC.01.51-11-0050
.00	±0.25	DATE					
.000	±0.15	CHECKED/	审核	LYX	SCALE: 1:1	PROJECTION	REV.: 版本
X.°	±2.00°	DATE					
CUSTOMER DRAWING		APPROVED/	核准	LJP	DWG. PATH	0100-2	SHEET: 页码



REV.	DESCRIPTION	NAME	DATE
A	NEWS ISSUE		

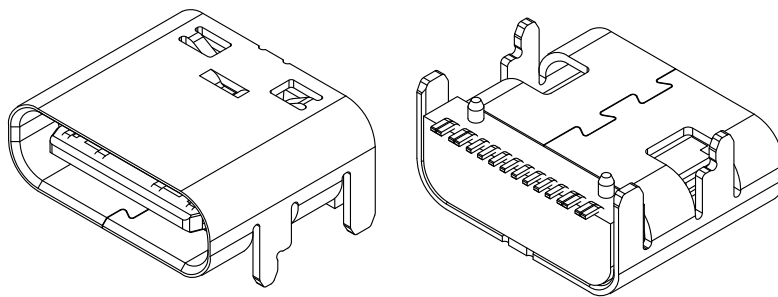

USB TYPE-C PIN ASSIGNMENTS

PIN NUMBER	SIGNAL NAME	PIN NUMBER	SIGNAL NAME
A1	GND	B12	GND
A4	VBUS	B9	VBUS
A5	CC1	B8	SBU2
A6	Dp1	B7	Dn2
A7	Dn1	B6	Dp2
A8	SBU1	B5	CC2
A9	VBUS	B4	VBUS
A12	GND	B1	GND

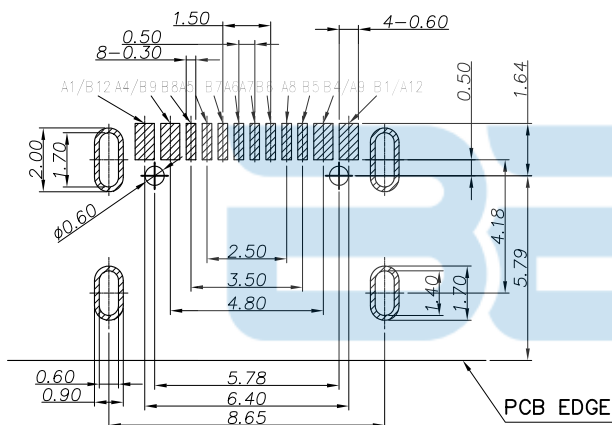

RECOMMEND P.C.B LAYOUT(COMPONENT SIDE)  
TOLERANCE FOR PCB LAYOUT IS  $\pm 0.05$



TOLERANCE UNSPECIFIED		深圳市步步精科技有限公司 TITLE: TYPE-C 16P 母座 L=8.35 CH=1.67 板上四脚插 带柱 端子SMT			
.0	$\pm 0.35$	SIZE:A4	UNIT:MM.	PART. NO: UC.01.51-11-0050	
.00	$\pm 0.25$	SCALE: 1:1		PROJECTION	REV.: 版本
.000	$\pm 0.15$	DWG. PATH		0100-2	SHEET: 页码
X. °	$\pm 2.00^\circ$	DRAWN/ DATE		DESIGN TSP	
CUSTOMER DRAWING		CHECKED/ DATE		REVIEW LYX	
		APPROVED/ DATE		APPROVAL LJP	



REV.	DESCRIPTION	NAME	DATE
A	NEWS ISSUE		

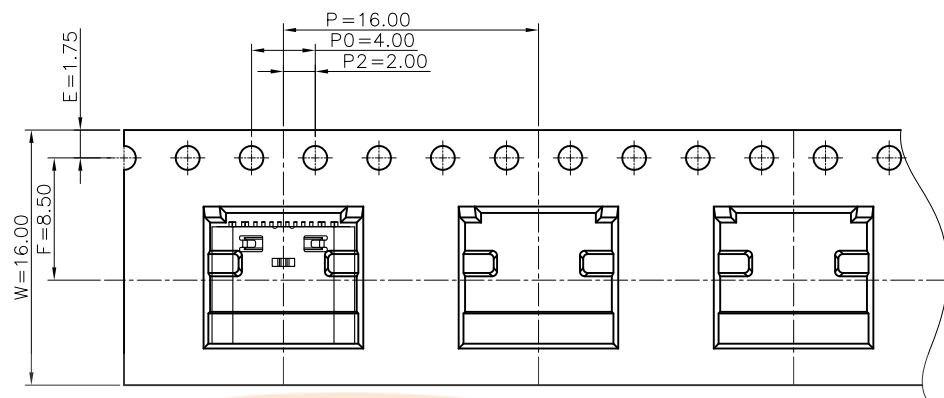
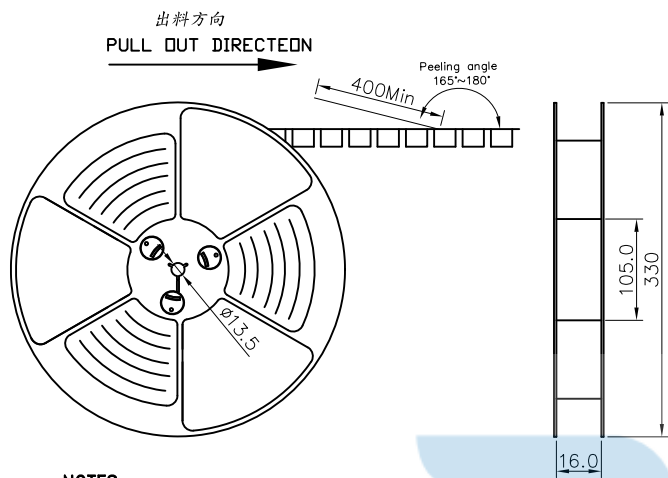

**NOTES**

- 帶子引導長度  
LEAD TAPE LENGTH  
出料方向  
PULL OUT DIRECTEON
- 上帶 剝力力為：0.1~1.3N(10.2gf~130gf)  
PEELING OFF FORCE OF TOP TAPE:0.1~1.3N(10.2gf~130gf)  
出貨運輸過程中一定注意：  
THIS REQUIREMENT SHOULD BE APPLIED AT SHIPMENT：  
卷帶在運輸過程中不能散開  
PEELING OFF SHOULD NOT BE ALLOWED DURING TRANSPORTATION

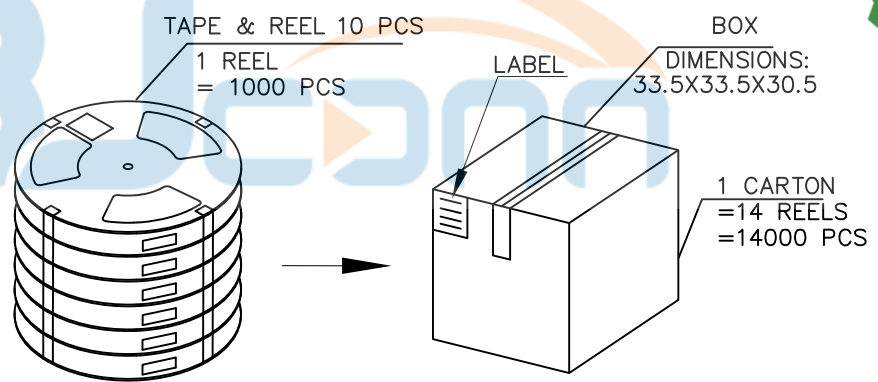

TOLERANCE UNSPECIFIED		.0 ±0.35		.00 ±0.25		.000 ±0.15		X. ° ±2.00°		CUSTOMER DRAWING	
DRAWN/ DATE		设计 TSP		SIZE:A4		UNIT:MM.		PART. NO: UC.01.51-11-0050		TITLE: TYPE-C 16P 母座 L=8.35 CH=1.67 板上四脚插 带柱 端子SMT	
CHECKED/ DATE		审核 LYX		SCALE: 1:1		PROJECTION		REV.: 版本		SHEET: 页码	
APPROVED/ DATE		核准 LJP		DWG. PATH		0100-2					

包装明细表 (The detail of the packing)					
包装容量 (Packing Capacity)			重量 Weight (Kg)		
pcs/box	boxes/Carton	Pcs/Box	N. W. /Pcs	N. W. /Box	G. W. /Box
1000	14	14000	---	---	---

A  
B  
C  
D  
E  
F

A  
B  
C  
D  
E  
F