



REV.	DESCRIPTION	NAME	DATE
A	NEWS ISSUE		

NOTES:

1. MATERIAL

CONTACTS: COPPER ALLOY (T=0.25mm)
 SHELL: COPPER ALLOY (T=0.40mm)
 HOUSING: PBT UL94V-0 Blue

2. ELECTRICAL PERFORMANCE,

CONTACT RESISTANCE: 30MΩ MAX
 CONTACT CURRENT RATING: 1.00 AMPERES
 DIELECTRIC WITHSTAND VOLTAGE, 100V R. M. S
 INSULATION RESISTANCE: 100MΩ MIN
 OPERATING TEMPERATURE: -40° C~+85° C.

3. MECHANICAL PERFORMANCE,

INSERTION FORCE: 3.57 kgf Max
 REMOVAL FORCE: 0.81 kgf Min
 DURABILITY: 5000 CYCLES.

4. PLATING SPECIFICATION:

CONTACTS: GOLD 30u'' PLATED ON CONTACT AREA,
 100-200u'' Sn ON SOLDER AREA,
 50-100u'' NICKEL UNDERPLATED.

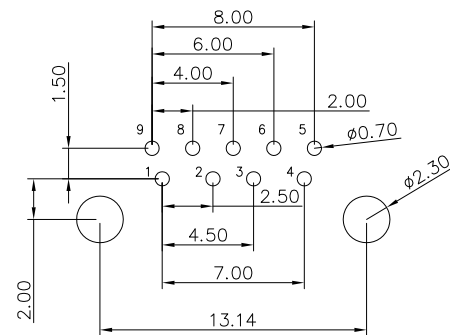
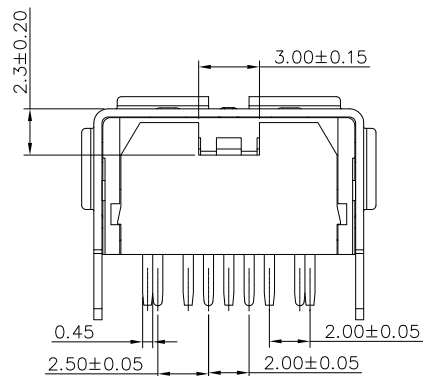
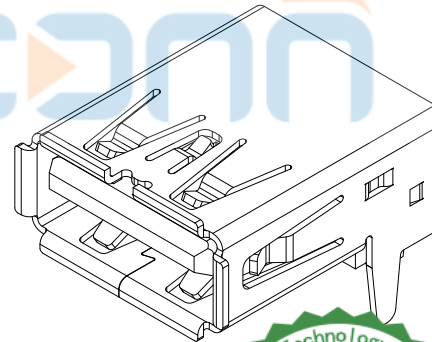
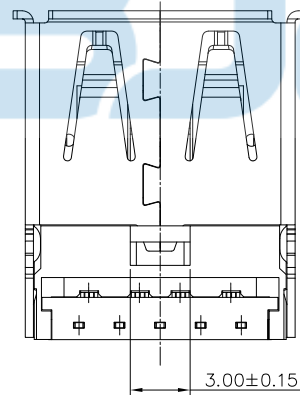
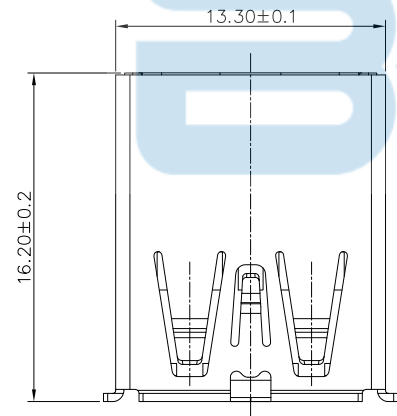
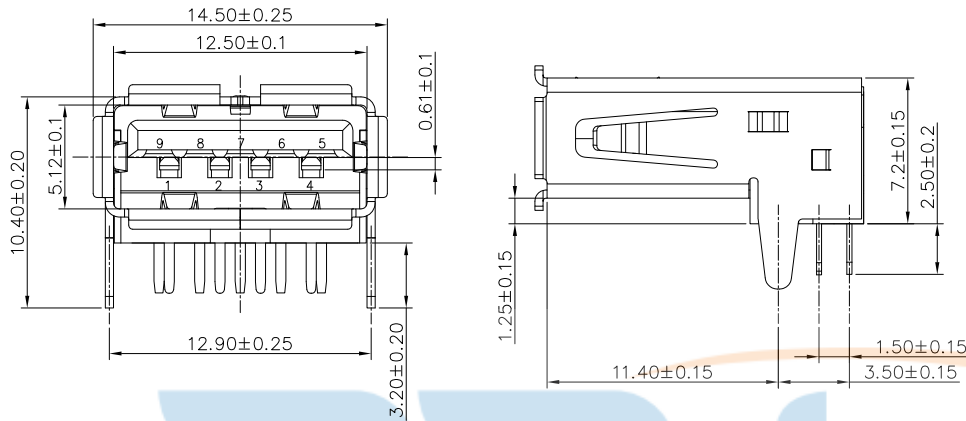

CONNECTOR FRONT EDGE
 PREFERENCE PCB LAYOUT



Pin Number	Signal Name
1	VBUS
2	D-
3	D+
4	GND
5	StdA_SSRX-
6	StdA_SSRX+
7	GND_DRAIN
8	StdA_SSTX-
9	StdA_SSTX+
Shell	Shield

TOLERANCE UNSPECIFIED	
.0	±0.35
.00	±0.25
.000	±0.15
X.°	±2.00°
CUSTOMER DRAWING	

深圳市步步精科技有限公司

TITLE: USB 3.0 母座 板上型 L=16.2 直脚 卷边 PBT
 蓝胶 铜壳 脚长3.20 镀金30u

DRAWN/ DATE	设计 LYX	SIZE:A4	UNIT:MM.	PART. NO: UB.03.11-32-1007	
CHECKED/ DATE	HMY	SCALE: 1:1	PROJECTION	REV.: 版本	
APPROVED/ DATE	LJP	DWG. PATH	0100-2	SHEET: 页码	



REV.	DESCRIPTION	NAME	DATE
A	NEWS ISSUE		

一.
將成品依同一方向放入真空盤內,如圖所示。
At same direction, put product onto the tray. Direction refers to below drawing.

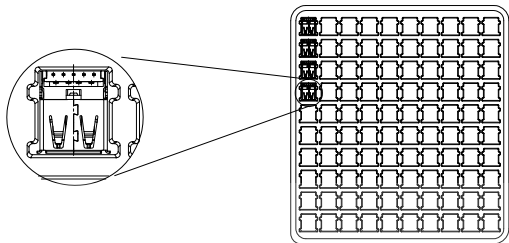

VIEW-1

- 二.
- 1) 一只紙箱可放置之包裝盤(包括上蓋)見下表。
1) trays per carton, please see next table.
 - 2) 每1個紙箱用的包裝數量詳見下表。
2) The Q'ty of products per carton please see next tabel.



VIEW-2

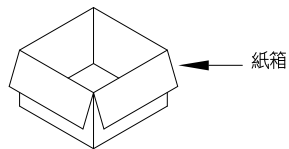
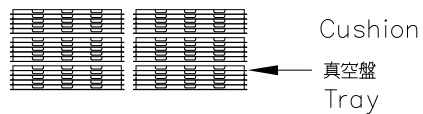

- 3) 將裝滿成品的真空盤用 PE帶捆緊後放在塑膠袋內,裝完後再封箱。
3) Bind the trays with PE tape and then, put them into the poly bag. Seal the carton with tape.
- 三.
- 1) 將標籤貼於紙箱側上方。
Stick the needful label On the up-right corner of the side of carton.

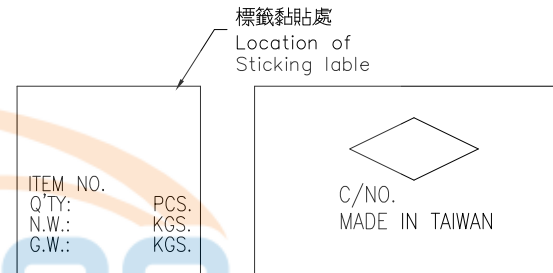

VIEW-3

備 註(REMARK)

1. 若有未裝滿之零數箱,必須以緩衝材塞滿。
The unfilling-carton must be filled with assuagement.
2. 裝滿成品后之外箱,最大堆積箱數:5箱
About the box fully filled with products, the MAX accumulating quantity of boxes is 5.
3. 如須貼Bar-code,請依Bar-code作業辦法執行
If barcode lable is required, do it according to the related barcode lable operation standards.

包裝明細表 (The detail of the packing)

包裝容量 (Packing Capacity)		重量 Weight (Kg)			
pcs/box	boxs/Carton	Pcs/Box	N.W./Pcs	N.W./Box	G.W./Box
100	30	3000			

TOLERANCE UNSPECIFIED		深圳市步步精科技有限公司 TITLE: USB 3.0 母座 板上型 L=16.2 直脚 卷边 PBT 蓝胶 铜壳 脚长3.20 镀金30u					
.0	±0.35						
.00	±0.25	DRAWN/ DATE		设计 LYX	SIZE:A4	UNIT:MM.	PART. NO: UB.03.11-32-1007
.000	±0.15	CHECKED/ DATE		HMY	SCALE: 1:1		PROJECTION
X.°	±2.00°	APPROVED/ DATE		LJP	DWG. PATH		0100-2
CUSTOMER DRAWING							REV.: 版本
							SHEET: 页码