

REV.	ECN NO	CONTENT	DATE	ENGINEER
A0		Initial release	/	SGF
B1		1. 弹片头部尺寸改短0.4mm, 角度改平调整10度, 优化组装后干涉问题 2. 档板增加凸点, 优化对插光纤后档板脱落问题。	2022-08-16	LYX

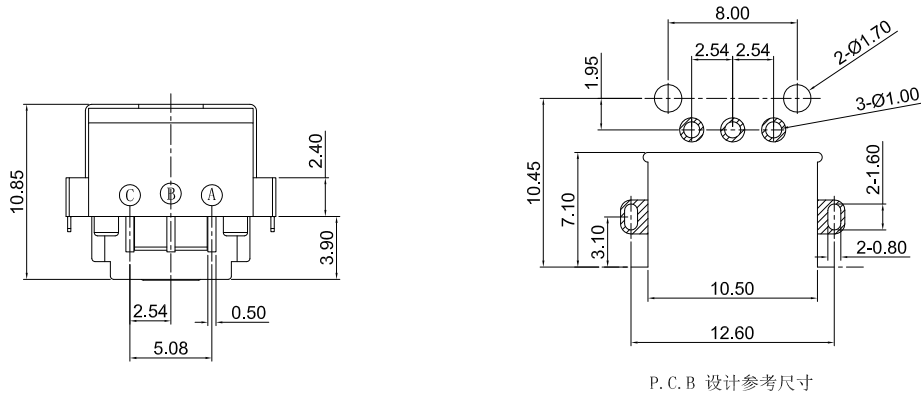

机外壳开口示意图

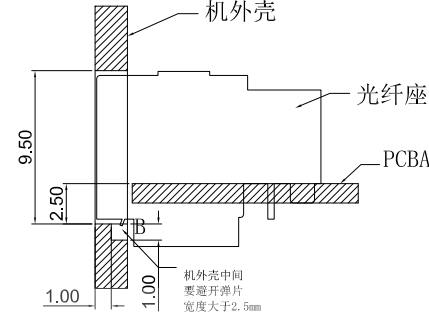

机械特性

1. 使用温度: $-20^{\circ}\text{C} \sim +70^{\circ}\text{C}$
2. 相对湿度: 85%
3. 插入力: $\leq 39.2\text{N}$
4. 拔出力: $\geq 3.9\text{N}$
5. 插拔寿命: 500次
6. 盐雾试验: 48小时

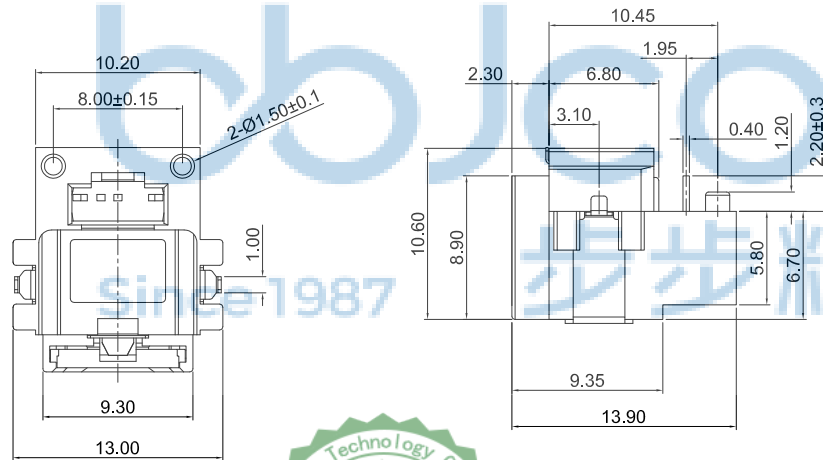

PIN FUNCTION

- Ⓐ Vin
- Ⓑ Vcc
- Ⓒ GND

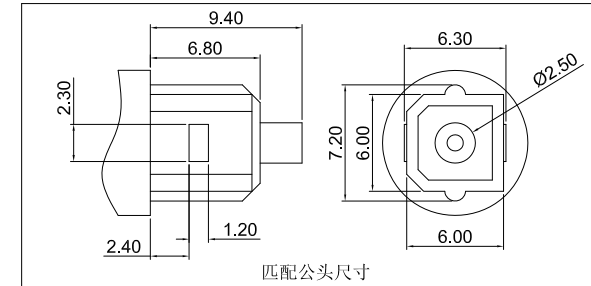

5	压片	C2680	1	镀铜锡
4	芯片	发射信号晶源 (25Mbps)	1	铜脚镀银
3	弹片	SUS301	1	本色
2	门板	PA9T UL94V-0	1	黑色
1	主体	PA9T UL94V-0	1	黑色
序号	名称	材料	数量	颜色/电镀



THIS DOCUMENT IS THE SOLE PROPERTY OF BBJconn Technology Co., Ltd. Corporation AND SHOULD NOT BE USED IN WHOLE OR IN PART WITHOUT PRIOR WRITTEN PERMISSION.

PDWG.NO: 0050-2

DR. SGF

APPD. JM_Zheng

CHKD. LYX

NAME: 深圳市步步精科技有限公司
光纤座-T030B

PJ. NO.: FS. 01. 01-02-1001

SIZE: A4 | DRW NO.:

FINISH: SEE NOTES | MAT'L.: SEE NOTES

SCALE: N/A | REV.: A0 | UNIT: mm | PAGE: 1/2

REV.	ECN NO	CONTENT	DATE	ENGINEER
A0		Initial release	/	SGF

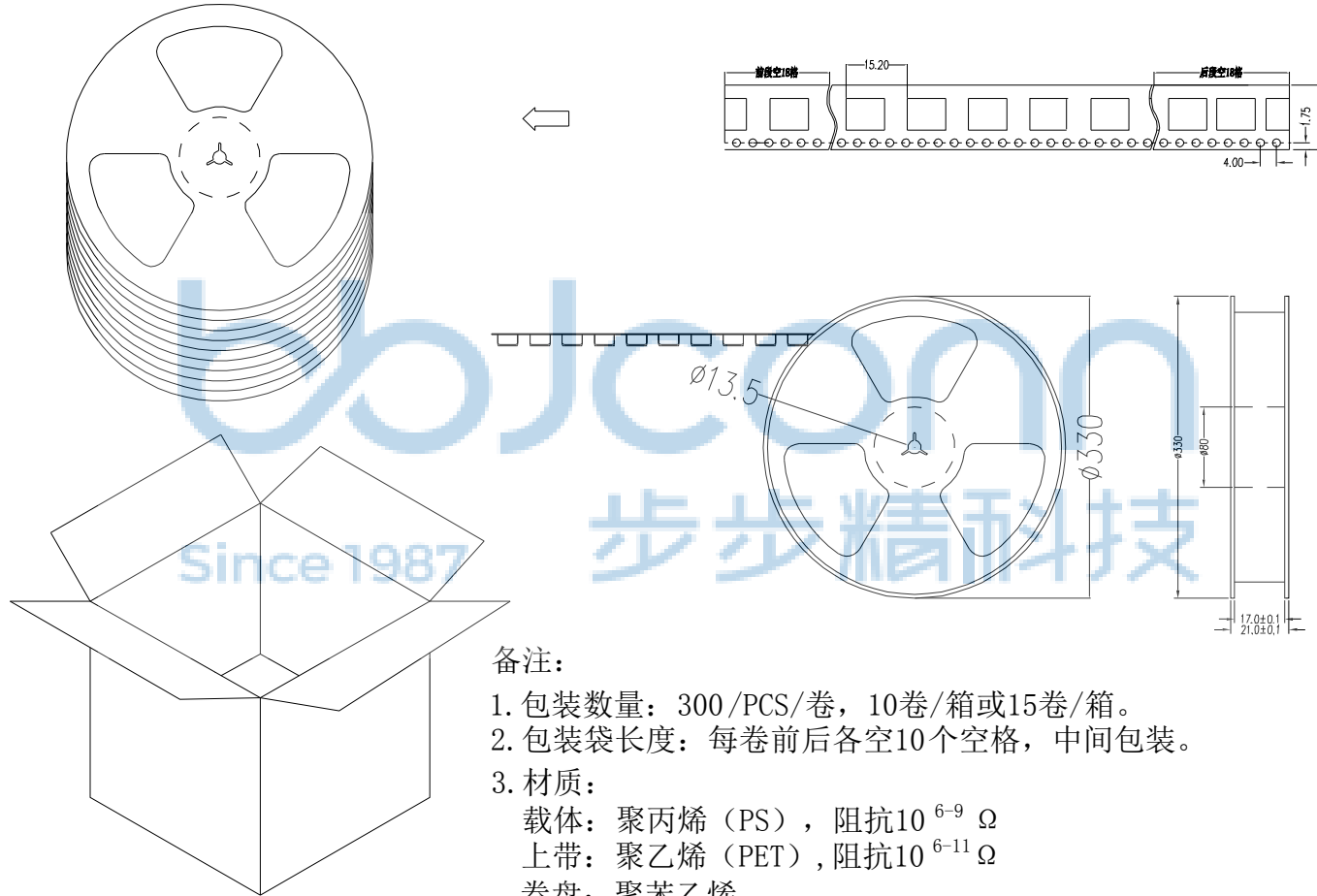

备注:

1. 包装数量: 300/PCS/卷, 10卷/箱或15卷/箱。
2. 包装袋长度: 每卷前后各空10个空格, 中间包装。
3. 材质:
载体: 聚丙烯 (PS), 阻抗 $10^{6-9} \Omega$
上带: 聚乙烯 (PET), 阻抗 $10^{6-11} \Omega$
卷盘: 聚苯乙烯。

纸箱规格: 345*345*23MM
纸箱规格: 345*345*35MM

THIS DOCUMENT IS THE SOLE PROPERTY OF BBJconn Technology Co.,Ltd. Corporation AND SHOULD NOT BE USED IN WHOLE OR IN PART WITHOUT PRIOR WRITTEN PERMISSION.		深圳市步步精科技有限公司 NAME: 光纤座-T030B	
.X: ±0.38 .X': ±3" .XX: ±0.25 .X'': ±2" .XXX: ±0.13 .XX': ±1"		APPD. JM_Zheng	PJ. NO.: FS.01.01-02-1001 SIZE: A4 DRW NO.:
PDWG.NO: 0050-2	DR. SGF	CHKD. LYX	FINISH: SEE NOTES MAT'L.: SEE NOTES SCALE: N/A REV.: A0 UNIT: mm PAGE: 2/2