

REV.	ECN NO.	CONTENT	DATE	ENGINEER
A0		Initial release	/	SGF

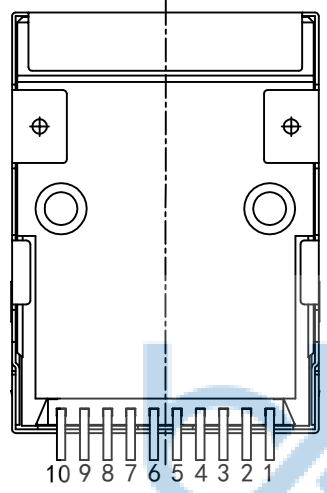

BOTTOM VIEW

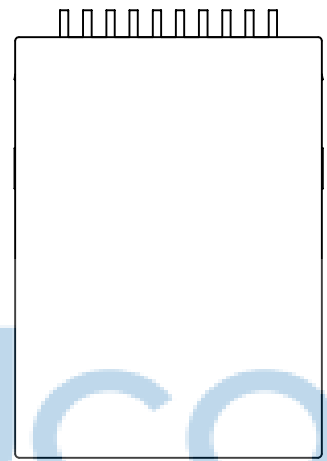

TOP VIEW

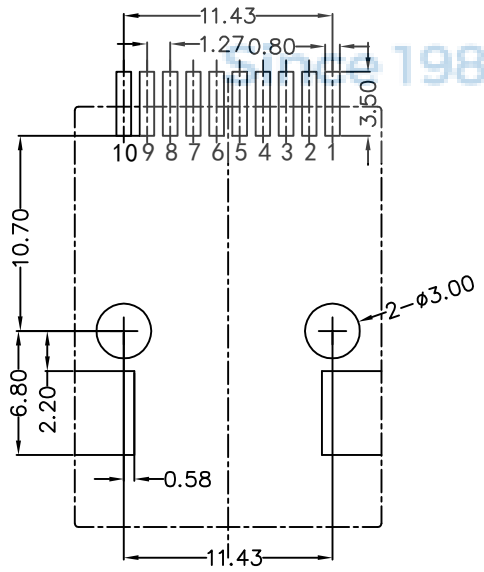

**RECOMMENDED PCB LAYOUT
VIEWED FROM COMPONENT SIDE**

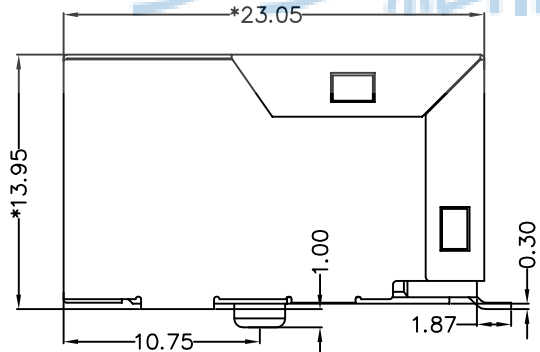

RIGHT SIDE VIEW

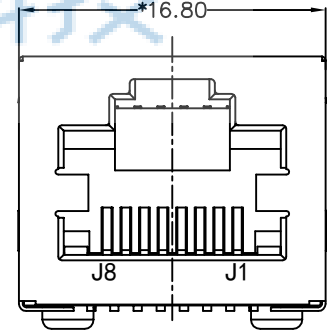

FRONT VIEW

MATERIAL:

HOUSING: LCP,UL94V-0,BLACK.
 TERMINALS BRACKET: LCP,UL94V-0,BLACK.
 SHIELD: C2680,T=0.20MM,NICKEL PLATING ON ALL AREA.
 TERMINAL: PHOSPHOR BRONZE C5210,T=0.35MM,
 6U" GOLD PLATING ON CONTACT AREA.

MECHANICAL:

DURABILITY: 750 CYCLES MIN.
 MATING FORCE: 30N MAX.
 OPERATING TEMPERATURE: -40°C~+85°C.
 STORAGE TEMPERATURE: -40°C~+85°C.
 ALL CRITICAL DIMENSIONS WITH "*"



THIS DOCUMENT IS THE SOLE PROPERTY OF BBJconn Technology Co.,Ltd. Corporation AND SHOULD NOT BE USED IN WHOLE OR IN PART WITHOUT PRIOR WRITTEN PERMISSION.		深圳市步步精科技有限公司	
.X: ±0.38 .XX: ±0.25 .XXX: ±0.13		X": ±3" X": ±2" X": ±1"	
APPD.	JM_Zheng	NAME: 网络接口 RJ45 90度 10P 10C L=23.05 H=13.95 端子SMT 千兆滤波 无灯无弹 带柱	
CHKD.	LYX	PJ. NO.: RJ.01.21-11-A002	
DR.	SGF	SIZE: A4 DRW NO.:	
PDWG.NO: 0521-1		FINISH: SEE NOTES MAT'L.: SEE NOTES	
		SCALE: N/A REV.: A0 UNIT: mm PAGE: 1/4	

REV.	ECN NO	CONTENT	DATE	ENGINEER
AO		Initial release	/	SGF

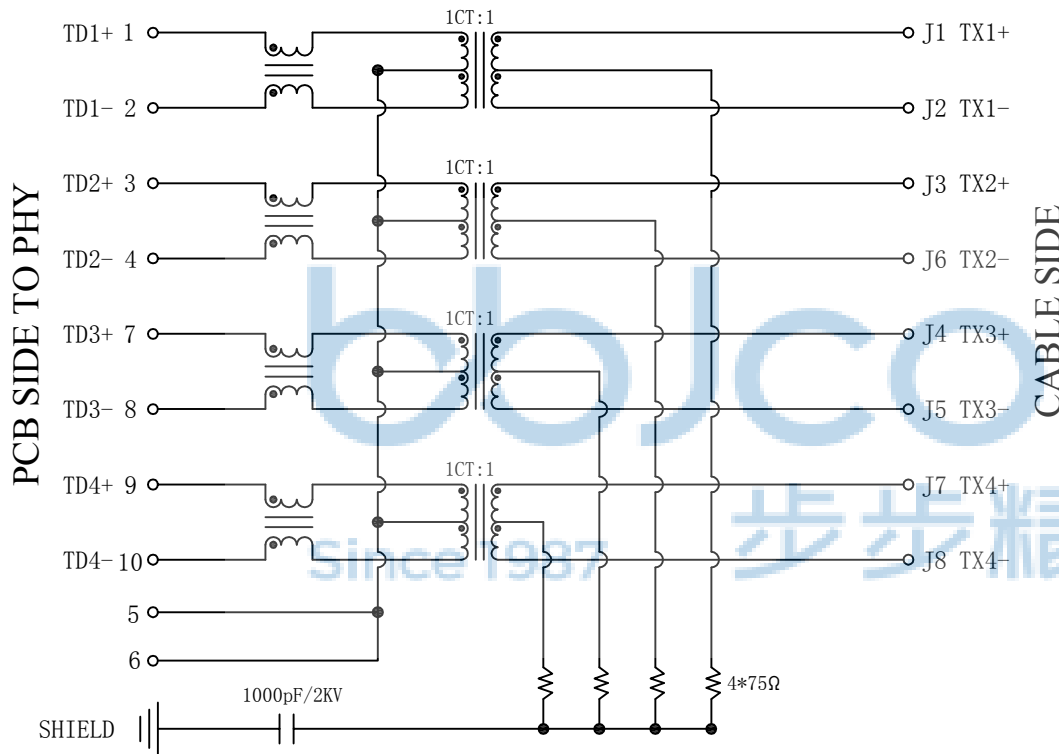

Electrical:

- Turn ratio 1~2: J1~J2=1CT:1CT(±2%).
3~4: J3~J6=1CT:1CT(±2%).
7~8: J4~J5=1CT:1CT(±2%).
9~10: J7~J8=1CT:1CT(±2%).
- OCL: 350uH Min. at 100KHz 100mV 8mA DC
- Insertion Loss: -1.0 dB Max 1~100MHz.
- Return loss: -20dB Min 1~10MHz;
-16dB Min 10~30MHz.
-12dB Min 30~60MHz.
-10dB Min 60~80MHz.
- Cross talk: -40dB Min 1~30MHz;
-35dB Min 30~60MHz;
-30dB Min 60~100MHz;
- CMR: -35dB Min 1~100MHz;
- Hi-Pot: 1500V AC & 2250V DC
6S 1mA PRI TO SEC



THIS DOCUMENT IS THE SOLE PROPERTY OF BBJconn Technology Co.,Ltd. Corporation AND SHOULD NOT BE USED IN WHOLE OR IN PART WITHOUT PRIOR WRITTEN PERMISSION.		深圳市步步精科技有限公司 .X: ±0.38 .X': ±3' .XX: ±0.25 .X': ±2' .XXX: ±0.13 .X': ±1'		NAME: 网络接口 RJ45 90度 10P 10C L=23.05 H=13.95 端子SMT 千兆滤波 无灯无弹 带柱	
APPD.	JM_Zheng	PJ. NO.: RJ.01.21-11-A002		SIZE: A4 DRW NO.:	
CHKD.	LYX	FINISH: SEE NOTES		MAT'L.: SEE NOTES	
PDWG.No:	0521-1	DR.	SGF	SCALE: N/A	REV.: A0 UNIT: mm PAGE: 2/4

PROFILE OF REFLOW SOLDERING

A. Temperature range of open
 B. Preheat temperature zone
 C. The welding zone
 D. The cooling zone
 Tip temperature: $265 \pm 5^{\circ}\text{C}$.
 Tip temperature time: $30 \pm 10\text{Sec}$.
 Tip melting point of Sn96.5/Ag3/Cu0.5.

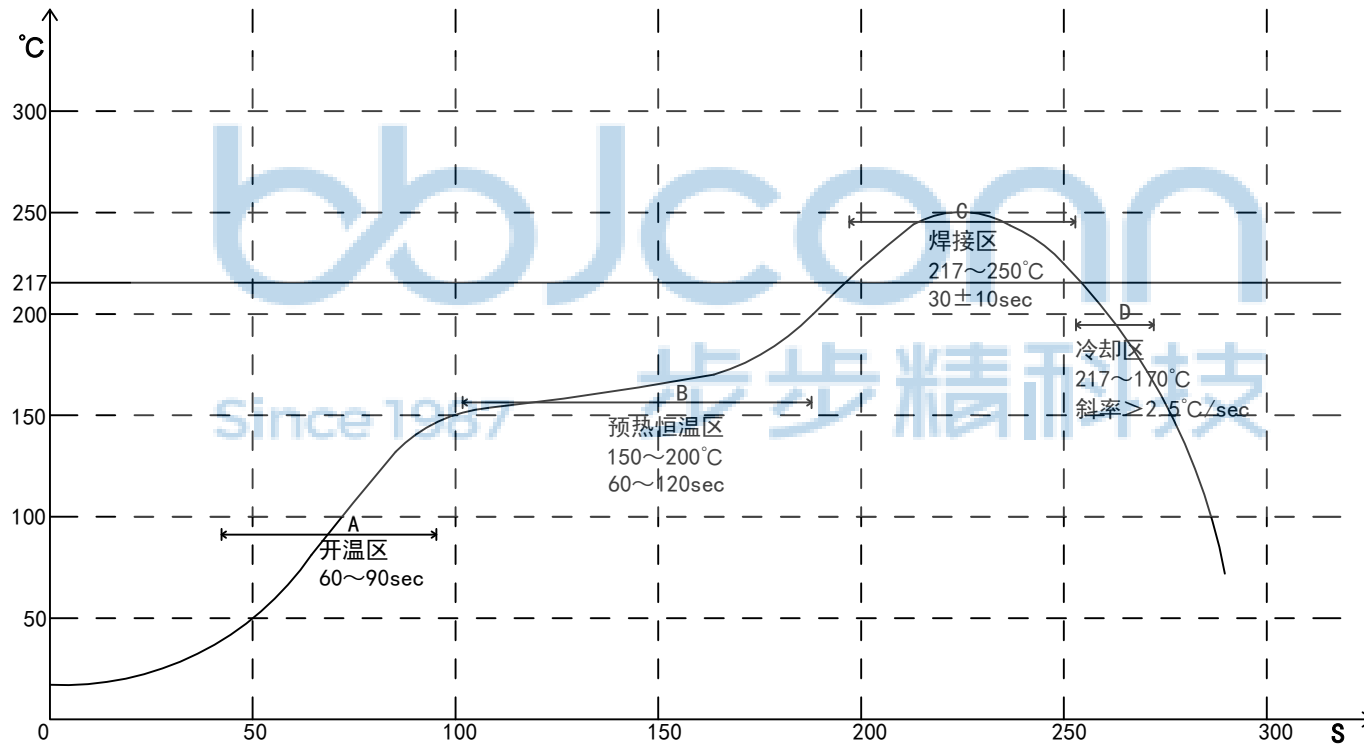

THIS DOCUMENT IS THE SOLE PROPERTY OF BBJconn Technology Co., Ltd. Corporation AND SHOULD NOT BE USED IN WHOLE OR IN PART WITHOUT PRIOR WRITTEN PERMISSION.		深圳市步步精科技有限公司 .X: ±0.38 .X': ±3" .XX: ±0.25 .X": ±2" .XXX: ±0.13 .XX': ±1"	
APPD.	JM_Zheng	NAME: 网络接口 RJ45 90度 10P 10C L=23.05 H=13.95 端子SMT 千兆滤波 无灯无弹 带柱	
CHKD.	LYX	PJ. NO.: RJ.01.21-11-A002	
PDWG.NO:	0521-1	SIZE: A4 DRW NO.:	
DR.	SGF	FINISH: SEE NOTES MAT'L.: SEE NOTES	
		SCALE: N/A REV.: A0 UNIT: mm PAGE: 3/4	

REV.	ECN NO	CONTENT	DATE	ENGINEER
A0		Initial release	/	SGF

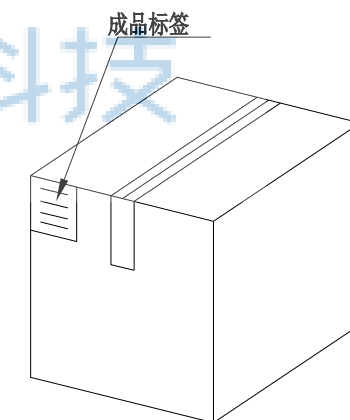
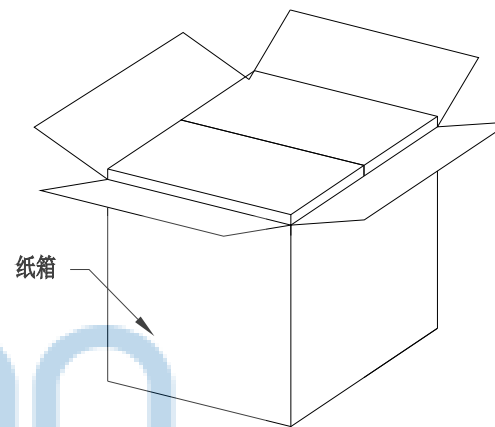
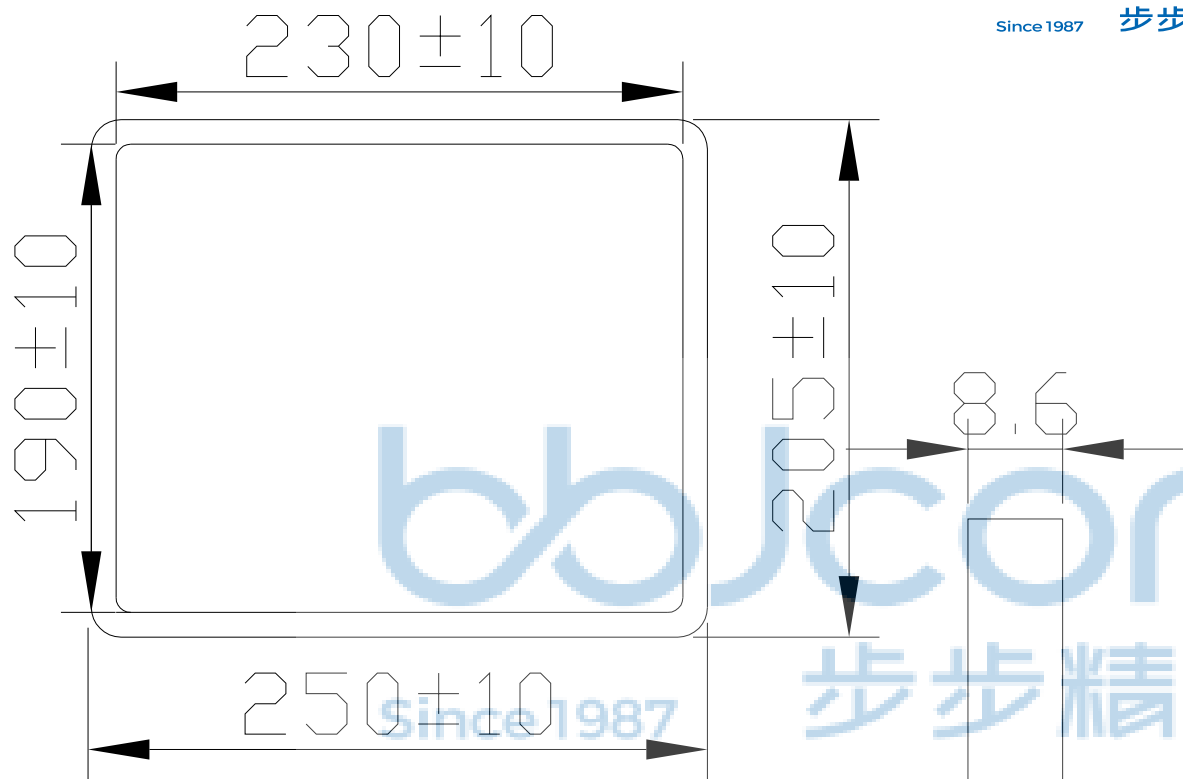

纸箱规格: 350*210*290

1. 包装要求:

- 1.1 每盒吸塑盒包装 50 pcs;
- 1.2 每24盘放一箱, 共计1200PCS;
- 1.3 纸箱外贴上标签

THIS DOCUMENT IS THE SOLE PROPERTY OF BBJconn Technology Co.,Ltd. Corporation AND SHOULD NOT BE USED IN WHOLE OR IN PART WITHOUT PRIOR WRITTEN PERMISSION.		深圳市步步精科技有限公司 .X: ±0.38 .XX: ±0.25 .XXX: ±0.13 X': ±3" .X": ±2" .XX': ±1"		NAME: 网络接口 RJ45 90度 10P 10C L=23.05 H=13.95 端子SMT 千兆滤波 无灯无弹 带柱 PJ. NO.: RJ.01.21-11-A002 SIZE: A4 DRW NO.: FINISH: SEE NOTES MAT'L.: SEE NOTES SCALE: N/A REV.: A0 UNIT: mm PAGE: 4/4	
APPD.	JM_Zheng			MAT'L.: SEE NOTES	
CHKD.	LYX	DR. SGF		UNIT: mm PAGE: 4/4	
PDWG.NO:	0521-1	DR. SGF		UNIT: mm PAGE: 4/4	