

REV.	ECN NO	CONTENT	DATE	ENGINEER
A0		Initial release	/	LYL

SPECIFICATION:

- ELECTRICAL CHARACTERISTICS:
  - CURRENT RATING: 5A
  - TEMPERATURE RANGE: -40 °C ~ 85 °C
  - CONTACT RESISTANCE: 30 MILLIONHM MAX.
  - DIELECTRIC WITHSTANDING VOLTAGE: 100 VAC r.m.s
  - INSULATION RESISTANCE: 100 MEGOHMS MIN.
- MECHANICAL CHARACTERISTICS
  - INSERTION FORCE: 5~20N
  - EXTRACTION FORCE: Initial:8~20N,ATER TEST 6~20N
  - DURABILITY:10,000CYCLES
- THE SHELL LENTH IS LESS THAN THE MINIMUM SPECIFIED BY THE USB TYPE C STANDARD,AS SUCH IS CANNOT INDENOENTDENTLY BE GUARANTEED TO MEET ALL TYPE C MECHANICAL REQUIREMENTS.

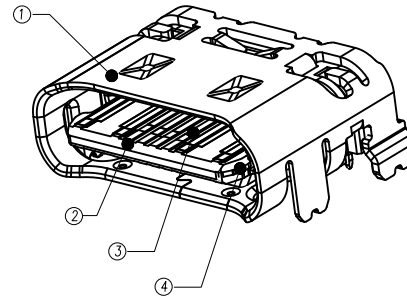
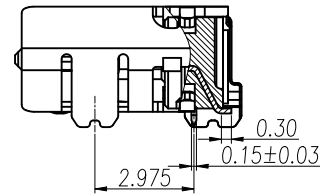
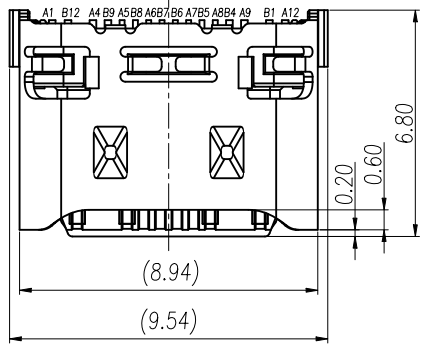

SECTION A-A

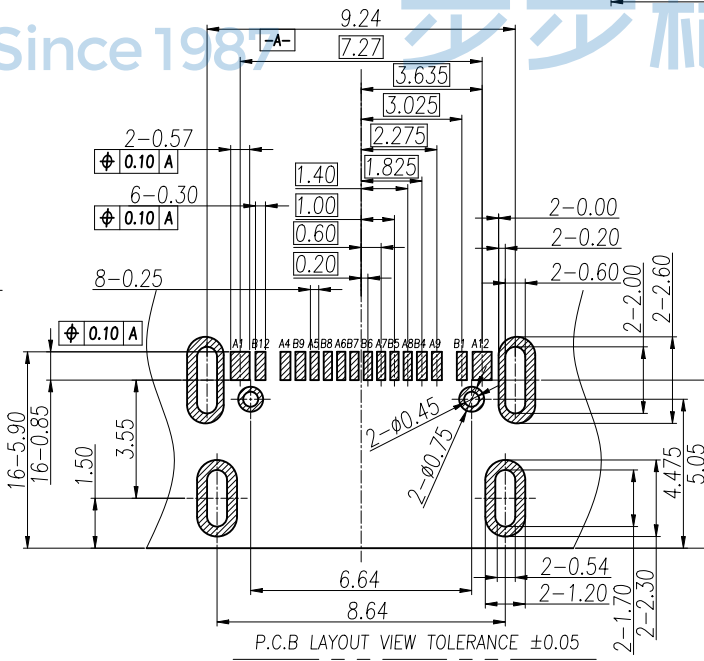
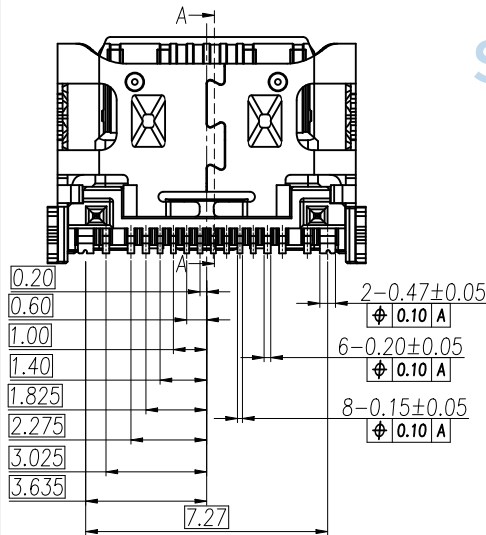
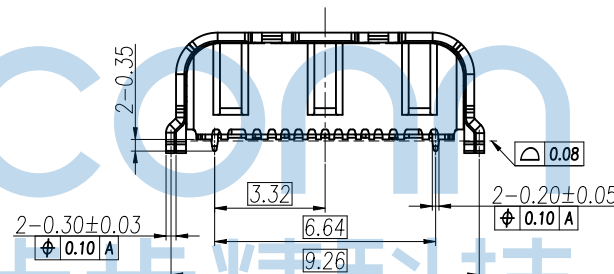
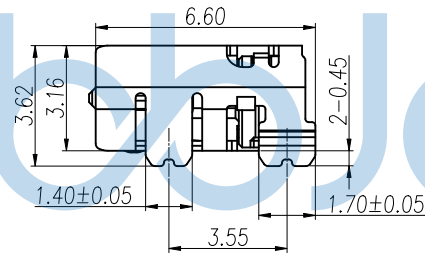
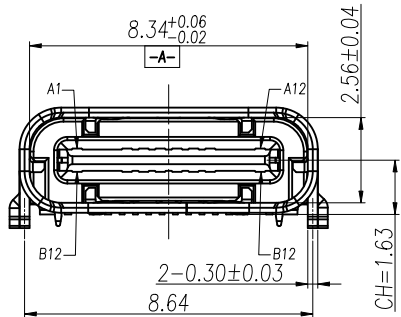

P.C.B LAYOUT VIEW TOLERANCE ±0.05

PIN ASSIGNMENT												BLADE	SHELL
A1	A2	A3	A4	A5	A6	A7	A8	A9	A10	A11	A12		
GND	TX1+	TX1-	VBUS	CC1	D+	D-	SBU1	VBUS	RX2-	RX2+	GND		
GND	RX1+	RX1-	VBUS	SBU2	D-	D+	CC2	VBUS	TX2-	TX2+	GND	GND	GND
B12	B11	B10	B9	B8	B7	B6	B5	B4	B3	B2	B1		

NO.	DESCRIPTION	QTY.	MATERIAL	FINISHED
5	MID PLATE	1 PCS	SUS301 T=0.15	None
4	CONTACT 2	1 SET	C7025 T=0.15	Ni 50~100u" Plated; After Au 1u" Plated On Contact Area And Solder Area
3	CONTACT 1	1 SET	C7025 T=0.15	
2	IM HOUSING	1 PCS	PA46 BLACK UL94V-0	None
1	SHELL	1 PCS	SUS304 T=0.30	Ni 50~120u" Plated

THIS DOCUMENT IS THE SOLE PROPERTY OF BBJconn Technology Co.,Ltd. Corporation AND SHOULD NOT BE USED IN WHOLE OR IN PART WITHOUT PRIOR WRITTEN PERMISSION.

PDWG.NO: 0851-1

APPD. JM\_Zheng

CHKD. LYX

DR. LYL

NAME: TYPE-C 16P 母座 板上四脚插 端子SMT 舌片外漏0.20 L=6.60 CH=1.63 绑带

PJ. NO.: 126-221-160009-M3G

SIZE: A4 DRW NO.:

FINISH: SEE NOTES MAT'L.: SEE NOTES

SCALE: N/A REV.: A0 UNIT: mm PAGE: 1/2

REV.	ECN NO	CONTENT	DATE	ENGINEER
AO		Initial release	/	LYL

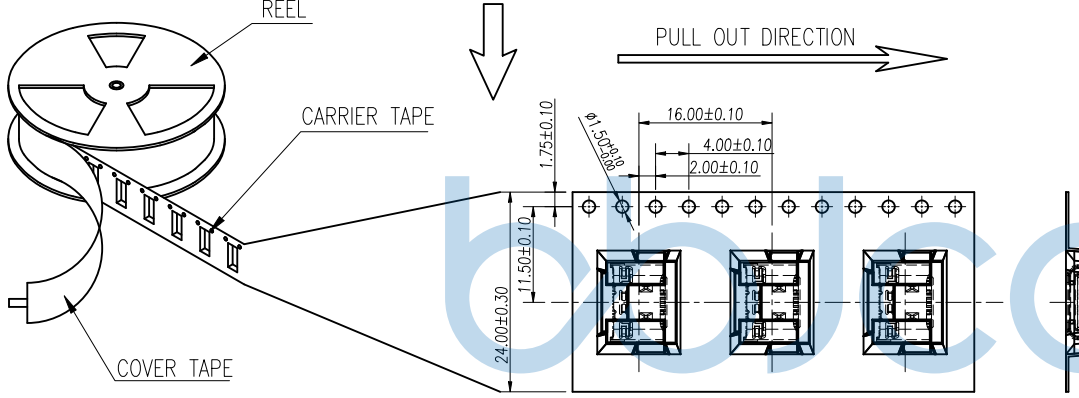
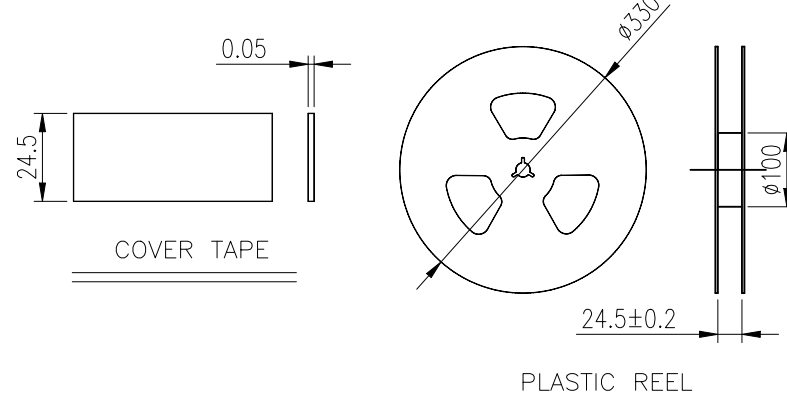
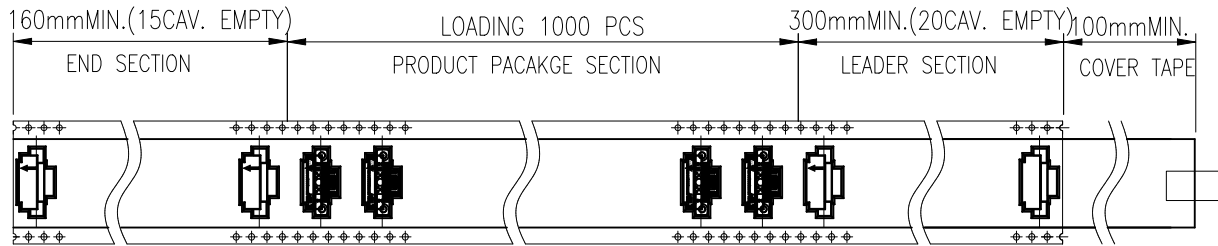

- NOTES 2:
- MATERIAL:
    - REEL AND AXLE: PS,BLUE
    - CARRIER TAPE: PET, LUCID
    - COVER TAPE: PS,TRANSPARENT
    - SHIPPING CARTON: CORRUGATED FIBER
  - DIMENSION:
    - REEL: W=24.5, øA=330
    - CARRIER TAPE: T=0.50 W=24.0
    - COVER TAPE: T=0.05 W=25.5
    - SHIPPING CARTON: L=335mm, W=335mm, H=425mm
  - QUANTITY :
    - PRIMAY PACKING: 1000 PCS/REEL
    - SECONARY PACKING: 12 REELS/CARTON(12000PCS/CARTON)
  - PEELING RESISTANCE: 0.1~1.3N
    - PEELING SPEED: 300mm/minutes
    - PEELING ANGLE: 165° ~180°

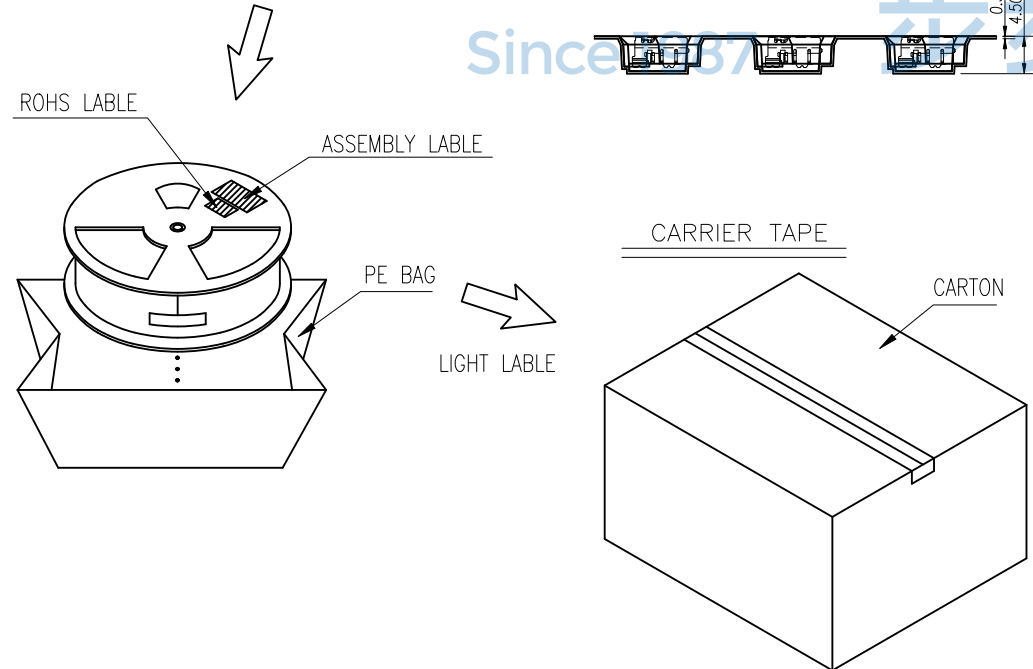

THIS DOCUMENT IS THE SOLE PROPERTY OF BBJconn Technology Co.,Ltd. Corporation AND SHOULD NOT BE USED IN WHOLE OR IN PART WITHOUT PRIOR WRITTEN PERMISSION.		<b>深圳市步步精科技有限公司</b>	
PDWG.NO: 0851-1		NAME: TYPE-C 16P 母座 板上四脚插 端子SMT 舌片外漏0.20 L=6.60 CH=1.63 编带	
APPD. JM_Zheng	PJ. NO.: 126-221-160009-M3G	SIZE: A4 DRW NO.:	
CHKD. LYX	FINISH: SEE NOTES		MAT'L.: SEE NOTES
DR. LYL	SCALE: N/A	REV.: AO	UNIT: mm PAGE: 2/2