

REV	ECN NO	CONTENT	DATE	ENGINEER
AO		INITIAL RELEASE	/	LYX

备注 (NOTES):

- 材料:  
主体: LCP, UL94V-0, 颜色: 黑色,  
PIN针: C5191,  
钢壳: 不锈钢SUS304,  
卡勾: 不锈钢SUS301,
- 电镀:  
PIN针: 镍底50u"Min, 镀金区域镀金1u",  
焊杯: 镍底50u"Min, 镀锡80u"Min,  
钢壳: 整体镀镍30u"最小,  
盐雾测试: 5%的盐水, 35° C,  
盐雾48H表面无氧化等不良,
- 机械性能:  
插入力: 初期: ≤20N, 寿命后: 6-20N ,  
拔出力: 初期: ≤20N, 寿命后: 6-20N,  
"插入力, 拔出力" 仅限指定的母座,  
插拔寿命: 1万次,
- 电气性能:  
额定电压: 5V DC (RMS),  
额定电流: 3A Max,  
工作环境: "-25° C"到"+80° C",  
接触阻抗: 50m ohms Max,  
绝缘阻抗: 300V DC,  
耐压测试: 300V AC minute,
- 电气规格:  
P. C. Board 厚度: 0.8±0.05mm,
- 本产品符合 "RoHS. 2.0" 标准, 哑镍,  
且以封样为准,

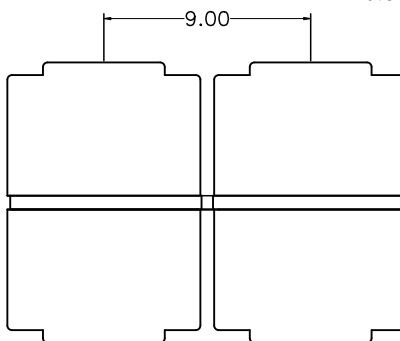
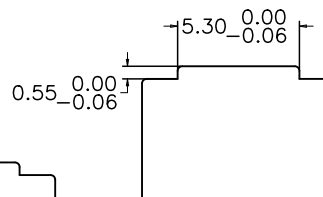
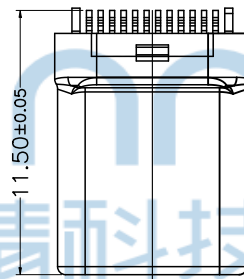
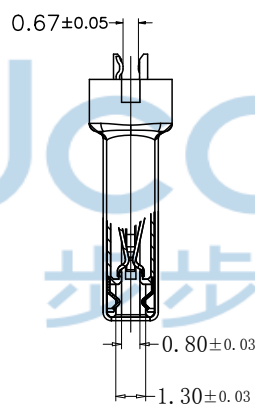
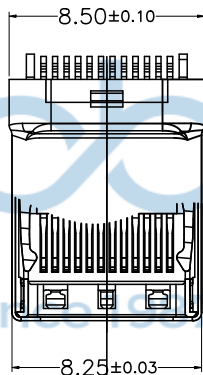
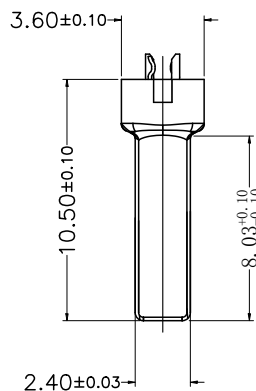
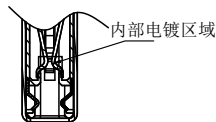

PIN DEFINITION  
FRONT VIEW

A1	A2	A3	A4	A5	A6	A7	A8	A9	A10	A11	A12
GND	TX1+	TX1-	VBUS	CC1	D+	D-	SBU1	VBUS	RX2-	RX2+	GND
GND	RX1+	RX1-	VBUS	SBU2	D-	D+	CC2	VBUS	TX2-	TX2+	GND
B12	B11	B10	B9	B8	B7	B6	B5	B4	B3	B2	B1

THIS DOCUMENT IS THE  
SOLE PROPERTY OF  
BBJconn Technology Co.,Ltd.  
Corporation AND SHOULD  
NOT BE USED IN WHOLE  
PRIOR WRITTEN PERMISSION.  
PDWG NO: 0931-1

**深圳市步步精科技有限公司**

NAME: TYPE-C 24P MD拉伸壳 带弹片 L=10.5 夹板  
0.8 3.6厚 带弹片不带板

PJ NO: 126-22A-240003-J8G

SIZE:A4 DRW NO:

FINISH:SEE NOTES MAT'L:SEE NOTES

SCALE:N/A REV:A0 UNIT:mm PAGE:1/2

APPD JM\_Zheng

CHKD Tang

DR LYX