

A1	GND	B12	GND
A2		B11	
A3		B10	
A4	VBUS	B9	VBUS
A5	CC1	B8	SBU2
A6	D+	B7	D-
A7	D-	B6	D+
A8	SBU1	B5	CC2
A9	VBUS	B4	VBUS
A10		B3	
A11		B2	
A12	GND	B1	GND



REV.	DESCRIPTION	NAME	DATE
A	NEWS ISSUE		

NOTES:
 1. MECHANICAL: MATING FORCE: 5-20N .
 UNMATING FORCE: 8-20N .
 DURABILITY: 10000 CYCLES MIN.
 2. ELECTRICAL:
 CURRENT: 5.0A MAX
 VOLTAGE: 20V MAX
 WITHSTANDING VOLTAGE: 100V AC
 CONTACT RESISTANCE: 40 mΩ MAX INITIAL;
 50 mΩ MAX AFTER 10000 CYCLES
 3. ENVIRONMENTAL:
 OPERATING TEMPERATURE RANGE -30° C ~ +80° C
 4. Salt Spray: 24H



BOM			
序号	名称	用量	品名规格
1	外壳	1	Typec 16PIN 沉板 1.2 外壳 SUS304 T=0.30mm
2	Molding 3	1	Typec 16PIN 沉板 1.2 Molding C7025 T=0.15 PA9T黑色 半成品
2.1	Molding 1	1	Typec 16PIN 沉板 1.2 Molding A C7025 PA9T黑色
2.2	Molding 2	1	Typec 16PIN 沉板 1.2 Molding B C7025 PA9T黑色
2.3	卡勾	1	Typec 16PIN 沉板 卡勾 SUS301 T=0.15mm

TOLERANCE UNSPECIFIED		深圳市步步精科技有限公司	
.0	±0.25	TITLE:	
.00	±0.20	TYPE-C 16P 母座 L=6.50 CH=0.35 沉板1.23 四脚插 端子SMT	
.000	±0.15	DRAWN/ DATE	设计 TSP
X.°	±2.00°	CHECKED/ DATE	审核 LYX
CUSTOMER DRAWING		APPROVED/ DATE	核准 LJP
SIZE:A4	UNIT:MM.	PART. NO:	126-221-160002-L7G
SCALE: 1:1	PROJECTION	REV.:	版本
DWG. PATH			0454-1
		SHEET:	页码



REV.	DESCRIPTION	NAME	DATE
A	NEWS ISSUE		

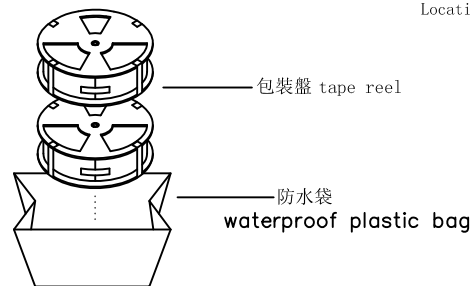
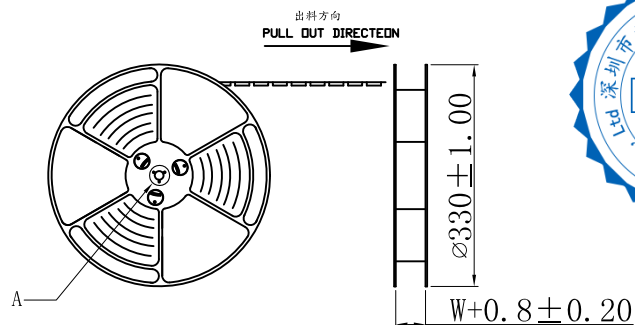

at small positioning hole of the carrier tape side.
 標籤黏貼處 (朝捲裝包材的小定位孔一側)
 Location of label sticking (label)

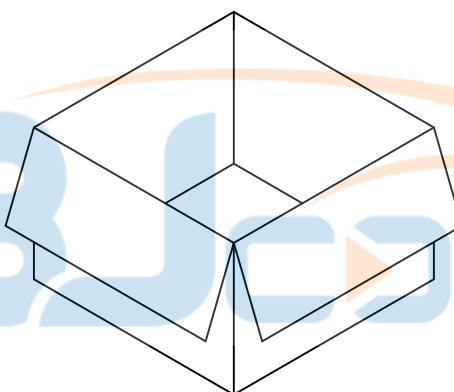
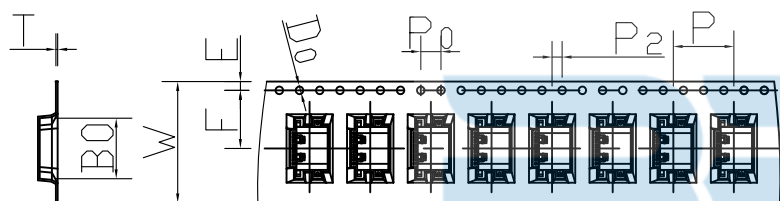
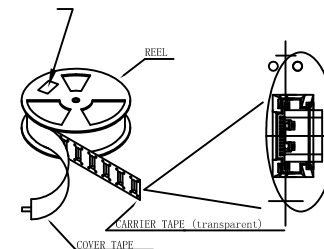

NOTE:

- 每捲包裝數量及每箱裝箱數量如左下表格。
Packing q'ty of each reel & carton as below table shown.
- 將裝滿產品的卷盤放入紙箱并以膠帶封口。
Put reels in the carton and use adhesive tape to seal up.

NOTES

1. 帶子引導長度
LEAD TAPE LENGTH
出料方向
PULL OUT DIRECTION



2. 上帶 剝力力為: 0.1~1.3N (10.2gf~130gf)
 PEELING OFF FORCE OF TOP TAPE: 0.1~1.3N (10.2gf~130gf)
 出貨運輸過程中一定注意:
 THIS REQUIREMENT SHOULD BE APPLIED AT SHIPMENT:
 卷帶在運輸過程中不能散開
 PEELING OFF SHOULD NOT BE ALLOWED DURING TRANSPORTATION

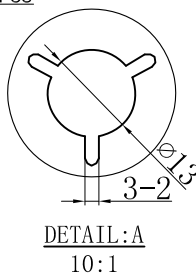
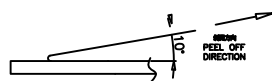

紙箱: 340mmX340mmX325mm



W	24.00±0.3
A0	7.6±0.1
B0	12.0±0.1
K0	3.55±0.1
P	12.00±0.1
F	11.50±0.1
E	1.75±0.1
D0	1.50±0.1
P0	4.00±0.1
P2	2.00±0.1
T	0.35±0.1

卷帶	規格: $\phi 330\text{mm}$	包裝數量: 10000PCS
紙箱	規格: 340mmX340mmX325mm	包裝數量: 10盤 (10000PCS)

TOLERANCE UNSPECIFIED		.0 ±0.25		.00 ±0.20		.000 ±0.15		X. ° ±2.00°		CUSTOMER DRAWING	
深圳市步步精科技有限公司 TITLE: TYPE-C 16P 母座 L=6.50 CH=0.35 沉板1.23 四脚插 端子SMT											
DRAWN/ DATE	设计	TSP	SIZE:A4	UNIT:MM.	PART. NO: 126-221-160002-L7G						
CHECKED/ DATE	审核	LYX	SCALE: 1:1		PROJECTION			REV.: 版本			
APPROVED/ DATE	核准	LJP	DWG.	PATH	0454-1			SHEET: 页码			