

REV.	ECN NO	CONTENT	DATE	ENGINEER
A0				

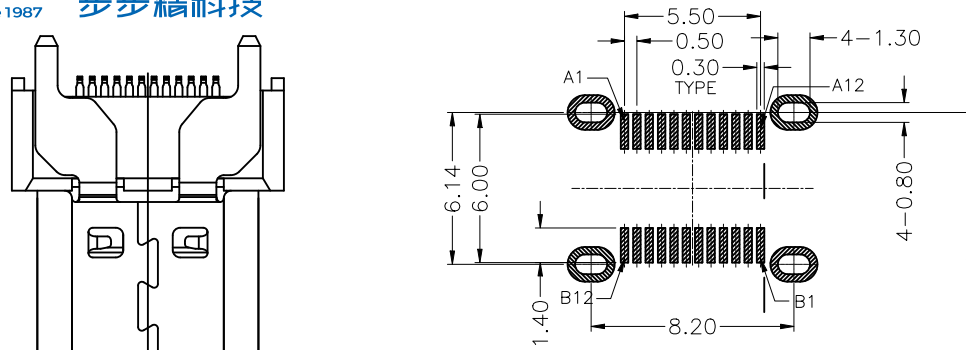

**RECOMMEND P.C.B LAYOUT(COMPONENT SIDE)**  
TOLERANCE FOR PCB LAYOUT IS ± 0.05  
KEEP OUT AREA

- Contact Resistance: 40mOHM Max. ;
- Dielectric Withstanding Voltage: 100V AC For 1 Minute;
- Insulation Resistance: 100M OHM Min. ;
- Mating And unmating Force:  
Mating Force: 5~20N  
Unmating Force: 8~20N;  
6~20N AFTER TEST;
- Durability: 10000 Cycles;

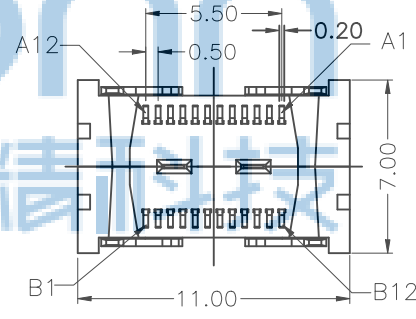
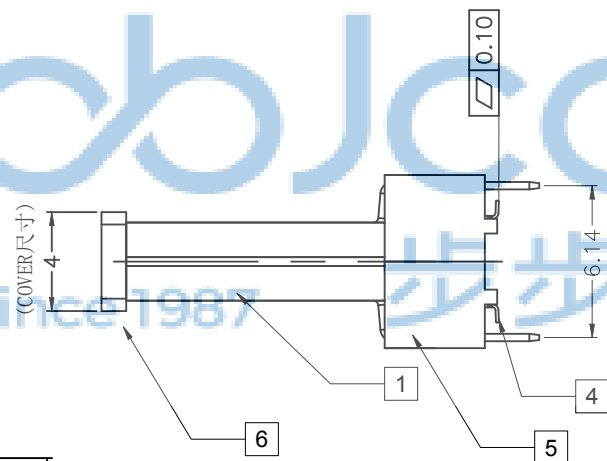
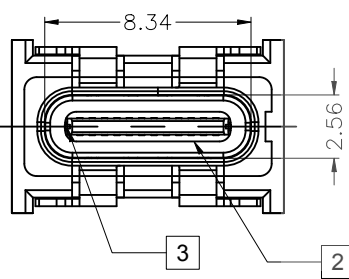
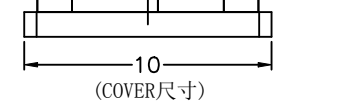

PIN	Signal Name	Description	PIN	Signal Name	Description
A1	GND	Ground return	B12	GND	Ground return
A2	SSTxp1	Positive half of first SuperSpeed TX differential pair	B11	SSRXp1	Positive half of first SuperSpeed RX differential pair
A3	SSTxn1	Negative half of first SuperSpeed TX differential pair	B10	SSRXn1	Negative half of first SuperSpeed RX differential pair
A4	Vbus	Bus Power	B9	Vbus	Bus Power
A5	CC1	Configuration Channel	B8	SBU2	Sideband Use (SBU)
A6	Dp1	Positive half of the USB 2.0 differential pair-Position 2	B7	Dn2	Negative half of the USB 2.0 differential pair-Position 2
A7	Dn1	Negative half of the USB 2.0 differential pair-Position 1	B6	Dp2	Positive half of the USB 2.0 differential pair-Position 1
A8	SBU1	Sideband Use (SBU)	B5	CC2	Configuration Channel
A9	Vbus	Bus Power	B4	Vbus	Bus Power
A10	SSRXn2	Negative half of second SuperSpeed RX differential pair	B3	SSTxn2	Negative half of second SuperSpeed TX differential pair
A11	SSRXp2	Positive half of second SuperSpeed RX differential pair	B2	SSTxp2	Positive half of second SuperSpeed TX differential pair
A12	GND	Ground return	B1	GND	Ground return

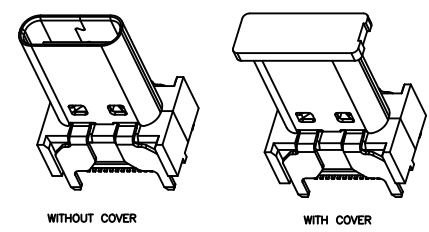
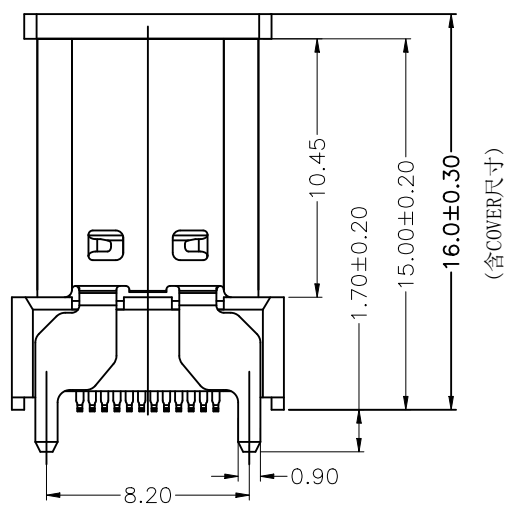

Item	Title	Material	Dispose	Q'TY
1	Shell	SUS304	Ni:30u" Min.	1PCS
2	GND Plate	SUS301		2PCS
3	Mid Plate	SUS301		1PCS
4	Contact	C7025	Mating Area: AU 1u" Solder Tails: Matt Tin	2PCS
5	InsertMolding	LCP E6808	UL 94V-0 Black	1PCS
6	COVER	LCP E6808	UL 94V-0 Black	1PCS

THIS DOCUMENT IS THE SOLE PROPERTY OF BBJconn Technology Co.,Ltd. Corporation AND SHOULD NOT BE USED IN WHOLE OR IN PART WITHOUT PRIOR WRITTEN PERMISSION.

PDWG,NO: 0470-1

**深圳市步步精科技有限公司**

NAME: TYPE-C 24P 母座 直立式 H=15.0 四脚插 端子SMT

APPD.: JM\_Zheng

CHKD.: TSP

DR.: LYX

PJ. NO.: UC.01.62-1W-0001

SIZE: A4 DRW NO.:

FINISH: SEE NOTES MAT'L.: SEE NOTES

SCALE: N/A REV.: A3 UNIT: mm PAGE: 1/2

REV.	ECN NO	CONTENT	DATE	ENGINEER
AO				

AROUND THE OUTER PERIPHERY IN A TURE.  
WEEDING THE COVER TAPE.

合格标签  
Qualified Label

PELLING ANGLE: 165°X~180°X

PULL OUT DIRECTION

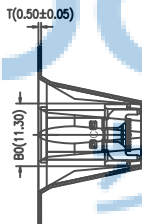
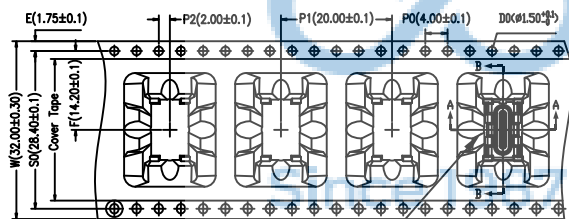
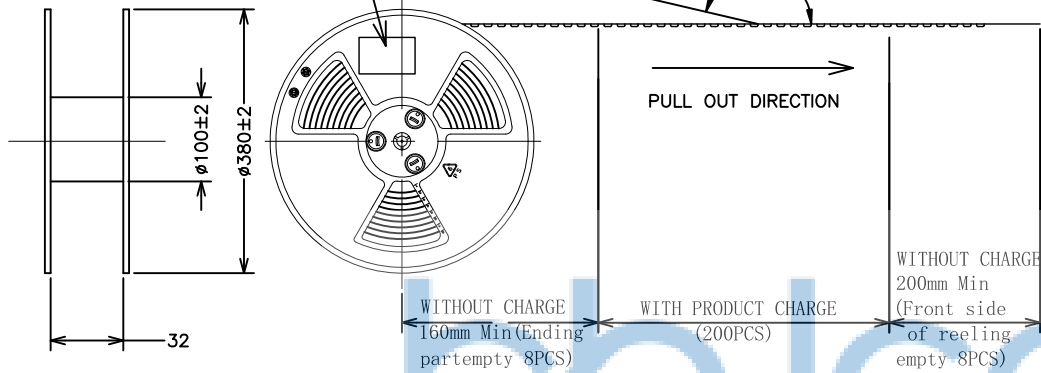

载带拉出方向



SECTION A-A

SECTION B-B

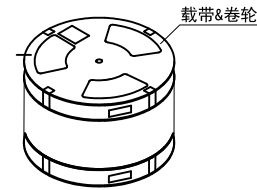

载带&卷轮

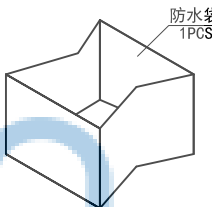

防水袋  
1PCS

在装入产品的  
防水袋中放置2  
包干燥剂

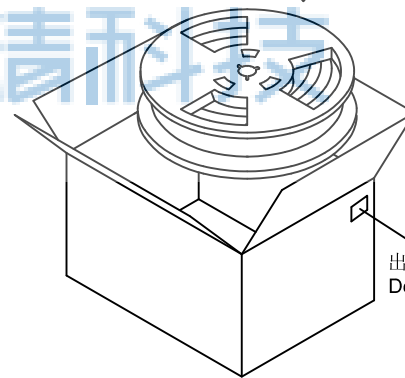

出货标签  
Delivery Label

产品规格 Product spec.	/
包装容量 Pcs/Reel Reel/Ctos.	200 8
QTY 个/箱 Pcs/Ctos.	1600
重量 N. W. 毛重 G. W.	/kg /kg

**包装规范说明:**

1. 如图所示首先CARRIER TAPE (载带) 需先预留8PCS空格后方可置入成品,并附COVER TPAE(上带)覆盖于上,再配合带装机自动卷绕于REEL(塑胶卷轴)收料。  
As shown from picture, the initial starting carrier need to be emptied for 8 pcs, then put connector on Inth carrier; Then cover it with Cover Tape, and Reeling it with Reel auto machine.
2. 在定量包装完成后,前端CARRIER TAPE 亦需预留8PCS空格,而COVER TPAE配合CARRIER TYPE长度覆盖后,并须再超出200mm以上,最后以胶纸贴固,并于REEL盘上方贴合格标签一张。  
In the end of the Reel, need to empty 8 pcs carrier tape; After covering the carrier, then the Cover Tape need to be 200mm longer, and use tape to fix the cover tape to the reel. Put "Qualified Label" on the tape.
3. 注意:COVER TAPE不可浮起或有贴附不顺,歪斜及成品放置方向错误之现象。  
Attention: no deformation of Cover Tape is allowed (protruded plastic, or not smooth, bednt or product is wrong positioned)
4. 在纸箱内左右,前后侧各放入一块三角卡板,每个PE袋中装入8个REEL盘,并在PE袋中放入2PCS干燥剂,用胶带封好,在每个纸箱内装入8PCS卷盘,共1叠,盖上箱盖后以胶带封箱,于侧位置贴出货标签一张。  
Inside of carton, at left and right side, put triangle fixed card; Put 8Reels to PE bag, and put 1 bags of desiccant inside the PE bag. Each carton has 8 reels. Put "Delivery label" on side of the carton.
5. 零箱部分, 出货时须用缓冲物填满。  
The fractional box must be filled by cushion before shipment.

NO.	包材名称 Items	用量 Usage	适用类别 Series	备注 / Remark
①	纸箱 Carton	1	广东省外,K<K	400*400*310mm
②	PE Bag	2		600*600*0.05mm
③	carrier	8		W=32mm PET 透明L=4.32M
④	tape	/		W=25.5MM, 200m/r透明色
⑤	塑胶卷轴 Plastic Reel	8		0380mm, W=37mm
⑥	干燥剂 Desiccant	4		
⑦	环保标签 RoHS Label			
⑧	合格标签 Qualified Label	8		80*35mm
⑨	出货标签 Delivery Label	1		80*50mm

THIS DOCUMENT IS THE  
SOLE PROPERTY OF  
BBJconn Technology Co.,Ltd.  
Corporation AND SHOULD  
NOT BE USED IN WHOLE  
OR IN PART WITHOUT  
PRIOR WRITTEN PERMISSION.  
PDWG,NO: 0470-1

**深圳市步步精科技有限公司**

NAME: TYPE-C 24P 母座 直立式 H=15.0 四脚插 端子SMT

APPD. JM\_Zheng

CHKD. TSP

DR. LYX

PJ. NO.: UC.01.62-1W-0001

SIZE: A4 DRW NO.:

FINISH: SEE NOTES MAT'L.: SEE NOTES

SCALE: N/A REV.: A3 UNIT: mm PAGE: 2/2