

REV.	ECN NO	CONTENT	DATE	ENGINEER
A0		Initial release	/	TSP

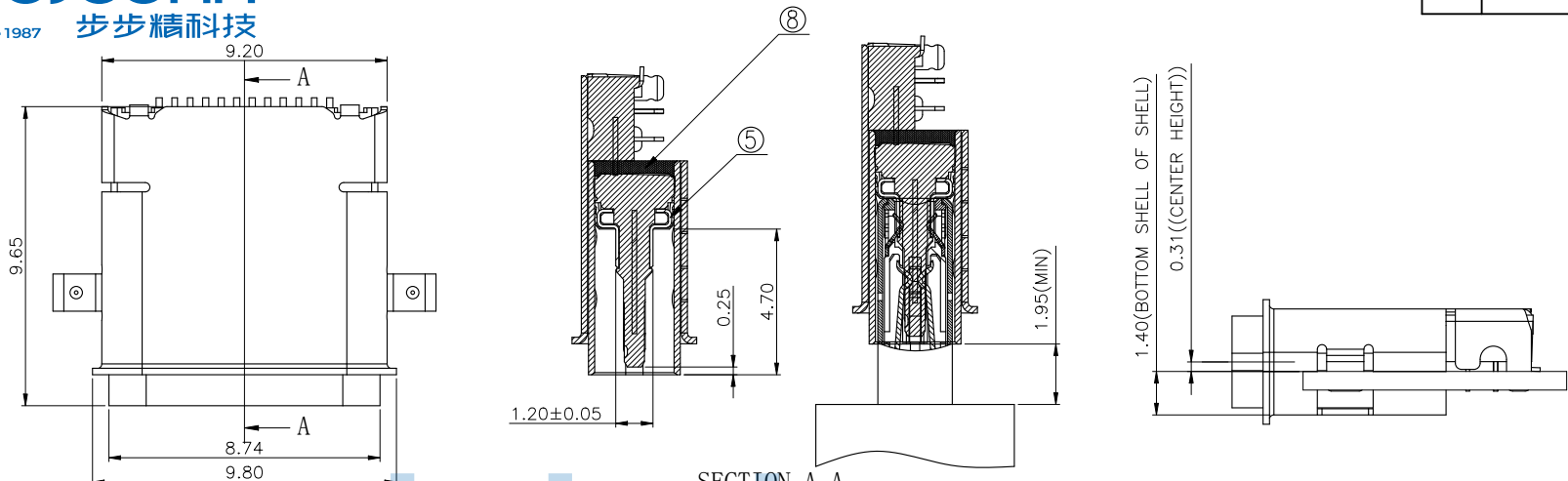

SECTION A-A

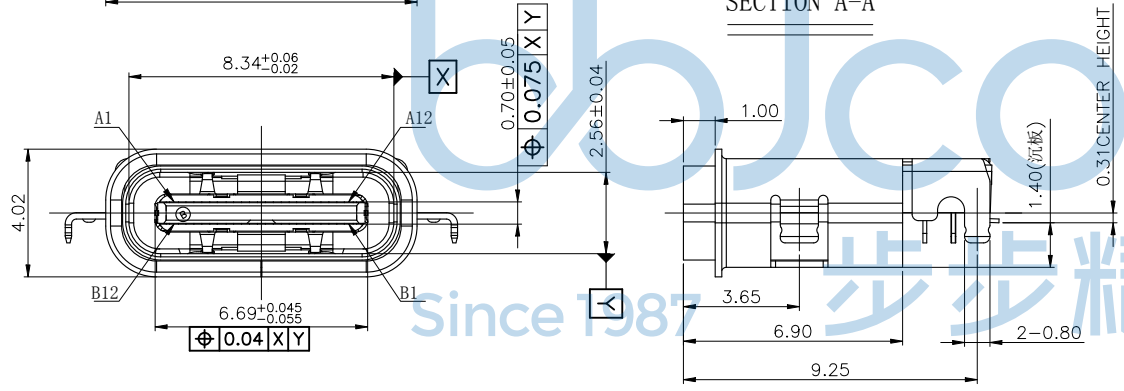

LASER WELDING POING

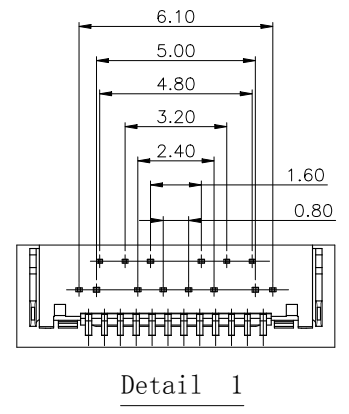
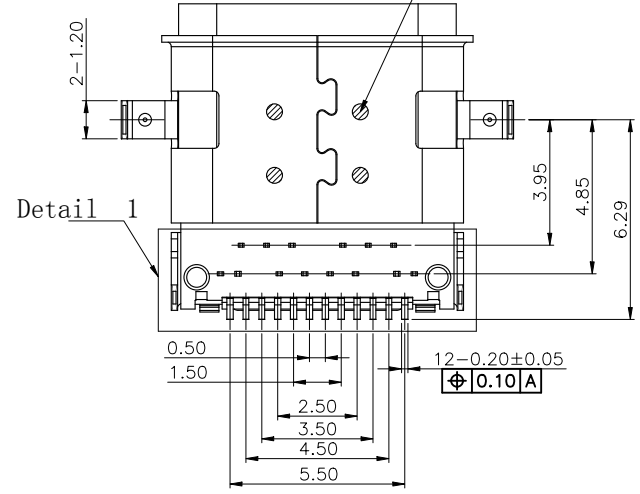

THIS DOCUMENT IS THE SOLE PROPERTY OF BBJconn Technology Co., Ltd. Corporation AND SHOULD NOT BE USED IN WHOLE OR IN PART WITHOUT PRIOR WRITTEN PERMISSION.		深圳市步步精科技有限公司 .X: ±0.38 .X': ±3" .XX: ±0.25 .X': ±2" .XXX: ±0.13 .XX': ±1"		NAME: TYPE-C 24P 母座 四脚插 双外壳 端子DIP+SMT 沉板1.4 L=9.65 CH=0.31	
APPD.	JM_Zheng	PJ. NO.: UC.01.52-1W-0031		SIZE: A4 DRW NO.:	
CHKD.	LYX	FINISH: SEE NOTES		MAT'L.: SEE NOTES	
PDWG.NO:	0228-1	DR.	TSP	SCALE: N/A	REV.: A0 UNIT: mm PAGE: 1/4

REV.	ECN NO	CONTENT	DATE	ENGINEER
A0		Initial release	/	TSP

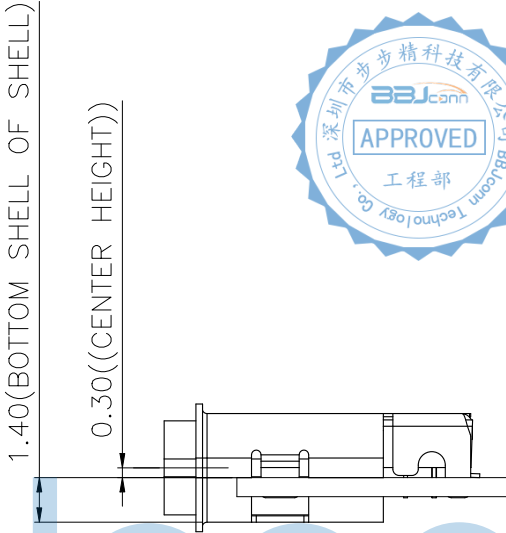
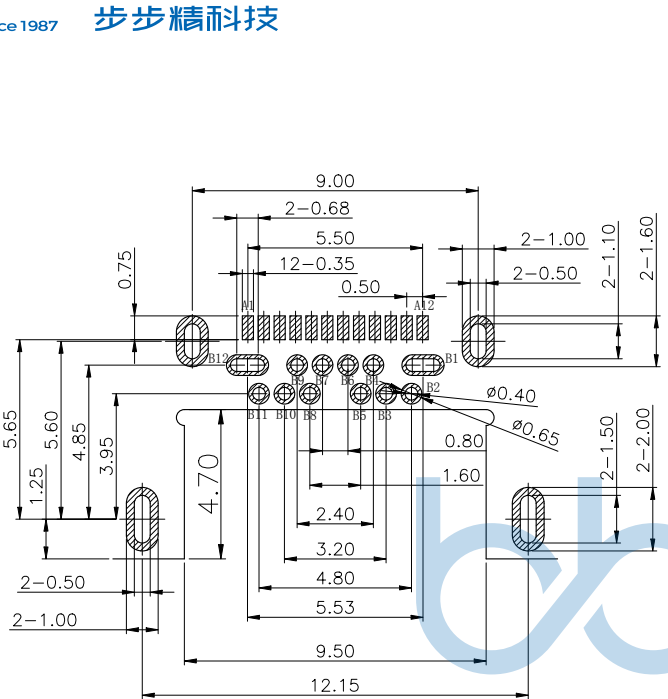

- MATERIAL:**
MOLDING: LCP UL94 V-0
CONTACT: COPPER ALLOY.
PLATED GOLD ON CONTACT AREA,
G/F GOLD ON SOLDER AREA,
50u" NICKEL PLATING OVER ALL.
SHELL: SUS304-H, T=0.30±0.03mm
50u" NICKEL PLATING OVER ALL.
EMI SHILD: SUS304-H, T=0.12±0.03mm
LATCH: SUS301-H, T=0.15±0.03mm
- MECHANICAL:**
INSERTION: 5°~20N.
EXTRACTION: 8°~20N.
DURABILITY: 10000 CYCLES
- ELECTRICAL:**
CURRENT: 5A MAX FOR VBUS;
1.25A MAX FOR OTHER.
VOLTAGE: 20VDC MAX
WITHSTANDING VOLTAGE: 100V AC.
CONTACT RESISTANCE: 40mΩ MAX.
INSULATION RESISTANCE: 100MΩ MIN.
- ENVIRONMENTAL**
TEMPERATURE RANGE: -30° C TO +80° C

RECOMMENDED P.C.B LAYOUT(Both sides are sample)
Tolerance: ±0.05, Thickness=0.60mm

Since 1987

步步精科技

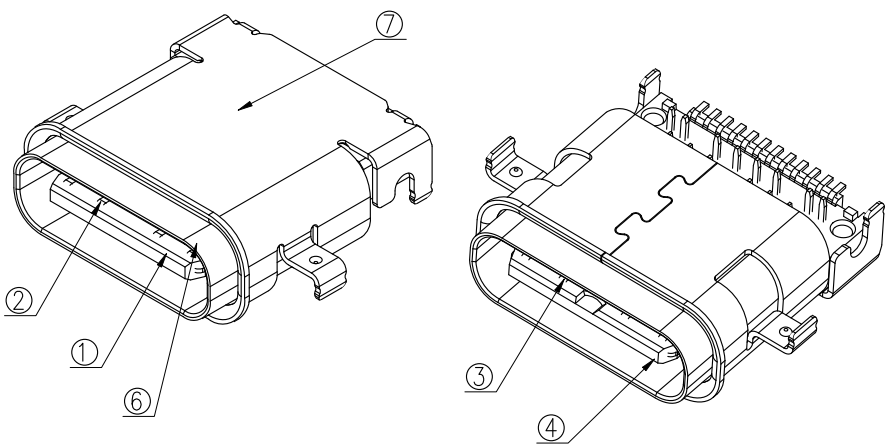

THIS DOCUMENT IS THE SOLE PROPERTY OF BBJconn Technology Co.,Ltd. Corporation AND SHOULD NOT BE USED IN WHOLE OR IN PART WITHOUT PRIOR WRITTEN PERMISSION.		深圳市步步精科技有限公司 .X: ±0.38 .X': ±3" .XX: ±0.25 .X'': ±2" .XXX: ±0.13 .X''': ±1"		NAME: TYPE-C 24P 母座 四脚插 双外壳 端子DIP+SMT 沉板1.4 L=9.65 CH=0.31	
APPD.	JM_Zheng	PJ. NO.: UC.01.52-1W-0031		SIZE: A4 DRW NO.:	
CHKD.	LYX	FINISH: SEE NOTES		MAT'L.: SEE NOTES	
PDWG.NO:	0228-1	DR.	TSP	SCALE: N/A	REV.: A0 UNIT: mm PAGE: 2/4

建议密封方式

REV.	ECN NO	CONTENT	DATE	ENGINEER
A0		Initial release	/	TSP

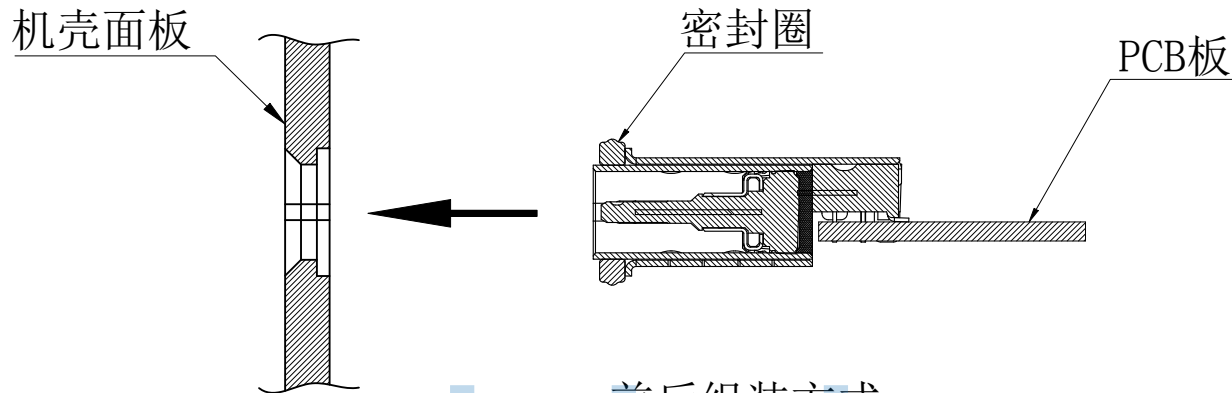

前后组装方式



机壳面板对密封圈与缩量0.30Min
(建议压缩量为密封圈直径大小40-50%)



机壳面板对密封圈与缩量0.30Min
(建议压缩量为密封圈直径大小40-50%)

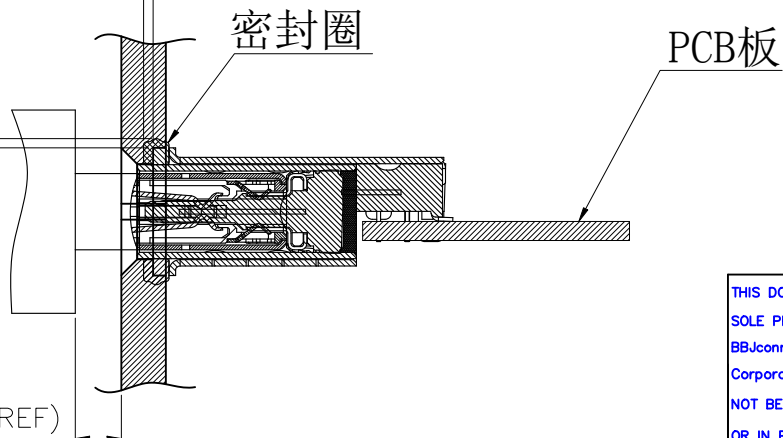

组装面板后公母头对插示意图



THIS DOCUMENT IS THE SOLE PROPERTY OF BBJconn Technology Co.,Ltd. Corporation AND SHOULD NOT BE USED IN WHOLE OR IN PART WITHOUT PRIOR WRITTEN PERMISSION.		深圳市步步精科技有限公司 .X: ±0.38 .X': ±3" .XX: ±0.25 .X'': ±2" .XXX: ±0.13 .X''': ±1"		NAME: TYPE-C 24P 母座 四脚插 双外壳 端子DIP+SMT 沉板1.4 L=9.65 CH=0.31	
APPD.	JM_Zheng	PJ. NO.: UC.01.52-1W-0031		SIZE: A4 DRW NO.:	
CHKD.	LYX	FINISH: SEE NOTES		MAT'L.: SEE NOTES	
PDWG.NO:	0228-1	DR.	TSP	SCALE: N/A	REV.: A0 UNIT: mm PAGE: 3/4

REV.	ECN NO	CONTENT	DATE	ENGINEER
A0		Initial release	/	TSP

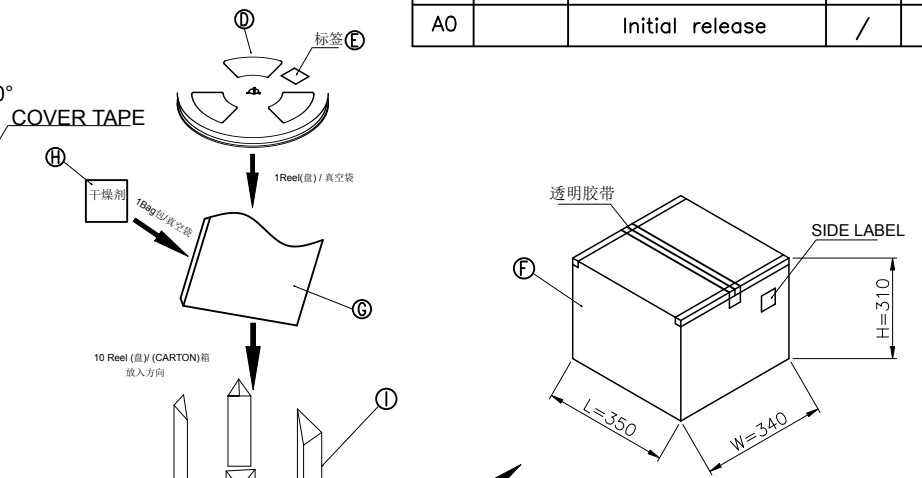
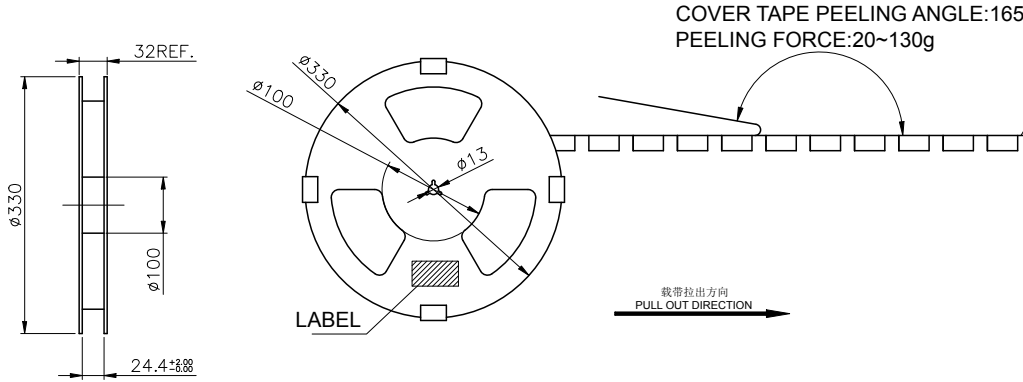

防水胶圈包装(两者独立包装)

5000	6	30000
PCS/BAG	BAG/CASE	PCS/CASE

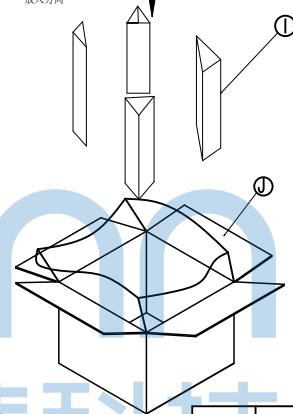
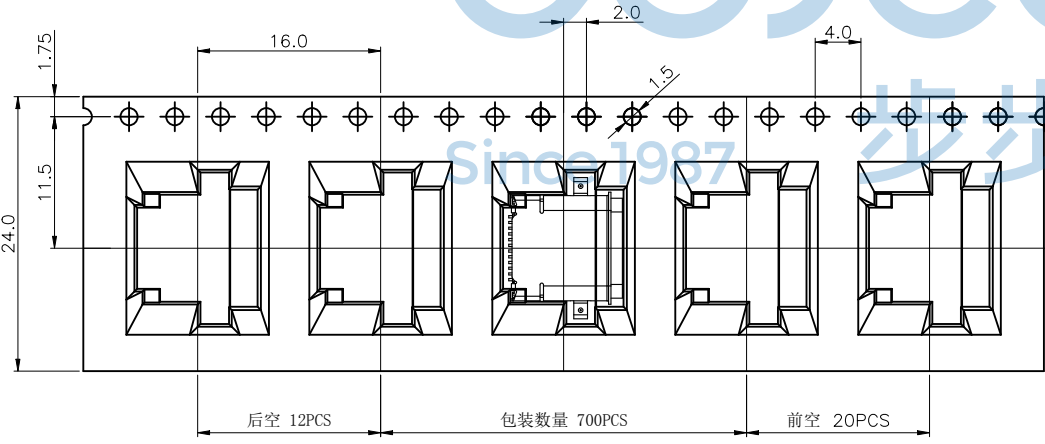

J	PE袋	1	630L*620W
I	三角护柱	4	
H	干燥剂	10	
G	真空袋	10	500L*450W
F	纸箱	1	350L*340W*310H
E	标签	10	
D	REEL	10	
C	COVER TAPE	10	21.3m/m (1R/300M)
B	CARRIER TAPE	10	12511(L)*24(W)*0.4(T)
A	Phone Jack	7000	U501T24J4FZL2
NO	DESCRIPTION	Q'TA(PCS)	SPEC



THIS DOCUMENT IS THE SOLE PROPERTY OF BBJconn Technology Co., Ltd. Corporation AND SHOULD NOT BE USED IN WHOLE OR IN PART WITHOUT PRIOR WRITTEN PERMISSION.

PDWG.NO: 0228-1

深圳市步步精科技有限公司

NAME: TYPE-C 24P 母座 四脚插 双外壳
端子DIP+SMT 沉板1.4 L=9.65 CH=0.31

PJ. NO.: UC.01.52-1W-0031
SIZE: A4 | DRW NO.:
FINISH: SEE NOTES | MAT'L.: SEE NOTES
SCALE: N/A | REV.: A0 | UNIT: mm | PAGE: 4/4

APPD.	JM_Zheng
CHKD.	LYX
DR.	TSP