

| REV | ECN NO | CONTENT | DATE | ENGINEER |
|-----|--------|-----------------|------|----------|
| A0 | | INITIAL RELEASE | / | SGF |

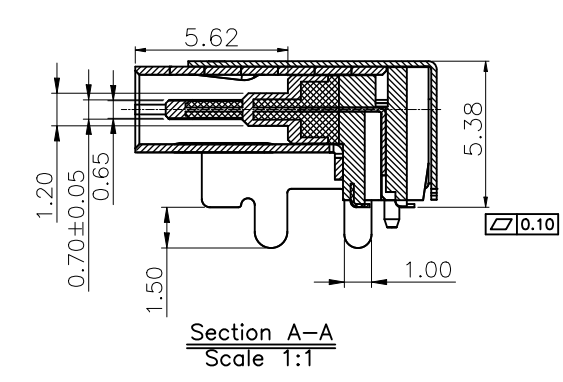

NOTES:
 1.MATERIAL:
 MOLDING: LCP UL94 V-0
 CONTACT: COPPER ALLOY.
 PLATED GOLD ON CONTACT AREA,
 G/F GOLD ON SOLDER AREA,
 50u" NICKEL PLATING OVER ALL.
 OUTER SHELL: SUS304,T=0.20±0.03mm
 50u" NICKEL PLATING OVER ALL.
 G/F FOOT BRUSHING GOLD
 INNER SHELL: SUS304,T=0.30±0.03mm
 50u" NICKEL PLATING OVER ALL.
 LATCH: SUS301,T=0.15±0.03mm
 2.MECHANICAL:
 INSERTION: 5~20N.
 EXTRACTION: 8~20N.
 DURABILITY: 10000 CYCLES
 3.ELECTRICAL:
 CURRENT: 5A MAX FOR VBUS;
 1.25A FOR GND,0.25A FOR OTHER OTHER.
 VOLTAGE: 20VDC MAX
 WITHSTANDING VOLTAGE: 100V AC.
 CONTACT RESISTANCE: 40mΩ MAX.
 INSULATION RESISTANCE: 100MΩ MIN.
 4.ENVIRONMENTAL
 TEMPERATURE RANGE -40°C ~ +85°C

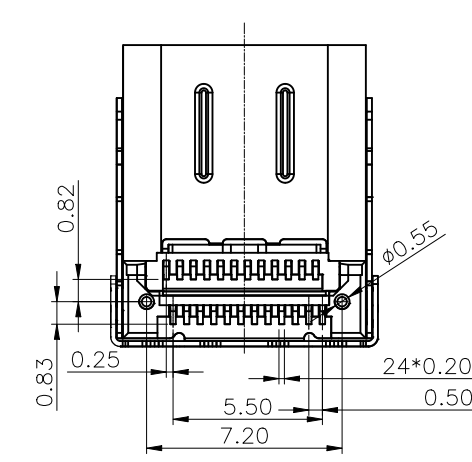
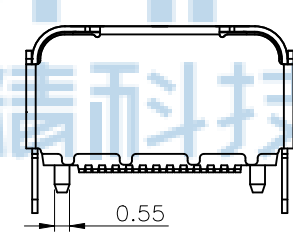
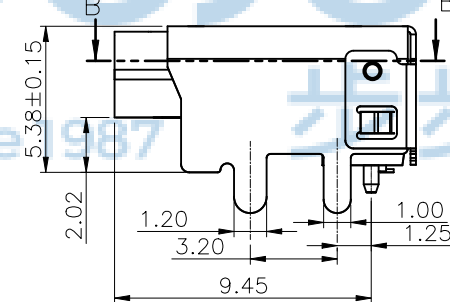
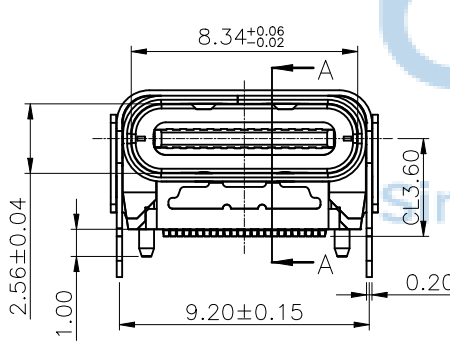
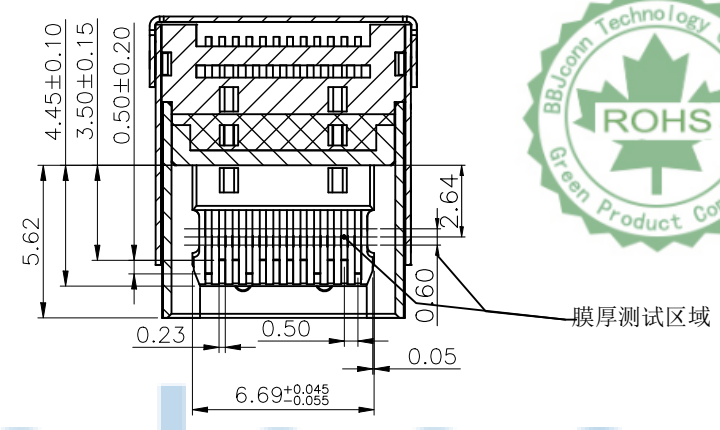
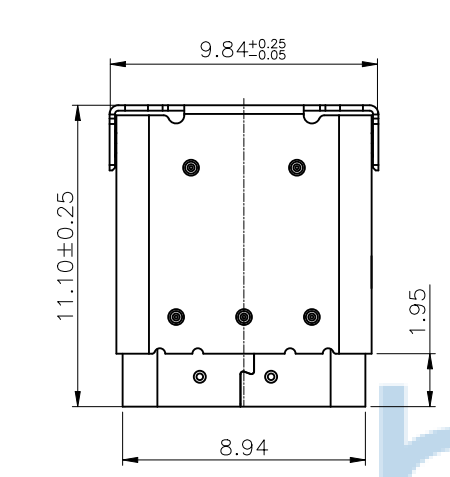

| | | | |
|-----------------------------------------------------------------------------------------------------------------------------------------|----------|--------------------------------------------------------------------------------------|-------------------------------------------------------------------------------|
| THIS DOCUMENT IS THE SOLE PROPERTY OF BBJconn Technology Co.,Ltd. Corporation AND SHOULD NOT BE USED IN WHOLE PRIOR WRITTEN PERMISSION. | | 深圳市步步精科技有限公司 | |
| .X: ±0.38 X': ±3" .XX: ±0.25 X'': ±2" .XXX: ±0.13 .XX': ±1" | | NAME: TYPE-C 24P 母座 双壳 无翻边 板上四脚插 脚长1.5 脚距3.2 带柱 端子双排SMT 垫高2.02 L=11.10 CH=3.60 编带 | |
| APPD | JM_Zheng | PJ NO: 126-221-240005-T7G SIZE:A4 DRW NO: | FINISH:SEE NOTES MAT'L:SEE NOTES SCALE:N/A REV:A0 UNIT:mm PAGE:1/4 |
| CHKD | LYX | | |
| PDWG NO: 0228-1 | DR | SGF | |

| | | | | |
|-----|--------|-----------------|------|----------|
| REV | ECN NO | CONTENT | DATE | ENGINEER |
| AO | | INITIAL RELEASE | / | SGF |

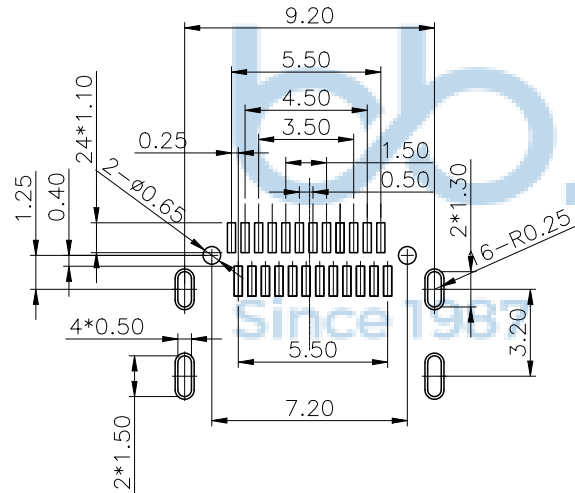
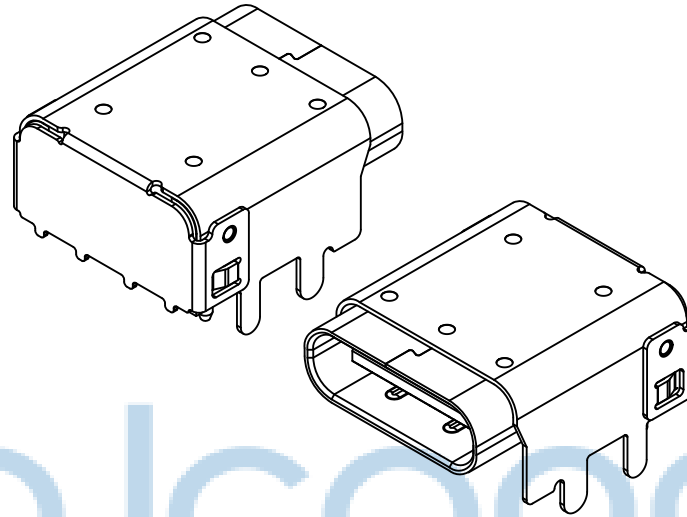

RECOMMENDED PCB LAYOUT(COMPONENT SIDE)

PCB THICKNESS: 1.60±0.05
DEFAULT TOLERANCE: ±0.05

USB TYPE-C FULL-FEATURED RECEPTACLE INTERFACE PIN ASSIGNMENTS

| PIN | Signal Name | Description | PIN | Signal Name | Description |
|-----|-------------|-----------------------------------------------------------|-----|-------------|-----------------------------------------------------------|
| A1 | GND | Ground return | B12 | GND | Ground return |
| A2 | SSTXp1 | Positive half of first SuperSpeed TX differential pair | B11 | SSRXp1 | Positive half of first SuperSpeed RX differential pair |
| A3 | SSTXn1 | Negative half of first SuperSpeed TX differential pair | B10 | SSRXn1 | Negative half of first SuperSpeed RX differential pair |
| A4 | VBUS | Bus Power | B9 | VBUS | Bus Power |
| A5 | CC1 | Configuration Channel | B8 | SBU2 | Sideband Use(SBU) |
| A6 | Dp1 | Positive half of the USB 2.0 differential pair-Position 1 | B7 | Dn2 | Negative half of the USB 2.0 differential pair-Position 2 |
| A7 | Dn1 | Negative half of the USB 2.0 differential pair-Position 1 | B6 | Dp2 | Positive half of the USB 2.0 differential pair-Position 2 |
| A8 | SBU1 | Sideband Use(SBU) | B5 | CC2 | Configuration Channel |
| A9 | VBUS | Bus Power | B4 | VBUS | Bus Power |
| A10 | SSRXn2 | Negative half of second SuperSpeed RX differential pair | B3 | SSTXn2 | Negative half of second SuperSpeed TX differential pair |
| A11 | SSRXp2 | Positive half of second SuperSpeed RX differential pair | B2 | SSTXp2 | Positive half of second SuperSpeed TX differential pair |
| A12 | GND | Ground return | B1 | GND | Ground return |



THIS DOCUMENT IS THE
SOLE PROPERTY OF
BBJconn Technology Co.,Ltd.
Corporation AND SHOULD
NOT BE USED IN WHOLE
PRIOR WRITTEN PERMISSION.

深圳市步步精科技有限公司

| | | | |
|-----------------------|----------|------------------------------------------|--|
| .X: ±0.38 X': ±3' | | NAME: | |
| .XX: ±0.25 X'': ±2' | | TYPE-C 24P 母座 双壳 无翻边 板上四脚插 脚长1.5 脚距 | |
| .XXX: ±0.13 XX'': ±1' | | 3.2 带柱 端子双排SMT 垫高2.02 L=11.10 CH=3.60 编带 | |
| APPD | JM_Zheng | PJ NO: 126-221-240005-T7G | |
| CHKD | LYX | SIZE:A4 DRW NO: | |
| DR | SGF | FINISH:SEE NOTES MAT'L:SEE NOTES | |
| PDWG NO: 0228-1 | | SCALE:N/A REV:AO UNIT:mm PAGE:2/4 | |

| REV | ECN NO | CONTENT | DATE | ENGINEER |
|-----|--------|-----------------|------|----------|
| A0 | | INITIAL RELEASE | / | SGF |

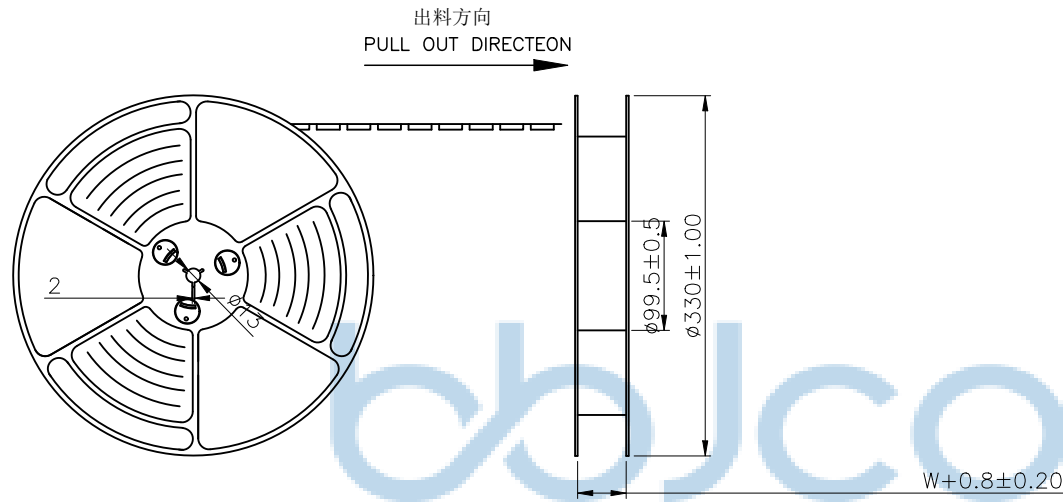

NOTES
1. 帶子引導長度
LEAD TAPE LENGTH
出料方向
PULL OUT DIRECTEON

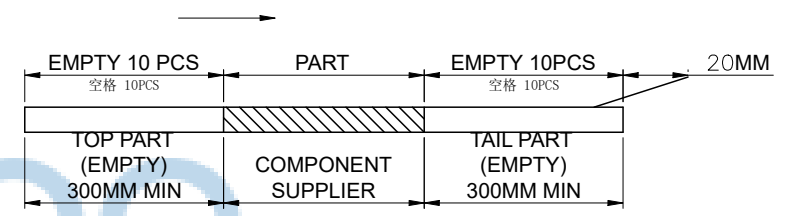

2. 出貨運輸過程中一定注意:
THIS REQUIREMENT SHOULD BE APPLIED AT SHIPMENT:
卷帶在運輸過程中不能散開
PEELING OFF SHOULD NOT BE ALLOWED DURING TRANSPORTATION

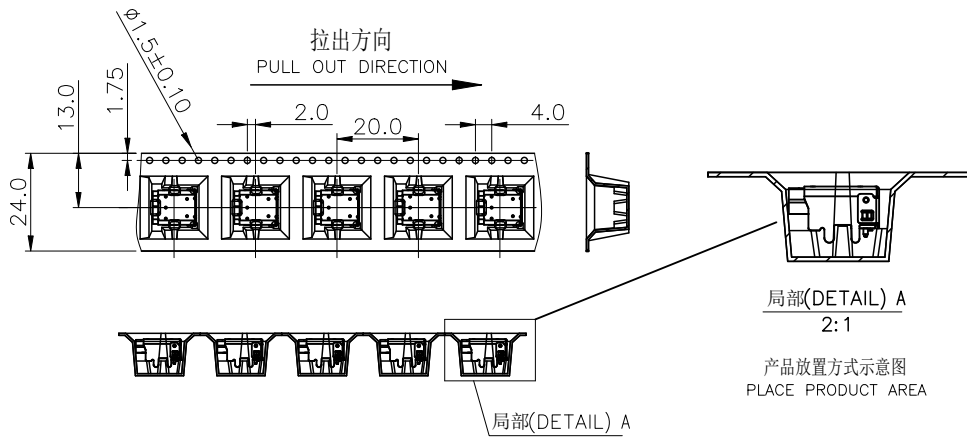

| | | | | | | | | |
|-----------------------------------------------------------------------------------------------------------------------------------------|------------------|----------------|------------------------------------------|----------|---------------------------|---------|------------------|-----------------|
| THIS DOCUMENT IS THE SOLE PROPERTY OF BBJconn Technology Co.,Ltd. Corporation AND SHOULD NOT BE USED IN WHOLE PRIOR WRITTEN PERMISSION. | 深圳市步步精科技有限公司 | | NAME: | | | | | |
| | .X: ± 0.38 | .X': $\pm 3'$ | TYPE-C 24P 母座 双壳 无翻边 板上四脚插 脚长1.5 脚距 | | | | | |
| | .XX: ± 0.25 | .X': $\pm 2'$ | 3.2 带柱 端子双排SMT 垫高2.02 L=11.10 CH=3.60 编带 | | | | | |
| | .XXX: ± 0.13 | .XX': $\pm 1'$ | APPD | JM_Zheng | PJ NO: 126-221-240005-T7G | | | |
| PDWG NO: 0228-1 | CHKD | LYX | DR | SGF | SIZE:A4 | DRW NO: | FINISH:SEE NOTES | MAT'L:SEE NOTES |
| | | | | | SCALE:N/A | REV:A0 | UNIT:mm | PAGE:3/4 |

Label pasting location (facing the back of the circular hole on the roll)

标签粘贴处 (朝卷带圆孔反面)

Location of label sticking (label

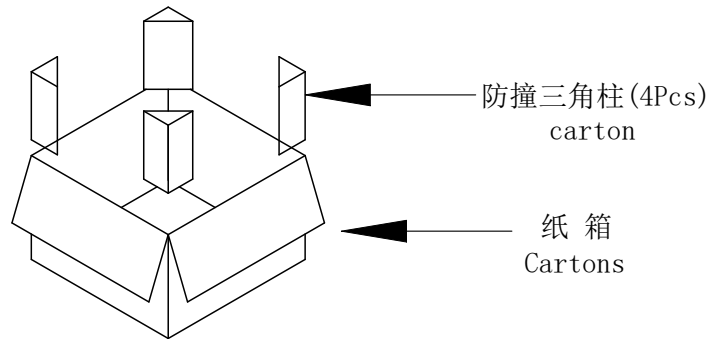
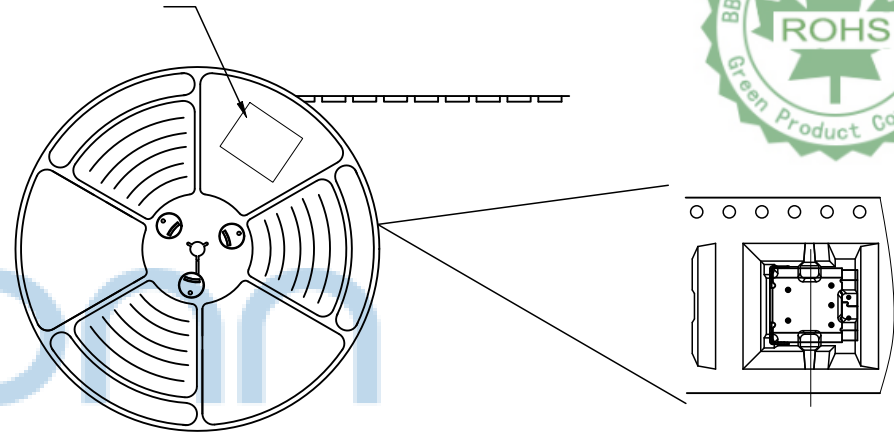
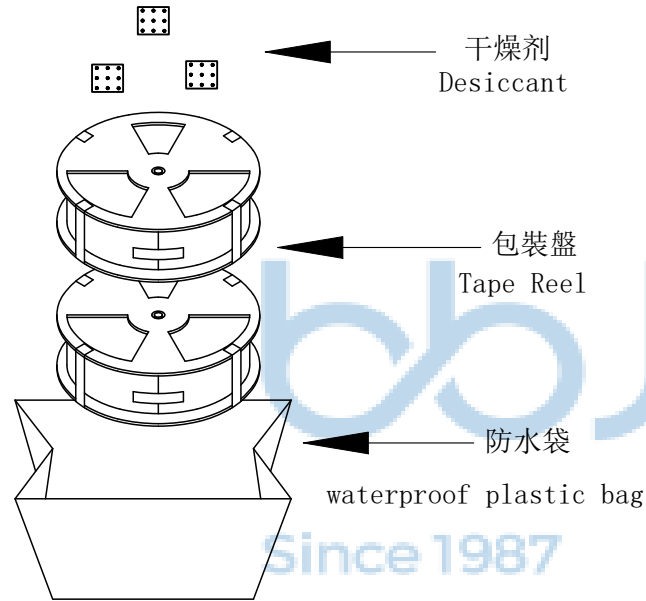

NOTE:

1. 每卷包装数量及每箱装箱数量如左下表格。
Packing q'ty of each reel & carton as below table shown.
2. 以上带覆盖下载带经包装机自粘包装
The above tape covers the download tape by self-adhesive packaging machine.
3. 将装满产品的卷盘放入纸箱并以胶带封口
Put reels in the carton and use adhesive tape to seal up.



| 包装数量 (PACKING CAPACITY) | | | 重量 WEIGHT (Kg) | | |
|-------------------------|--------------|------------|----------------|----------|----------|
| PCS/REEL | REELS/CARTON | PCS/CARTON | N.W./PCS | N.W./BOX | G.W./BOX |
| 400 | 10 | 4000 | 0.105 | 10.50 | 11.80 |

THIS DOCUMENT IS THE
SOLE PROPERTY OF
BBJconn Technology Co.,Ltd.
Corporation AND SHOULD
NOT BE USED IN WHOLE
PRIOR WRITTEN PERMISSION.

bbJconn 深圳市步步精科技有限公司

.X: ±0.38 X': ±3"
.XX: ±0.25 .X': ±2"
.XXX: ±0.13 .XX': ±1"

NAME:
TYPE-C 24P 母座 双壳 无翻边 板上四脚插 脚长1.5 脚距
3.2 带柱 端子双排SMT 垫高2.02 L=11.10 CH=3.60 编带

APPD JM_Zheng
CHKD LYX

PJ NO: 126-221-240005-T7G
SIZE:A4 | DRW NO:

PDWG NO: 0228-1
DR SGF

FINISH:SEE NOTES | MAT'L:SEE NOTES
SCALE:N/A | REV:AO | UNIT:mm | PAGE:4/4