

| REV. | ECN NO | CONTENT | DATE | ENGINEER |
|------|--------|---------|------|----------|
| A0 | | | | |

NOTE:
 1. MATERIAL SPECIFICATION:
 1. HOUSING: LCP, UL94 V-0
 2. TERMINAL: COPPER ALLOY
 3. MIN. PLATE: STAINLESS STEEL
 4. FRONT SHELL: STAINLESS STEEL
 5. EMI PLATE: STAINLESS STEEL
 2. PLATING SPECIFICATION:
 2-1. TERMINAL:
 NI 50 μ MIN. UNDER PLATED OVER ALL.
 AU PLATED ON THE FUNCTIONAL AREA OF CONTACT.
 (GOLD PLATING THICKNESS FOLLOW THE P/N)
 PLATING SPECIFICATIONS OF THE SOLDER AREA FOLLOW THE P/N
 2-2. FRONT SHELL:
 PLATING SPECIFICATIONS FOLLOW THE P/N
 2-3. MID PLATE&EMI PLATE:
 CLEAR ONLY
 3. MECHANICAL PERFORMANCE:
 3-1. INSERTION FORCE: 0.5 \pm 2.0KGF MAX
 3-2. REMOVAL FORCE: 0.8 \pm 2.0KGF MIN
 3-3. DURABILITY: 10000 CYCLES.
 4. ELECTRICAL PERFORMANCE:
 4-1. VOLTAGE RATING: 5V DC/AC(RMS. MAX)
 CURRENT RATING: 5A AMPS. FOR TOTAL VBUS/GND PINS.
 1.25AMPS FOR CC PIN, 0.25 AMPS. FOR ALL OTHER CONTACT.
 4-2. LLCR:
 VBUS&GND PINS AND OTHER PINS: 40m Ω /PIN MAX
 SHIELD: 50m Ω MAX
 LLCR MAX. CHANGE OF ALL PINS: 10m Ω
 4-3. INSULATION RESISTANCE: 100m Ω MIN
 4-4. DIELECTRIC WITHSTAND VOLTAGE, AC 100V FOR 1 MINUTE.
 5. ENVIRONMENTAL PERFORMANCE:
 OPERATING TEMPERATURE: -25 $^{\circ}$ C ~ +85 $^{\circ}$ C
 6. IR REFLOW:
 THE PEAK TEMPERATURE ON THE BOARD SHALL BE MAINTAINED FOR 10 SECONDS AT 260 $^{\circ}$ C

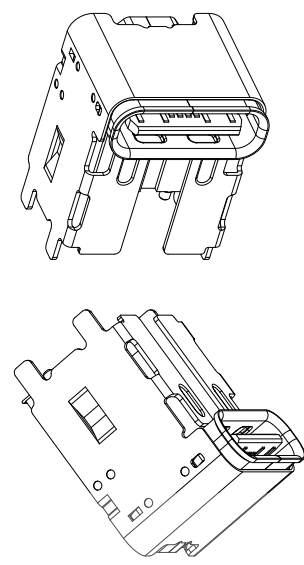

RECOMMENDED PCB LAYOUT(TOP VIEW)
 THICKNESS 0.8MM; DEFAULT TOLERANCE: \pm 0.05

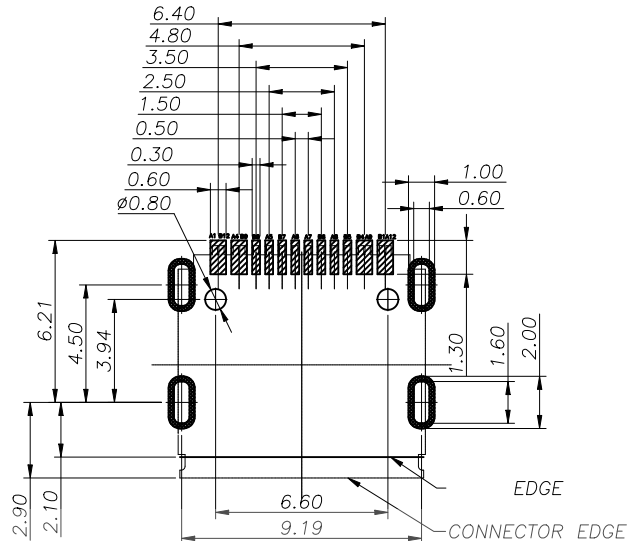
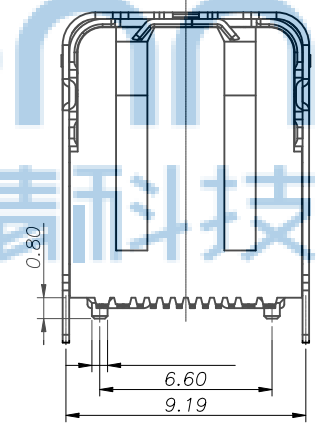
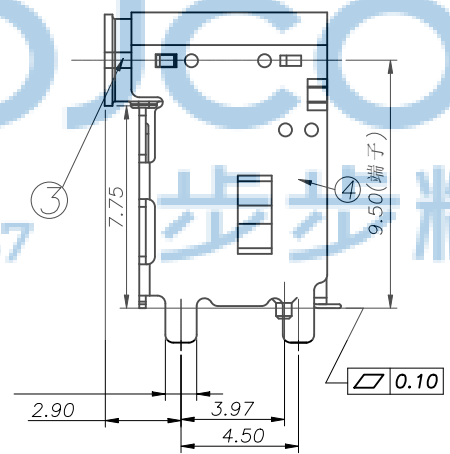
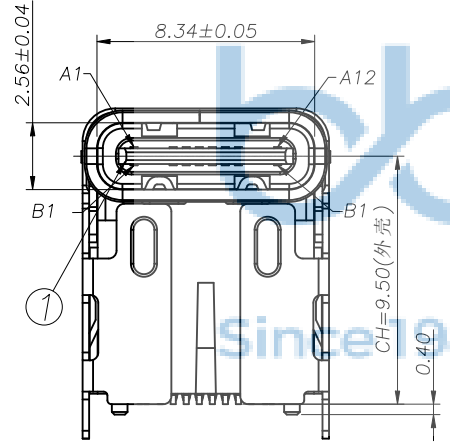
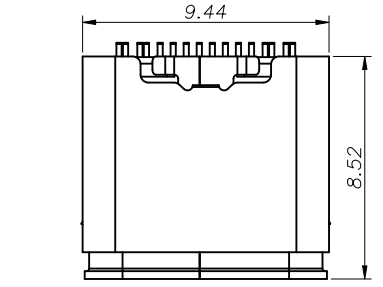

| NO | DESCRIPTION | MATERIAL | REMARK |
|----|-----------------|--------------------|--------------|
| 1 | HOUSING | LCP UL94 V-0 | BLACK |
| 2 | CONTACT | COPPER ALLOY C7025 | AU/NI PLATED |
| 3 | CONTACT | COPPER ALLOY C7025 | AU/NI PLATED |
| 4 | MOLDING | LCP UL94 V-0 | BLACK |
| 5 | SHIELDING PLATE | SUS 201 | / |
| 6 | SHELL | SUS 304 | NI PLATED |

USB TYPE-C PIN ASSIGNMENTS

| PIN NUMBER | A1 | A2 | A3 | A4 | A5 | A6 | A7 | A8 | A9 | A10 | A11 | A12 |
|-------------|-----|-----|-----|------|------|-----|-----|------|------|-----|-----|-----|
| SIGNAL NAME | GND | | | Vbus | CC1 | Dp1 | Dn1 | SBU1 | Vbus | | | GND |
| PIN NUMBER | B12 | B11 | B10 | B9 | B8 | B7 | B6 | B5 | B4 | B3 | B2 | B1 |
| SIGNAL NAME | GND | | | Vbus | SBU2 | Dn2 | Dp2 | CC2 | Vbus | | | GND |

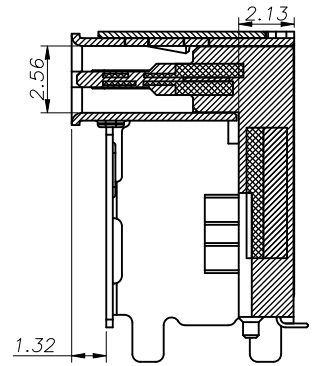
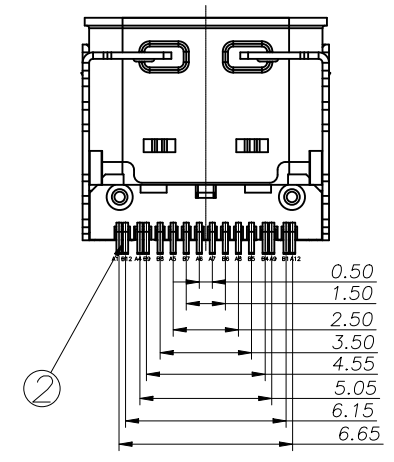

THIS DOCUMENT IS THE SOLE PROPERTY OF BBJconn Technology Co., Ltd. Corporation AND SHOULD NOT BE USED IN WHOLE OR IN PART WITHOUT PRIOR WRITTEN PERMISSION.

PDWG.NO: 0482-1

APPD. JM_Zheng
 CHKD. LYX
 DR. TSP

NAME: TYPE-C 16P 母座 L=8.52 CH=9.50 垫高7.75 板上四脚插 带柱 端子SMT

PJ. NO.: 126-221-160008-H8G
 SIZE: A4 DRW NO.:

FINISH: SEE NOTES MAT'L.: SEE NOTES
 SCALE: N/A REV.: A0 UNIT: mm PAGE: 1/2

A
B
C
D
E

A
B
C
D
E

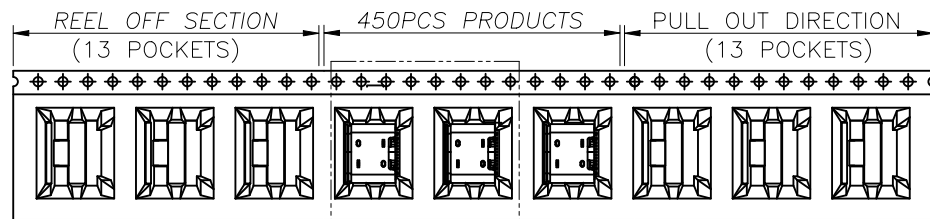

SEE DETAIL X

PEELING DIRECTION
165°~180°
PEELING ANGLE

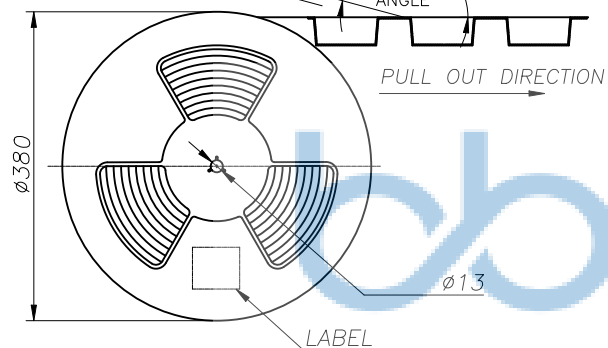

W+0.5

REEL AND TAPE

REEL AND TAPE

PAPER BOARD

PULL OUT DIRECTION

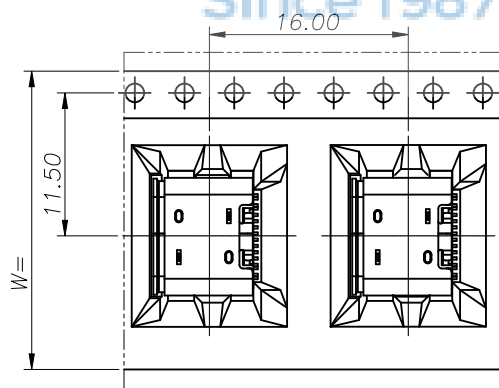

DETAIL X
SCALE 2:1

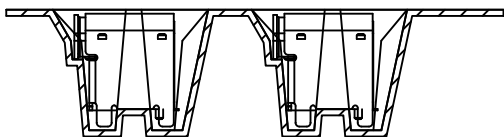

| REV. | ECN NO | CONTENT | DATE | ENGINEER |
|------|--------|---------|------|----------|
| AO | | | | |

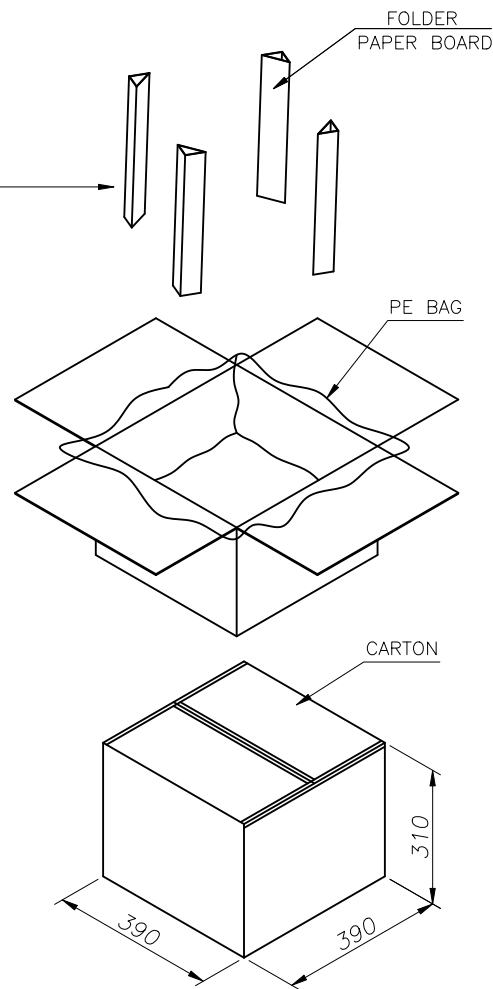

| | | |
|----|-----------------------|---------------------|
| 卷带 | 规格: ∅380mm | 包装数量: 450PCS |
| 纸箱 | 规格: 390mmX390mmX310mm | 包装数量: 10盘 / 4500PCS |

THIS DOCUMENT IS THE SOLE PROPERTY OF BBJconn Technology Co., Ltd. Corporation AND SHOULD NOT BE USED IN WHOLE OR IN PART WITHOUT PRIOR WRITTEN PERMISSION.
PDWG.NO: 0482-1

| | | |
|--|----------------------------------|---|
| 深圳市步步精科技有限公司 | | NAME: TYPE-C 16P 母座 L=8.52 CH=9.50 垫高7.75 板上四脚插 带柱 端子SMT |
| .X: ±0.38 .XX: ±0.25 .XXX: ±0.13 | X': ±3' .X': ±2' .XX': ±1' | PJ. NO.: 126-221-160008-H8G SIZE: A4 DRW NO.: |
| APPD. JM_Zheng | CHKD. LYX | FINISH: SEE NOTES MAT'L.: SEE NOTES |
| DR. TSP | SCALE: N/A | REV.: AO UNIT: mm PAGE: 2/2 |