



REV.	ECN NO	CONTENT	DATE	ENGINEER
A0		Initial release	/	TSP

备注 (NOTE):

1. 材质:

1. 胶芯: LCP UL94 V-0
2. 端子: C2680, T=0.2mm; 镍底, 镀金
3. 外壳: 不锈钢201-H 表面镀镍

2. 电气特性:

1. 接触区: 接触电阻40mΩ Max, 允许10mΩ变化量. 测试条件: 20mv, 100mA下测量.
2. 接触电流: 3A VBUS引脚; 1.25A用于GND引脚; 其他引脚为0.25A.
3. 额定电压: 5V.
4. 耐电电压: 100VAC.
5. 绝缘电阻: 至少100兆欧.

3. 机械性能:

1. 插入力: 0.5-2.0Kg
2. 拔出力: 0.6-2.04Kg
3. 插拔次数: 5000次.
4. 工作环境: -20°C to +85°C.

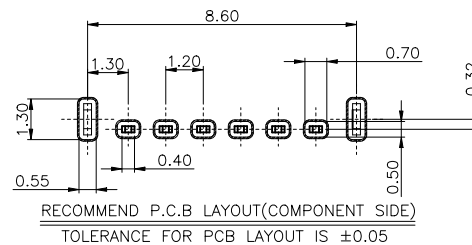
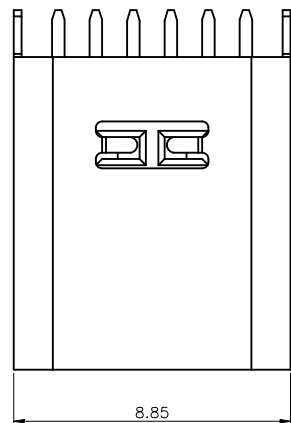
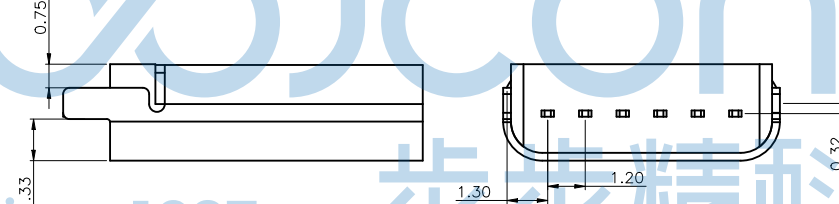
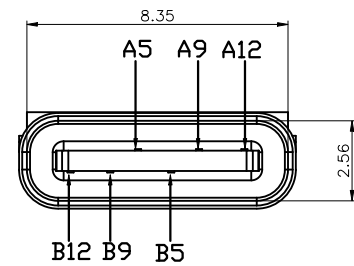
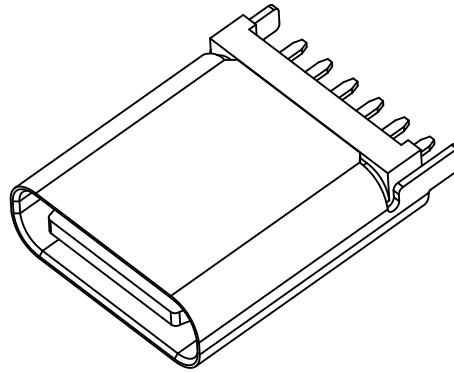
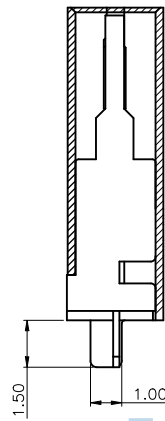
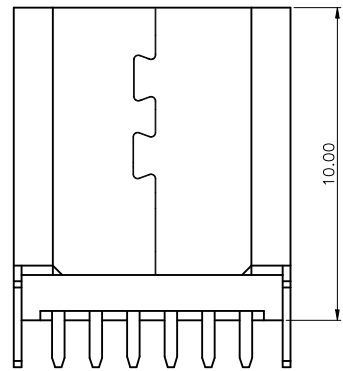

USB TYPE C PIN ASSIGNMENTS

PIN NUMBER	SIGNAL NAME	PIN NUMBER	SIGNAL NAME
		B12	GND
		B9	VBUS
A5	CC1		
		B5	CC2
A9	VBUS		
A12	GND		

TABLE:

NO	PART	Q'TY	Material
1	SHELL	1	ZINC ALLOY, NI30u" Min PLATED
2	CONTACT	6	C2680, TIN80u"/Au1u"/NI30u" PLATED
3	1MD HOUSING	1	LCP UL94 V-0 BLACK
4	CAP	1	LCP UL94 V-0 BLACK
5	WATERPROOF RING	1	SILICONE UL94 V-0 BLACK

THIS DOCUMENT IS THE SOLE PROPERTY OF BBJconn Technology Co., Ltd. Corporation AND SHOULD NOT BE USED IN WHOLE OR IN PART WITHOUT PRIOR WRITTEN PERMISSION.
PDWG.NO: 0057-2

深圳市步步精科技有限公司

.X: ±0.38 .XX: ±0.25 .XXX: ±0.13	X': ±3" X'': ±2" X'': ±1"	NAME: TYPE-C 6P 母座 直立式 两脚插 脚长1.5 H=10.0 管装
APPD. JM_Zheng	CHKD. LYX	PJ. NO.:
		SIZE: A4 DRW NO.:
		FINISH: SEE NOTES MAT'L.: SEE NOTES
		SCALE: N/A REV.: A0 UNIT: mm PAGE: 1/1