

REV.	ECN NO	CONTENT	DATE	ENGINEER
A0		Initial release	/	LYL

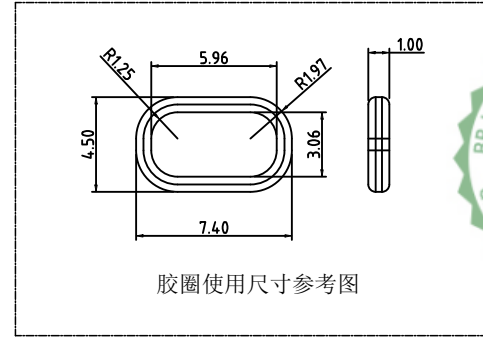

- MATERIAL SPECIFICATION: SEE TABLE 1
- MECHANICAL PERFORMANCE,
 - INSERTION FORCE: 5°20N.
 - REMOVAL FORCE: 8°20N.
 - DURABILITY: 10000 CYCLES.
- ELECTRICAL PERFORMANCE,
 - CURRENT RATING: 3.0A
VOLTAGE RATING: 12V
 - LLCR: VBUS & GND PINS AND OTHER PINS: 40mΩ/PIN MAX.
SHIELD: 50mΩ/MAX.
 - INSULATION RESISTANCE: 100MΩ MIN
 - DIELECTRIC WITHSTAND VOLTAGE, AC 100V FOR 1 MINUTE.
- ENVIRONMENTAL PERFORMANCE: OPERATING TEMPERATURE: -25° C~+85° C.
- WATER PROOFNESS: THIS PRODUCT IS BASED ON IPX7.
- IR REFLOW: THE PEAK TEMPERATURE ON THE BOARD SHALL BE MAINTAINED FOR 10 SECONDS AT 260° C.
- TESTING TIME: 24 HOURS

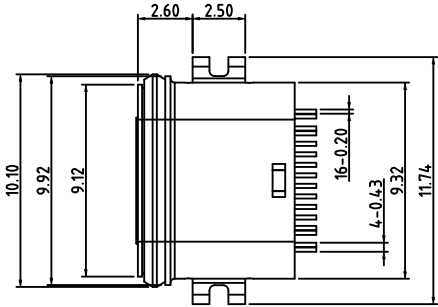
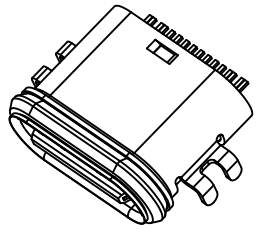
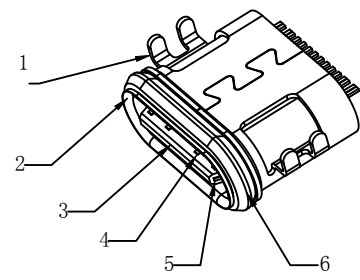
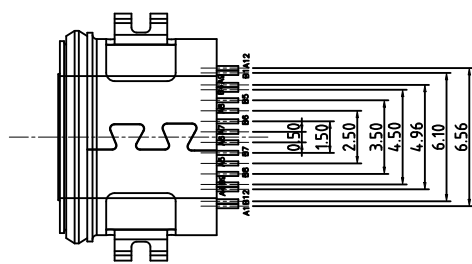
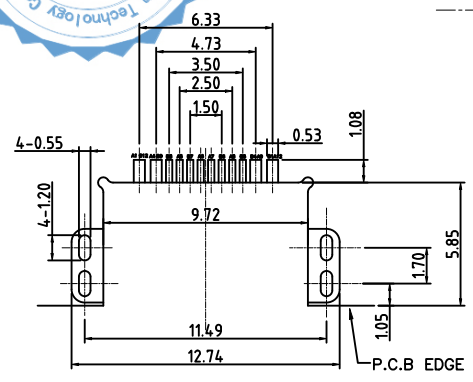
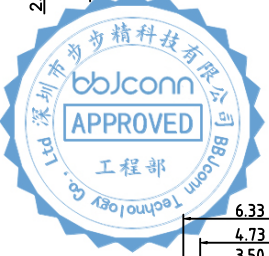
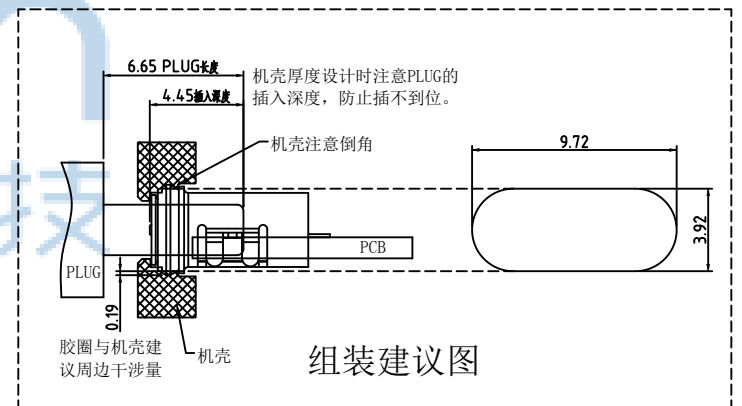
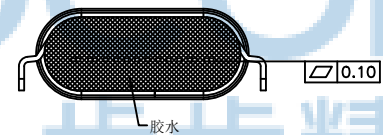
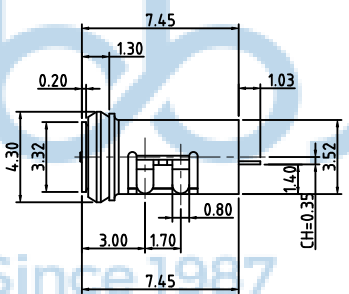
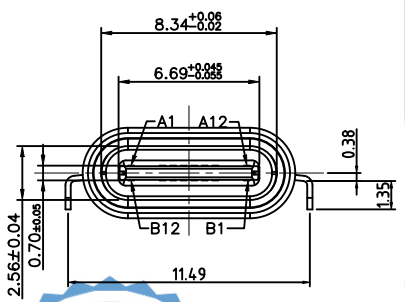

TABLE 1

NO.	DESCRIPTION	MATERIAL	REMARKS	QTY
6	o-ring	硅胶	WHITE	1PCS
5	SHIELDING PLATE	STAINLESS STEEL	WHITE	1PCS
4	CONTACT	High Conductivity Copper	Au/Ni Plated	1SET
3	HOUSING	HIGH TEMPERATURE PLASTIC	BLACK	1PCS
2	MAIN SHELL	STAINLESS STEEL	BLACK NI Plated	1PCS
1	OUTER SHELL	STAINLESS STEEL	NI Plated	1PCS

USB TYPE-C PIN ASSIGNMENTS

PIN NUMBER	SIGNAL NAME	PIN NUMBER	SIGNAL NAME
A1	GND	B12	GND
A4	VBUS	B9	VBUS
A5	CC1	B8	SBU2
A6	Dp1	B7	Dn2
A7	Dn1	B6	Dp2
A8	SBU1	B5	CC2
A9	VBUS	B4	VBUS
A12	GND	B1	GND

THIS DOCUMENT IS THE SOLE PROPERTY OF BBJconn Technology Co., Ltd. Corporation AND SHOULD NOT BE USED IN WHOLE OR IN PART WITHOUT PRIOR WRITTEN PERMISSION. PDWG.NO: 0514-1

深圳市步步精科技有限公司

NAME: TYPE-C 16P 防水母座 板上两脚插 沉板1.4 L= 7.45 CH=0.36 端子SMT 带防水圈 IPX7

APPD. JM_Zheng
CHKD. LYX
DR. LYL

PJ. NO.: 126-221-160005-N6G
SIZE: A4 DRW NO.:
FINISH: SEE NOTES MAT'L.: SEE NOTES
SCALE: N/A REV.: A0 UNIT: mm PAGE: 1/2

RECOMMENDED PCB LAYOUT(TOP VIEW)
DEFAULT TOLERANCE: ±0.05

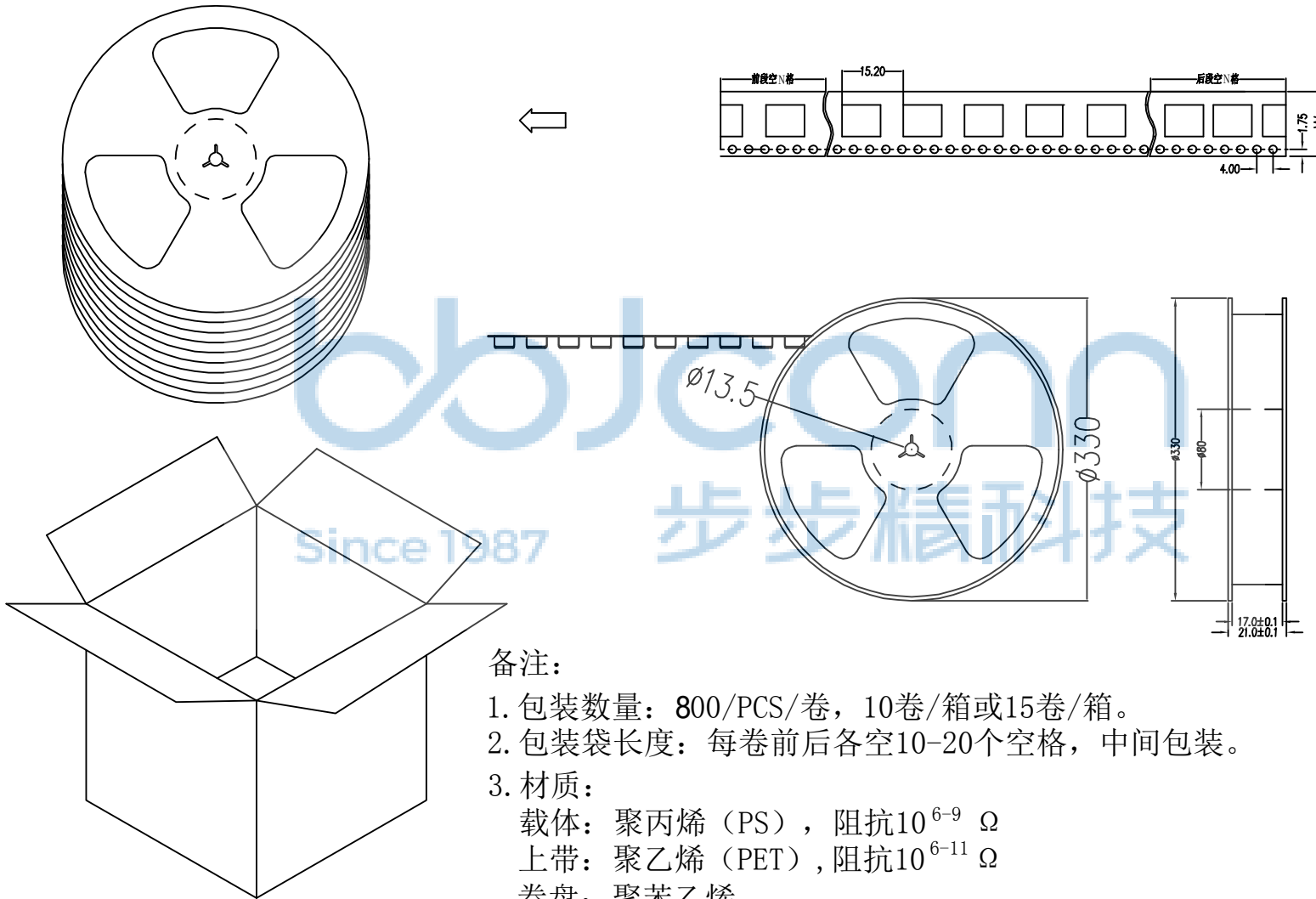

备注:

1. 包装数量: 800/PCS/卷, 10卷/箱或15卷/箱。
2. 包装袋长度: 每卷前后各空10-20个空格, 中间包装。
3. 材质:
载体: 聚丙烯 (PS), 阻抗 $10^{6-9} \Omega$
上带: 聚乙烯 (PET), 阻抗 $10^{6-11} \Omega$
卷盘: 聚苯乙烯。

纸箱规格: 345*345*350MM

THIS DOCUMENT IS THE SOLE PROPERTY OF BBJconn Technology Co.,Ltd. Corporation AND SHOULD NOT BE USED IN WHOLE OR IN PART WITHOUT PRIOR WRITTEN PERMISSION. PDWG.NO: 0514-1		深圳市步步精科技有限公司 .X: ±0.38 X': ±3" .XX: ±0.25 .X': ±2" .XXX: ±0.13 .XX': ±1"		NAME: TYPE-C 16P 防水母座 板上两脚插 沉板1.4 L=7.45 CH=0.36 端子SMT 带防水圈 IPX7 PJ. NO.: 126-221-160005-N6G SIZE: A4 DRW NO.: FINISH: SEE NOTES MAT'L.: SEE NOTES SCALE: N/A REV.: A0 UNIT: mm PAGE: 2/2	
APPD.	JM_Zheng				
CHKD.	LYX				
DR.	LYL				