

TOLERANCE UNSPECIFIED ±0.05mm



REV.	DESCRIPTION	NAME	DATE
A	NEWS ISSUE		

NOTES:

SPECIFICATION:

- CURRENT RATING: 3.0A MAX
- VOLTAGE: 100 VAC
- TEMPERATURE RANGE: -40 ° C ~ 85 ° C
- CONTACT RESISTANCE: 40 MILLIONHM MAX
- INSULATION RESISTANCE: 100 MEGOHMS MIN.
- INSERTION FORCE : 5N~20N
- UNMATING FORCE: 8N~20N
- DURABILITY: 5,000 CYCLES
- WATER PROOFNESS: THIS PRODUCT IS BASED ON IPX7.

结构设计注意:

- 成品使用时, 如有洗面奶泡沫、牙膏、洗手液、脏污液体, 请在TYPE-C口外面再设计一层外壳, 保护TYPE-C表面金手指不会被脏污覆盖。

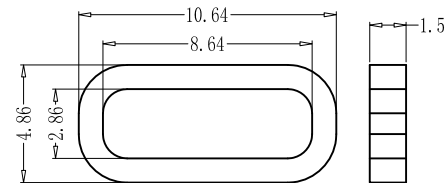
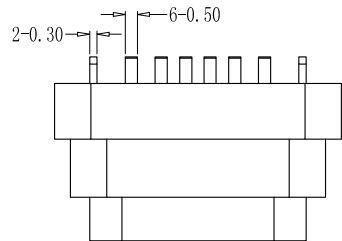
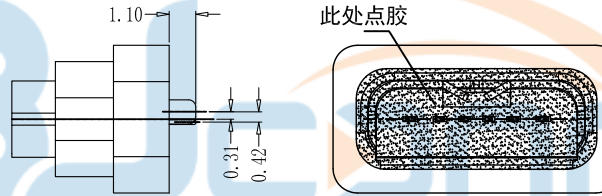
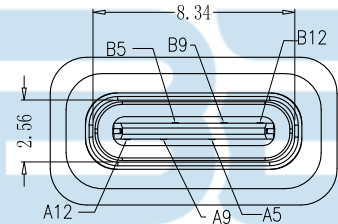
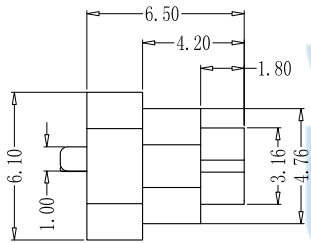

建议胶圈尺寸

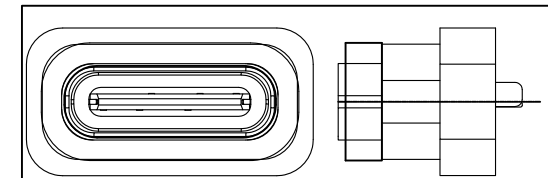

加防水圈示意图

NO.	DESCRIPTION	MATERIAL	REMARKS	QTY
5	防水圈	硅胶	BLACK	1PCS
4	SHELL	STAINLESS STEEL	Ni/Cu Plated	1PCS
3	SHELL	PA10T	UL 94V-0 BLACK	1PCS
2	CONTACT	BRASS	Au Plated	1SET
1	MD	HIGH TEMPERATURE PLASTIC	BLACK	1PCS

PIN	SIGNAL NAME	PIN	SIGNAL NAME
A5	CC1	B12	GND
A9	VBUS	B9	VBUS
A12	GND	B5	CC2

TOLERANCE UNSPECIFIED		深圳市步步精科技有限公司					
.0	±0.35	TITLE: TYPE-C 6P 防水母座直立式H=6.50 两脚插 端子DIP IPX7 带防水圈(USBC-0054 PX7-00)					
.00	±0.25						
.000	±0.15						
X.°	±2.00°						
CUSTOMER DRAWING		DRAWN/ DATE	设计 TSP	SIZE: A4	UNIT: MM.	PART. NO: 126-225-060001-N6G	
		CHECKED/ DATE	审核 LYX	SCALE: 1:1		PROJECTION	REV.: 版本
		APPROVED/ DATE	核准 LJP	DWG. PATH		0514-1	SHEET: 页码



REV.	DESCRIPTION	NAME	DATE
A	NEWS ISSUE		

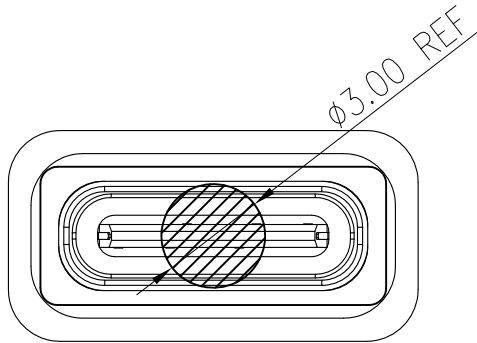
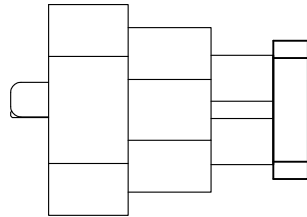

Vacuum Area



吸取盖图 纸

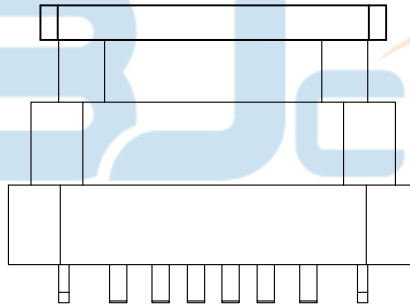

TOLERANCE UNSPECIFIED		深圳市步步精科技有限公司			
.0	±0.35	TITLE:			
.00	±0.25	TYPE-C 6P 防水母座直立式H=6.50 两脚插 端子DIP IPX7 带防水圈(USBC-0054IPX7-00)			
.000	±0.15	DRAWN/ DATE	设计 TSP	SIZE: A4	UNIT: MM.
X. °	±2.00°	CHECKED/ DATE	审核 LYX	PART. NO:	126-225-060001-N6G
CUSTOMER DRAWING		APPROVED/ DATE	核准 LJP	SCALE: 1:1	PROJECTION
				DWG. PATH	REV.: 版本
					SHEET: 页码
					0514-1



REV.	DESCRIPTION	NAME	DATE
A	NEWS ISSUE		

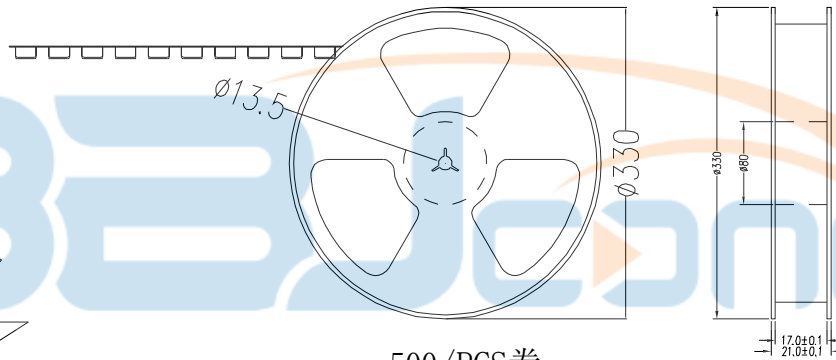
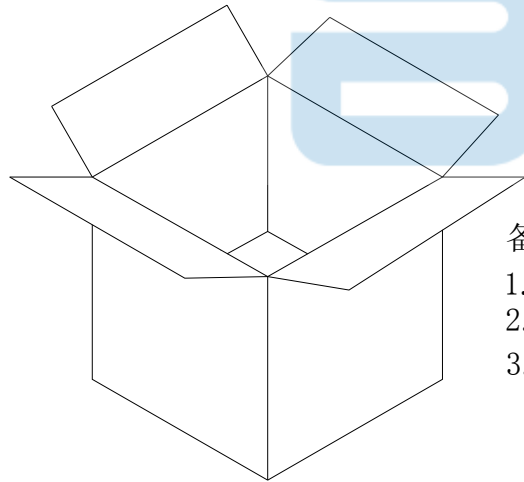
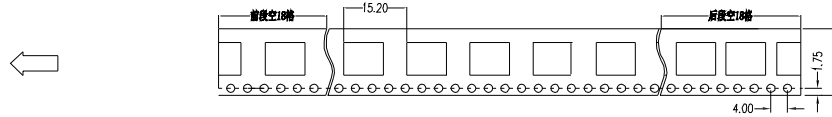
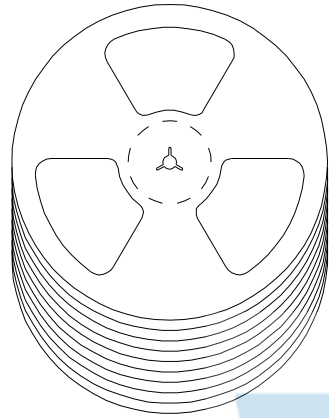

500/PCS卷



备注:

1. 包装数量: 500/PCS/卷, 10卷/箱或15卷/箱。
2. 包装袋长度: 每卷前后各空10-20个空格, 中间包装。

3. 材质:

载体: 聚丙烯 (PS), 阻抗 $10^{6-9} \Omega$

上带: 聚乙烯 (PET), 阻抗 $10^{6-11} \Omega$

卷盘: 聚苯乙烯。

纸箱规格: 345*345*23MM

纸箱规格: 345*345*35MM

TOLERANCE UNSPECIFIED		深圳市步步精科技有限公司 TITLE: TYPE-C 6P 防水母座直立式H=6.50 两脚插端子DIP IPX7 带防水圈(USBC-0054IPX7-00)	
.0	±0.35		
.00	±0.25	DRAWN/ DATE 设计 TSP SIZE:A4 UNIT:MM. PART. NO: 126-225-060001-N6G	
.000	±0.15	CHECKED/ DATE 审核 LYX SCALE: 1:1 PROJECTION REV.: 版本	
X.°	±2.00°	APPROVED/ DATE 核准 LJP DWG. PATH 0514-1 SHEET: 页码	
CUSTOMER DRAWING			