

REV	ECN NO	CONTENT	DATE	ENGINEER
A0		INITIAL RELEASE	/	SGF

NOTE:

- MATERIAL SPECIFICATION:
  - HOUSING: PA9T, BLACK
  - CONTACTS: C7025 T=0.15
  - MID PLATE: SUS301 T=0.15
  - SHELL: SUS304 T=0.30;
  - GROUND PLATE: SUS304 T=0.2;
  - MOLDING: LCP, BLACK, UL94 V-0;
- PLATING SPECIFICATION:
  - CONTACTS:
    - Ni 50u" MIN. UNDER PLATED OVER ALL.
    - Au1u" PLATED ON THE FUNCTIONAL AREA OF CONTACT.
    - GOLD FLASH PLATED ON SOLDER AREA.
  - SHELL:
    - Ni 30u" MIN. UNDER PLATED OVER ALL.
  - GROUND PLATE:
    - Ni 30u" MIN. UNDER PLATED OVER ALL.
- MECHANICAL PERFORMANCE,
  - INSERTION FORCE: 0.5~2.0kgf.
  - REMOVAL FORCE: 0.8kgf~2.0kgf.
  - DURABILITY: 10000 CYCLES.
- ELECTRICAL PERFORMANCE,
  - CURRENT RATING: 3.0A  
VOLTAGE RATING: 5.0V
  - INSULATION RESISTANCE: 100MΩ MIN.
  - DIELECTRIC WITHSTAND VOLTAGE, AC 100V FOR 1 MINUTE.
  - LOW CONTACT RESISTANCE: INITIAL 40mΩ AFTER 50mΩ
- ENVIRONMENTAL PERFORMANCE:
  - OPERATING TEMPERATURE: -55°C~+85°C.
- IR REFLOW:
  - THE PEAK TEMPERATURE ON THE BOARD SHALL BE MAINTAINED FOR 10 SECONDS AT 260°C.
- Water Resistance: IPX8

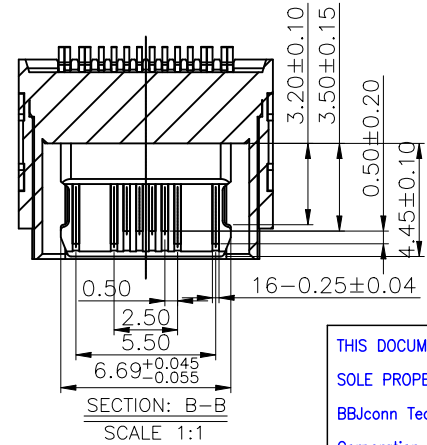
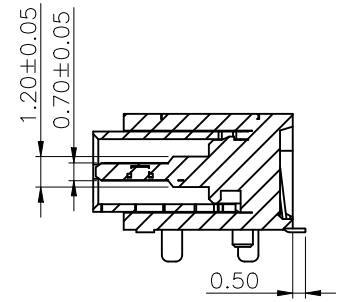
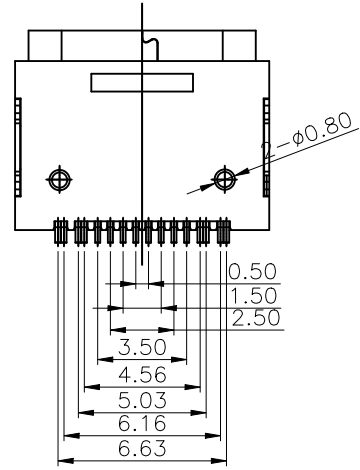
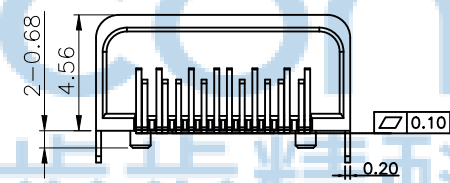
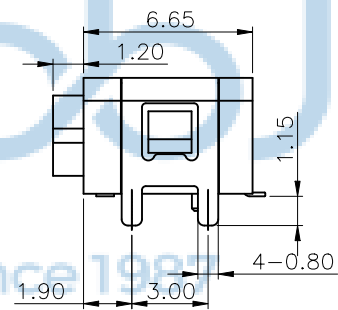
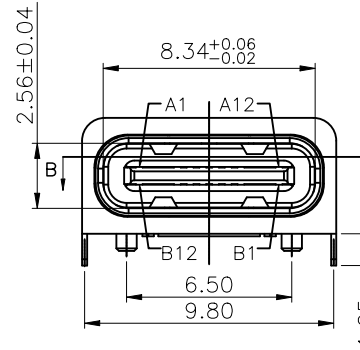
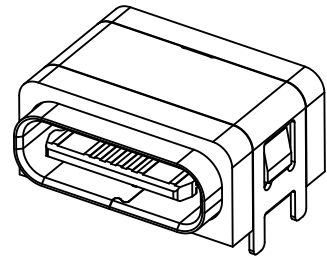
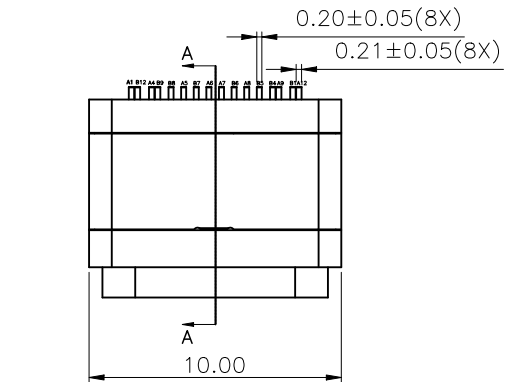

THIS DOCUMENT IS THE  
SOLE PROPERTY OF  
BBJconn Technology Co.,Ltd.  
Corporation AND SHOULD  
NOT BE USED IN WHOLE  
PRIOR WRITTEN PERMISSION.  
PDWG NO: 0366-2

深圳市步步精科技有限公司 工程 部		NAME: TYPE-C 16P 防水母座 90度 板上四脚插 带柱 端子SMT IPX8 7x1黑色0型防水圈 L=7.85 编带	
APPD	JM_Zheng	PJ NO: 126-221-160012-N5G SIZE:A4   DRW NO:	FINISH:SEE NOTES   MAT'L:SEE NOTES SCALE:N/A   REV:A0   UNIT:mm   PAGE:1/3
CHKD	LYX		
DR	SGF		

REV	ECN NO	CONTENT	DATE	ENGINEER
AO		INITIAL RELEASE	/	SGF

密封开孔参考尺寸(只供参考),组装外壳时需要打环保润滑油

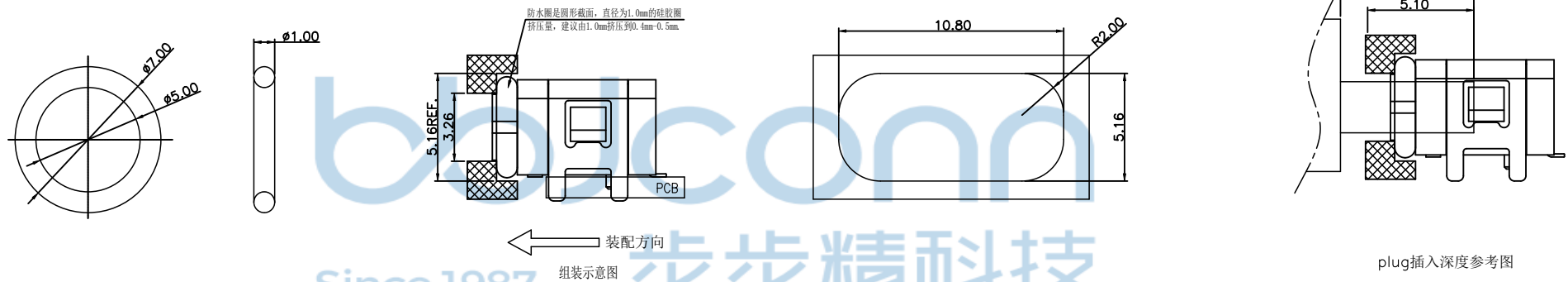

胶圈使用尺寸参考图

PIN ASSIGNMENT:

Pin No.	Signal Name	Pin No.	Signal Name
A1	GND	B12	GND
A2		B11	
A3		B10	
A4	VBUS	B9	VBUS
A5	CC1	B8	SBU2
A6	D+	B7	D-
A7	D-	B6	D+
A8	SBU1	B5	CC2
A9	VBUS	B4	VBUS
A10		B3	
A11		B2	
A12	GND	B1	GND

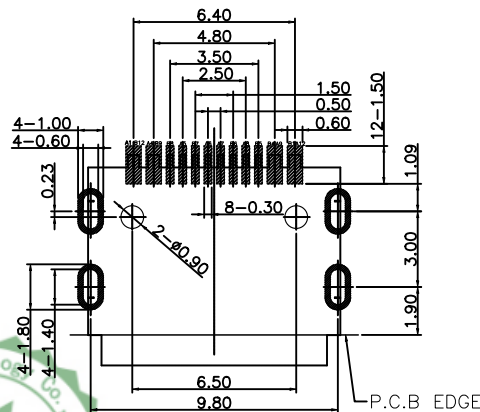

RECOMMENDED P.C.B. LAYOUT  
TOLERANCE UNSPECIFIED ±0.05mm

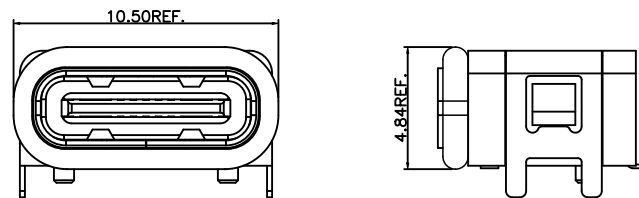

Added suction waterproof ring view

THIS DOCUMENT IS THE  
SOLE PROPERTY OF  
BBJconn Technology Co.,Ltd.  
Corporation AND SHOULD  
NOT BE USED IN WHOLE  
PRIOR WRITTEN PERMISSION.

**深圳市步步精科技有限公司**

.X: ±0.38 X': ±3"  
.XX: ±0.25 .X': ±2"  
.XXX: ±0.13 .XX': ±1"

NAME: TYPE-C 16P 防水母座 90度 板上四脚插 带柱  
端子SMT IPX8 7x1黑色O型防水圈 L=7.85 编带

APPD JM\_Zheng

PJ NO: 126-221-160012-N5G

CHKD LYX

SIZE:A4 DRW NO:

PDWG NO: 0366-2

DR SGF

FINISH:SEE NOTES MAT'L:SEE NOTES

SCALE:N/A REV:A0 UNIT:mm PAGE:2/3

REV	ECN NO	CONTENT	DATE	ENGINEER
AO		INITIAL RELEASE	/	SGF

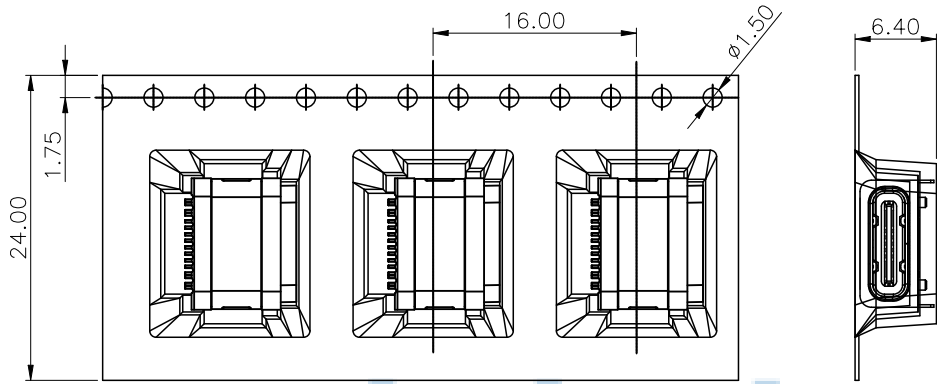

① 产品入载带示意图

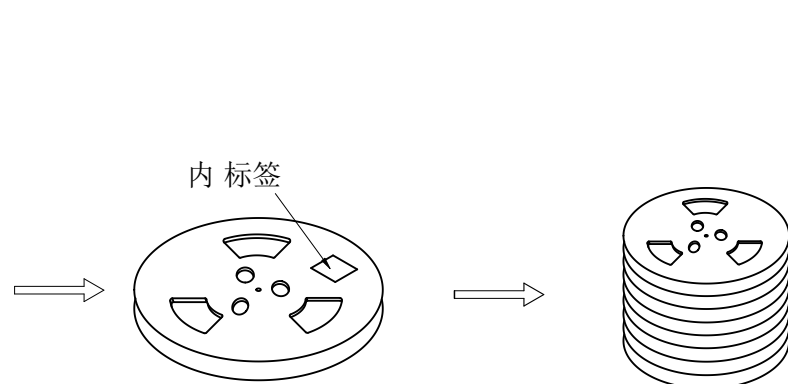

② 卷盘贴标签示意图

③ 产品叠层示意图

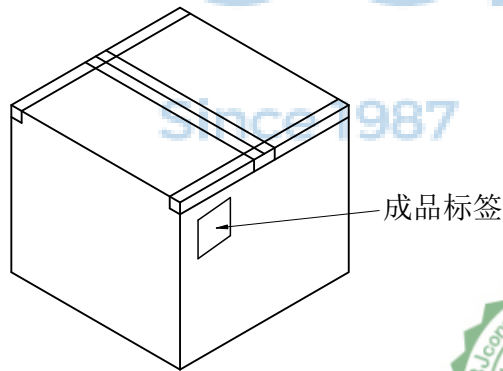

⑤ 外箱封箱示意图

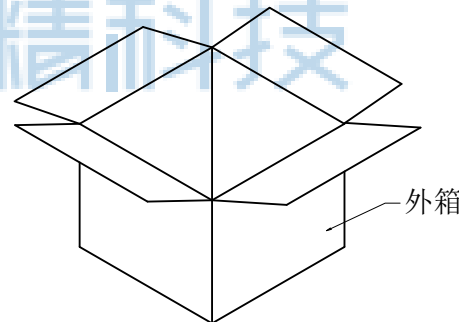

④ 产品入外箱示意图



	REEL	CARTON
CONNECTOR (PCS)	700	7700

包装说明:

1. 将检验好的成品;对插口朝前放入载带;每卷装700PCS产品;具体如图一所示
2. 将包装好的产品;每盘必需贴上内标签;具体如图二所示
3. 将贴好内标签的产品每7盘叠;具体如图三所示
5. 装好后并封好纸箱及贴好相关标签;具体如图五所示;  
(产品包装的标签,如客户有要求,请按客户要求包装出货)
6. 载带前面留16PCS空格,后面留16PCS空格

THIS DOCUMENT IS THE  
SOLE PROPERTY OF  
BBJconn Technology Co.,Ltd.  
Corporation AND SHOULD  
NOT BE USED IN WHOLE  
PRIOR WRITTEN PERMISSION.  
PDWG NO: 0366-2

深圳市步步精科技有限公司			
.X: ±0.38	X': ±3'	NAME: TYPE-C 16P 防水母座 90度 板上四脚插 带柱	
.XX: ±0.25	.X': ±2'	端子SMT 1PX8 7x1黑色O型防水圈 L=7.85 编带	
.XXX: ±0.13	.XX': ±1'	PJ NO: 126-221-160012-N5G	
APPD	JM_Zheng	SIZE:A4   DRW NO:	
CHKD	LYX	FINISH:SEE NOTES   MAT'L:SEE NOTES	
DR	SGF	SCALE:N/A   REV:A0   UNIT:mm   PAGE:3/3	