

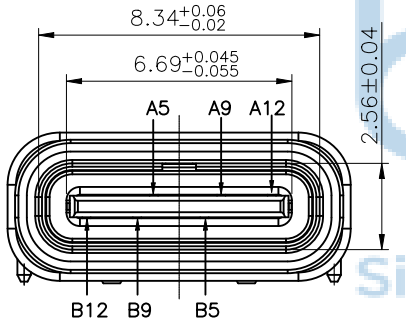

REV	ECN NO	CONTENT	DATE	ENGINEER
A0		INITIAL RELEASE	/	SGF

Note:  
 1.Material:  
 1.1 Housing: LCP, BLACK  
 1.2 Contact: C7025, T=0.20mm  
 1.3 Shell: Zinc alloy  
 2.ELECTRICAL:  
 2-1:CURRENT RATING:  
 VBUS AND GND CONTACTS RATED AT 1.25A PARALLELED FOR A TOTAL OF 3A;  
 2-2:INITIAL CONTACT RESISTANCE :40 MEGOHMS  
 2-3:DIELECTRIC WITHSTANDING VOLTAGE:  
 100V AC MIN;  
 3.PLATING SPECIFICATION:  
 3-1.CONTACTS:  
 Ni 50u" MIN.UNDER PLATED OVER ALL.  
 Au1u" PLATED ON THE FUNCTIONAL AREA OF CONTACT.GOLD FLASH PLATED ON SOLDER AREA.  
 3-2.SHELL:  
 Ni 30u" MIN.UNDER PLATED OVER ALL.  
 4.MECHANICAL CHARACTERISTICS:  
 4-1:MATING FORCE:5~20N  
 4-2:UNMATING FORCE:8~20N, 6~20N  
 4-3:OPERATING TEMPERATURE ;-40~80°.  
 5.IR REFLOW:  
 THE PEAK TEMPERATURE ON THE BOARD SHALL BE MAINTAINED FOR 10 SECONDS AT 260°C.

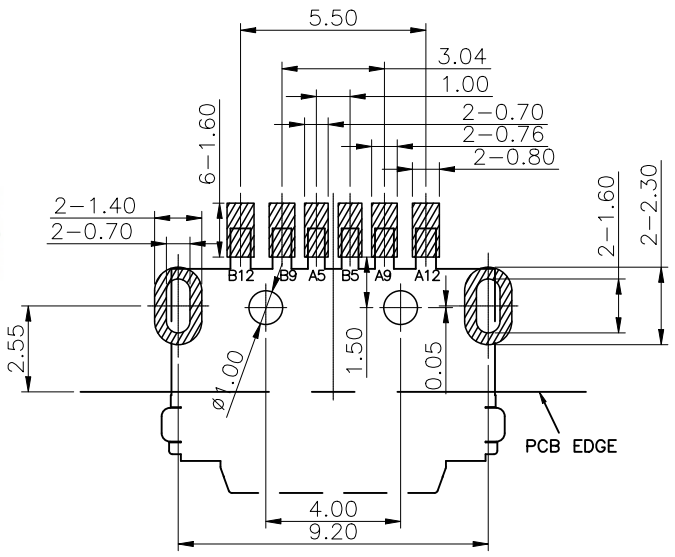
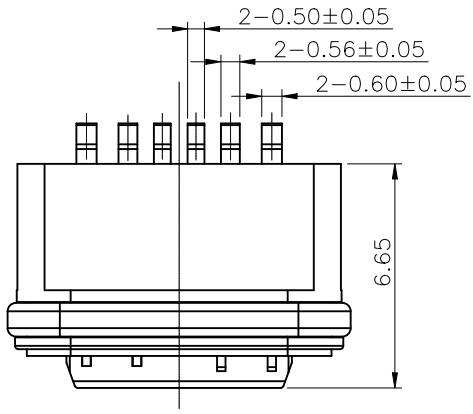

RECOMMENDED P.C.B. LAYOUT  
 TOLERANCE UNSPECIFIED ±0.05mm

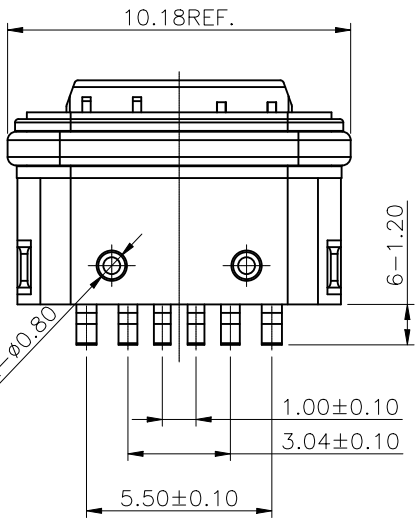
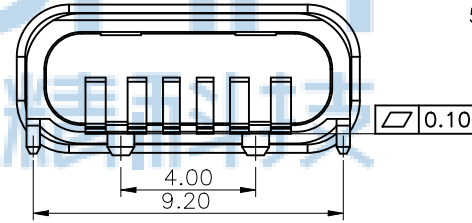
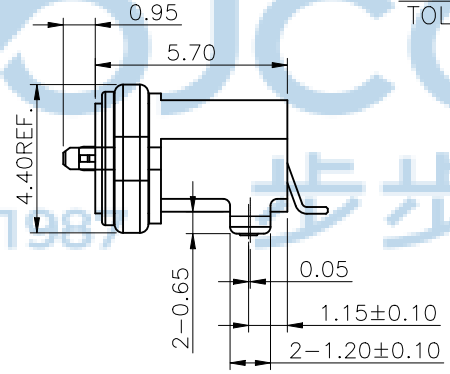

USB TYPE-C PIN ASSIGNMENTS:

A5	CC1	B12	GND
A9	VBUS	B9	VBUS
A12	GND	B5	CC2
PIN	SIGNAL NAME	PIN	SIGNAL NAME

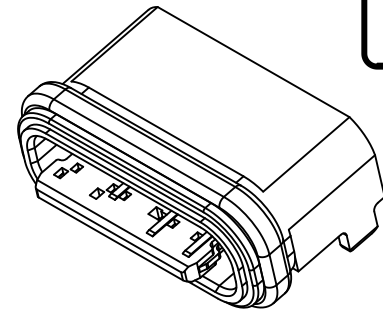

THIS DOCUMENT IS THE SOLE PROPERTY OF BBJconn Technology Co.,Ltd. Corporation AND SHOULD NOT BE USED IN WHOLE PRIOR WRITTEN PERMISSION.

PDWG NO: 0366-2

**深圳市步步精科技有限公司**

.X: ±0.38	X': ±3'	NAME: TYPE-C 6P 防水母座 板上两脚插 带柱 L=5.70
.XX: ±0.25	.X': ±2'	舌片外露0.95 端子SMT 锌合金外壳 IPX7 编带
.XXX: ±0.13	.XX': ±1'	
APPD	JM_Zheng	PJ NO: 126-221-060006-N5G
CHKD	LYX	SIZE:A4   DRW NO:
DR	SGF	FINISH:SEE NOTES   MAT'L:SEE NOTES
		SCALE:N/A   REV:A0   UNIT:mm   PAGE:1/3

REV	ECN NO	CONTENT	DATE	ENGINEER
A0		INITIAL RELEASE	/	SGF

密封开孔参考尺寸(只供参考), 组装外壳时需要打环保润滑油

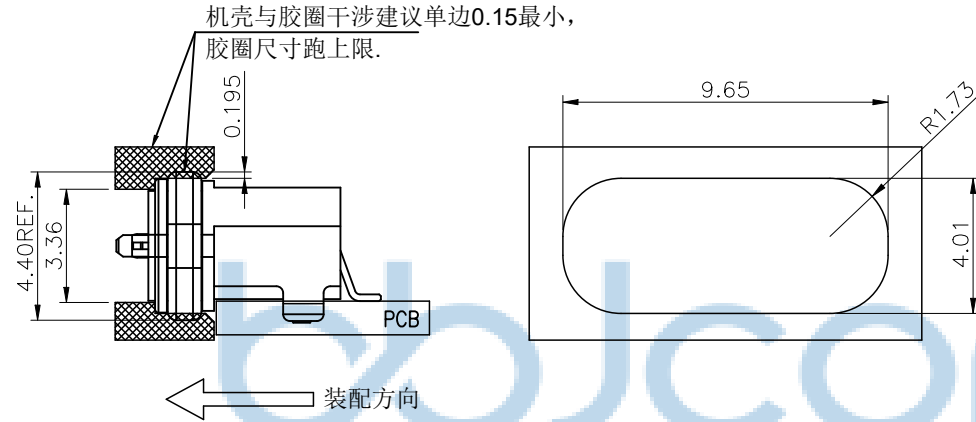

组装示意图

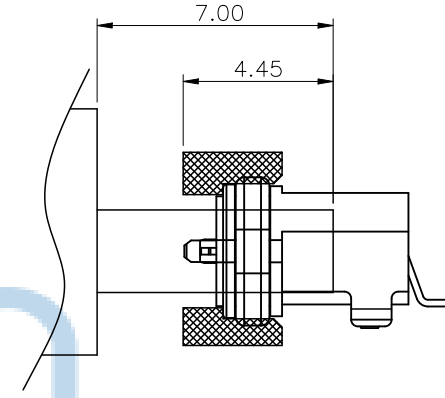

plug插入深度参考图

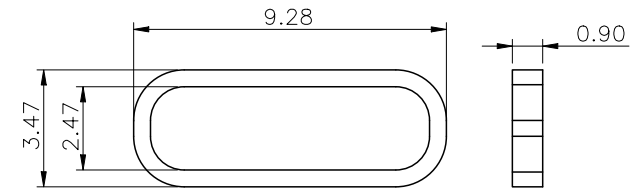

胶圈使用尺寸参考图



THIS DOCUMENT IS THE SOLE PROPERTY OF BBJconn Technology Co.,Ltd. Corporation AND SHOULD NOT BE USED IN WHOLE PRIOR WRITTEN PERMISSION.		深圳市步步精科技有限公司 工程部	
PDWG NO: 0366-2	APPD: JM_Zheng CHKD: LYX DR: SGF	.X: ±0.38 .XX: ±0.25 .XXX: ±0.13 X': ±3" X'': ±2" XX': ±1"	NAME: TYPE-C 6P 防水母座 板上两脚插 带柱 L=5.70 舌片外露0.95 端子SMT 锌合金外壳 IPX7 编带 PJ NO: 126-221-060006-N5G SIZE:A4   DRW NO: FINISH:SEE NOTES   MAT'L:SEE NOTES SCALE:N/A   REV:A0   UNIT:mm   PAGE:2/3

REV	ECN NO	CONTENT	DATE	ENGINEER
AO		INITIAL RELEASE	/	SGF

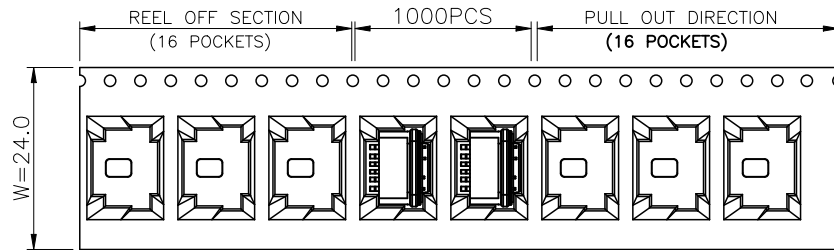

① 产品入载带示意图

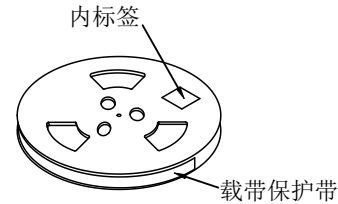

② 卷盘贴标签示意图

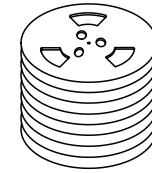

③ 11盘产品叠层示意图

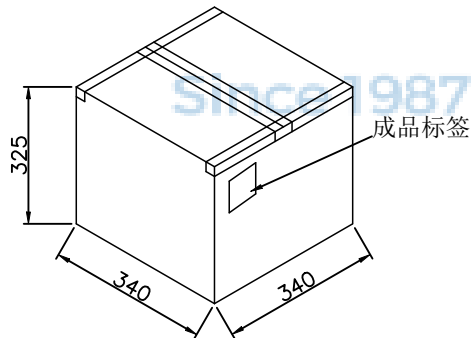

⑤ 外箱封箱示意图

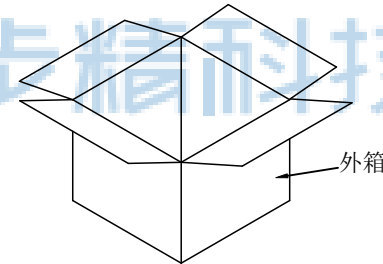

④ 产品入外箱示意图



**包装说明:**

- 将检验好的成品;SMT朝下放入载带底部;每卷装1000PCS产品;
- 将包装好的产品;每盘必须贴上内标签;
- 将贴好内标签的产品每11盘叠;
- 装好后并封好纸箱及贴好相关标签;  
(产品包装的标签,如客户有要求,请按客户要求包装出货)
- 载带前面留16PCS空格,后面留16PCS空格
- COVER与CARRY剥离力:50-125g,速度:300mm/分钟左右,剥离角度:165°-180°



	REEL	CARTON
CONNECTOR (PCS)	1000	11000

THIS DOCUMENT IS THE SOLE PROPERTY OF BBJconn Technology Co.,Ltd. Corporation AND SHOULD NOT BE USED IN WHOLE PRIOR WRITTEN PERMISSION.		<b>深圳市步步精科技有限公司</b> .X: ±0.38 X': ±3" .XX: ±0.25 X'': ±2" .XXX: ±0.13 .XX': ±1"		NAME: TYPE-C 6P 防水母座 板上两脚插 带柱 L=5.70 舌片外露0.95 端子SMT 锌合金外壳 IPX7 编带	
APPD	JM_Zheng	PJ NO: 126-221-060006-N5G SIZE:A4 DRW NO:	FINISH:SEE NOTES		MAT'L:SEE NOTES
CHKD	LYX		SCALE:N/A	REV:A0	UNIT:mm
PDWG NO: 0366-2	DR	SGF			