

REV	ECN NO	CONTENT	DATE	ENGINEER
A0		INITIAL RELEASE	/	SGF

NOTE:

1.MATERIAL SPECIFICATION:

- 1-1.HOUSING: PA9T, BLACK
- 1-2.CONTACTS: C7025 T=0.15
- 1-3.MID PLATE: SUS301 T=0.15
- 1-4.SHELL: SUS304 T=0.30;
- 1-5.GROUND PLATE: SUS304 T=0.2;
- 1-6.MOLDING: LCP, BLACK, UL94 V-0;

2.PLATING SPECIFICATION:

2-1.CONTACTS:

Ni 50u" MIN. UNDER PLATED OVER ALL.
Au1u" PLATED ON THE FUNCTIONAL AREA OF CONTACT.
GOLD FLASH PLATED ON SOLDER AREA.

2-2.SHELL:

Ni 30u" MIN. UNDER PLATED OVER ALL.

2-3.GROUND PLATE:

Ni 30u" MIN. UNDER PLATED OVER ALL.

3.MECHANICAL PERFORMANCE,

- 3-1.INSERTION FORCE: 0.5~2.0kgf.
- 3-2.REMOVAL FORCE: 0.8kgf~2.0kgf.
- 3-3.DURABILITY: 10000 CYCLES.

4.ELECTRICAL PERFORMANCE,

- 4-1. CURRENT RATING: 3.0A
VOLTAGE RATING: 5.0V
- 4-2.INSULATION RESISTANCE: 100MΩ MIN.
- 4-3.DIELECTRIC WITHSTAND VOLTAGE, AC 100V FOR 1 MINUTE.
- 4-4.LOW CONTACT RESISTANCE: INITIAL 40mΩ AFTER 50mΩ

5. ENVIRONMENTAL PERFORMANCE:

OPERATING TEMPERATURE: -55°C~+85°C.

6.IR REFLOW:

THE PEAK TEMPERATURE ON THE BOARD SHALL
BE MAINTAINED FOR 10 SECONDS AT 260°C.

7.Water Resistance: IPX8

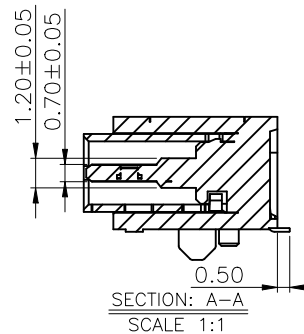
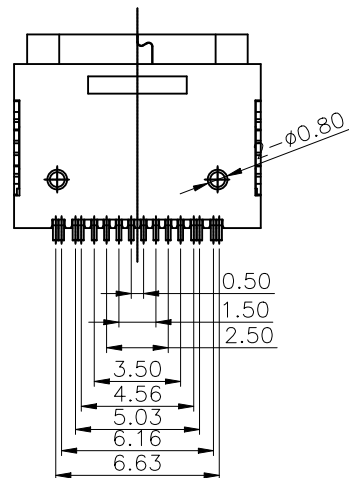
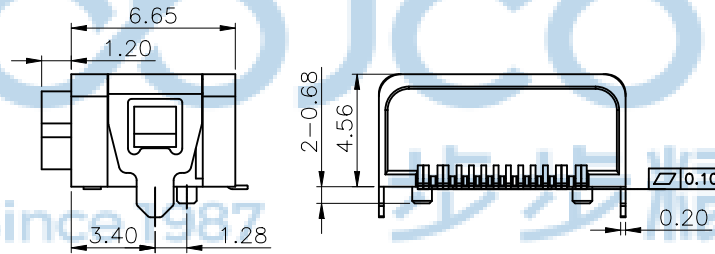
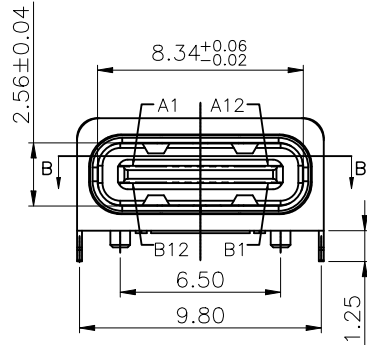
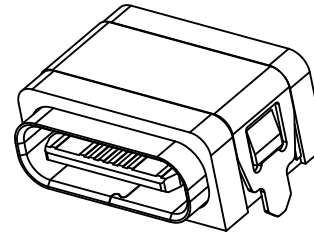
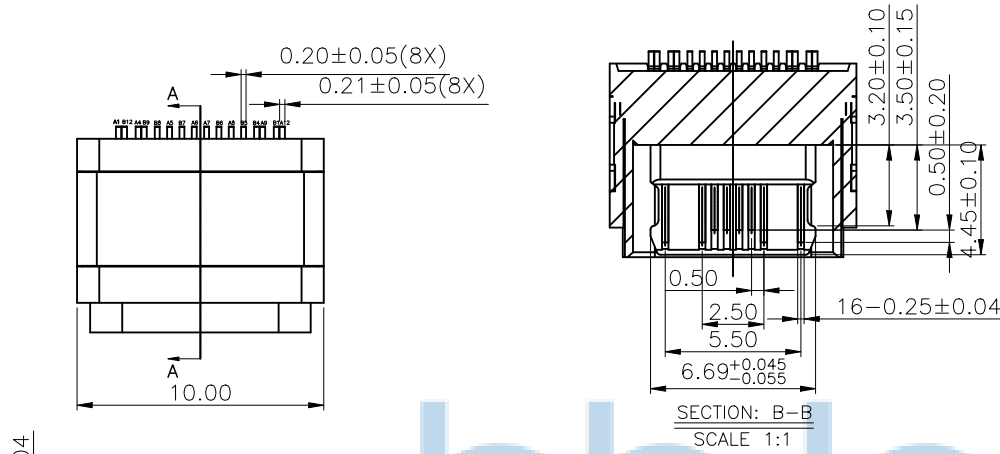

THIS DOCUMENT IS THE
SOLE PROPERTY OF
BBJconn Technology Co.,Ltd.
Corporation AND SHOULD
NOT BE USED IN WHOLE
PRIOR WRITTEN PERMISSION.
PDWG NO: 0366-2

深圳市步步精科技有限公司 工程 部		NAME: TYPE-C 16P 防水母座 两脚插 端子SMT 带柱 带 中夹片 L=7.85 不锈钢外壳 PA9T黑胶 IPX8 编带	
		PJ NO: 126-221-160027-N5G SIZE: A4 DRW NO:	FINISH: SEE NOTES MAT'L: SEE NOTES SCALE: N/A REV: A0 UNIT: mm PAGE: 1/3
APPD	JM_Zheng	DR	SGF

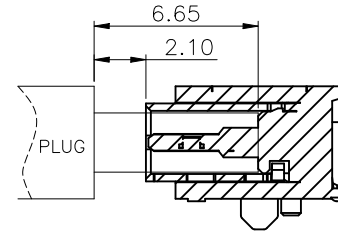
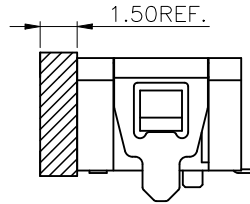
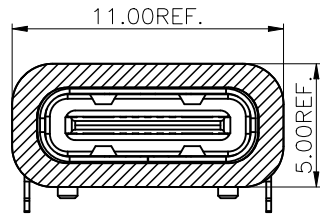

AFTER MATING

Added suction waterproof ring view

PIN ASSIGNMENT:

Pin No.	Signal Name	Pin No.	Signal Name
A1	GND	B12	GND
A2		B11	
A3		B10	
A4	VBUS	B9	VBUS
A5	CC1	B8	SBU2
A6	D+	B7	D-
A7	D-	B6	D+
A8	SBU1	B5	CC2
A9	VBUS	B4	VBUS
A10		B3	
A11		B2	
A12	GND	B1	GND

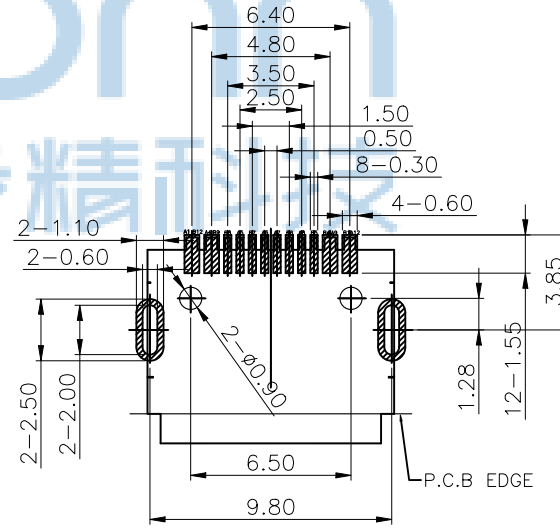

RECOMMENDED P.C.B. LAYOUT
TOLERANCE UNSPECIFIED ±0.05mm



THIS DOCUMENT IS THE SOLE PROPERTY OF BBJconn Technology Co.,Ltd. Corporation AND SHOULD NOT BE USED IN WHOLE PRIOR WRITTEN PERMISSION.	深圳市步步精科技有限公司		NAME: TYPE-C 16P 防水母座 两脚插 端子SMT 带柱 带中夹片 L=7.85 不锈钢外壳 PA9T黑胶 IPX8 编带	
	APPD	JM_Zheng	PJ NO: 126-221-160027-N5G	SIZE:A4 DRW NO:
CHKD	LYX	FINISH:SEE NOTES		MAT'L:SEE NOTES
PDWG NO: 0366-2	DR	SGF	SCALE:N/A	REV:A0 UNIT:mm PAGE:2/3

REV	ECN NO	CONTENT	DATE	ENGINEER
AO		INITIAL RELEASE	/	SGF

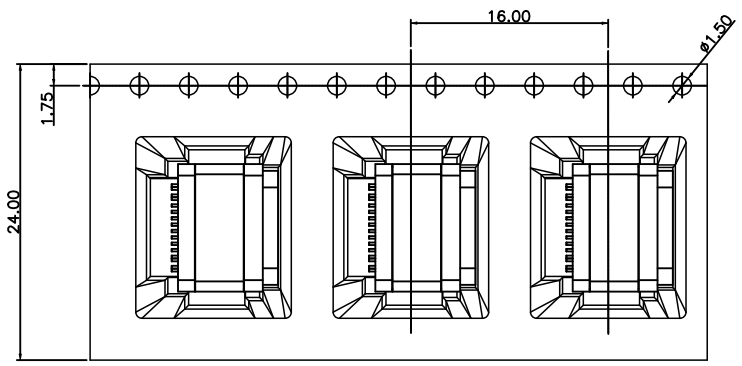

① 产品入载带示意图

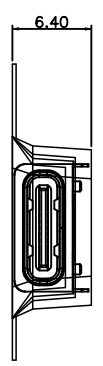

② 卷盘贴标签示意图

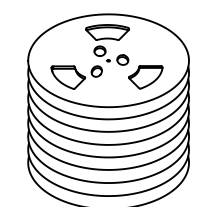
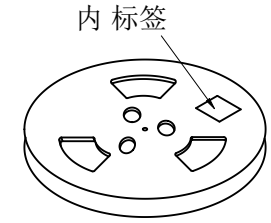

③ 产品叠层示意图

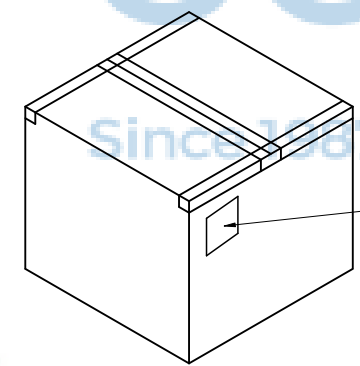

⑤ 外箱封箱示意图

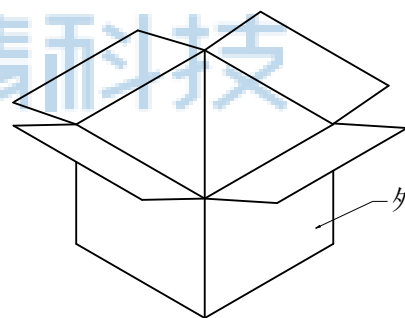

④ 产品入外箱示意图



- 包装说明:
1. 将检验好的成品;对插口朝前放入载带;每卷装700PCS产品;具体如图一所示
 2. 将包装好的产品;每盘必需贴上内标签;具体如图二所示
 3. 将贴好内标签的产品每11盘叠;具体如图三所示
 5. 装好后并封好纸箱及贴好相关标签;具体如图五所示;
(产品包装的标签,如客户有要求,请按客户要求包装出货)
 6. 载带前面留16PCS空格,后面留16PCS空格

	REEL	CARTON
CONNECTOR (PCS)	700	7700

THIS DOCUMENT IS THE SOLE PROPERTY OF BBJconn Technology Co.,Ltd. Corporation AND SHOULD NOT BE USED IN WHOLE PRIOR WRITTEN PERMISSION.

PDWG NO: 0366-2

DR SGF

深圳市步步精科技有限公司

NAME: TYPE-C 16P 防水母座 两脚插 端子SMT 带柱 带 中夹片 L=7.85 不锈钢外壳 PA9T黑胶 IPX8 编带

PJ NO: 126-221-160027-N5G

SIZE:A4 DRW NO:

FINISH:SEE NOTES MAT'L:SEE NOTES

SCALE:N/A REV:AO UNIT:mm PAGE:3/3