

REV.	ECN NO	CONTENT	DATE	ENGINEER
AO		Initial release		LYX

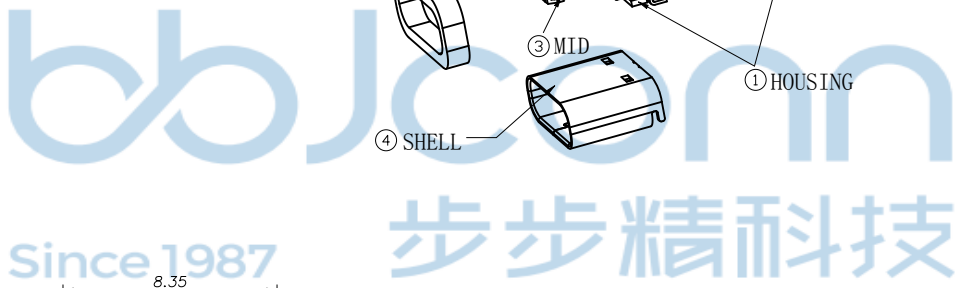

**NOTE:**

- MATERIAL SPECIFICATION:**
  - HOUSING: HIGH TEMPERATURE RESISTANT PLASTIC, UL94 V-0.
  - CONTACTS: COPPER ALLOY
  - MID PLATE: STAINLESS STEEL
  - SHELL: STAINLESS STEEL
  - COVER: STAINLESS STEEL
  - O-RING: SILICONE RUBBER, BLACK
- PLATING SPECIFICATION:**
  - CONTACTS:
    - Ni 50u" MIN. UNDER PLATED OVER ALL.
    - Au 1u" ON THE FUNCTIONAL AREA OF CONTACT.
    - MATTE Sn ON THE SOLDER AREA OF CONTACT.
  - SHELL:
    - Ni 30u" MIN. UNDER PLATED OVER ALL.
  - COVER:
    - Ni 30u" MIN. UNDER PLATED OVER ALL.
  - MID PLATE:
    - CLEAR ONLY.
- MECHANICAL PERFORMANCE,**
  - INSERTION FORCE: 5~20N.
  - REMOVAL FORCE: 8~20N.
  - DURABILITY: 10000 CYCLES.
- ELECTRICAL PERFORMANCE,**
  - CURRENT RATING: 3.0A  
VOLTAGE RATING: 5.0V
  - LLCR:
    - VBUS & GND PINS AND OTHER PINS: 40mΩ/PIN MAX.
    - SHIELD: 50mΩ /MAX.
    - LLCR MAX. CHANGE OF ALL PINS: 10mΩ .
  - INSULATION RESISTANCE: 100MΩ MIN
  - DIELECTRIC WITHSTAND VOLTAGE, AC 100V FOR 1 MINUTE.
- ENVIRONMENTAL PERFORMANCE:**
  - OPERATING TEMPERATURE: -30°C~+85°C.
- IR REFLOW:**
  - THE PEAK TEMPERATURE ON THE BOARD SHALL BE MAINTAINED FOR 10 SECONDS AT 260°C.

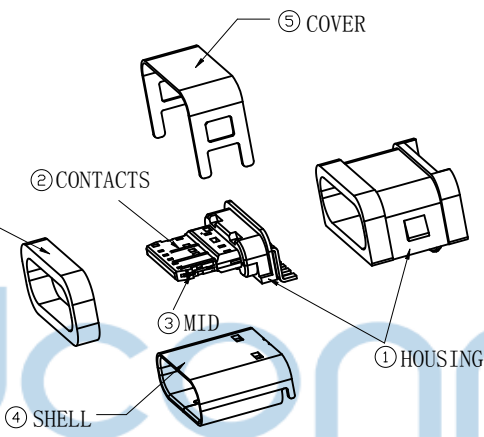
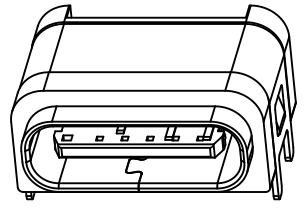
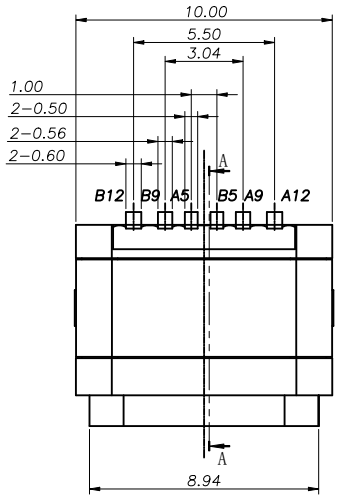
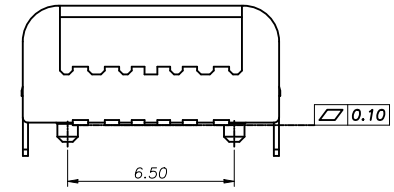
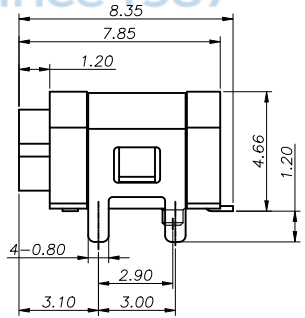
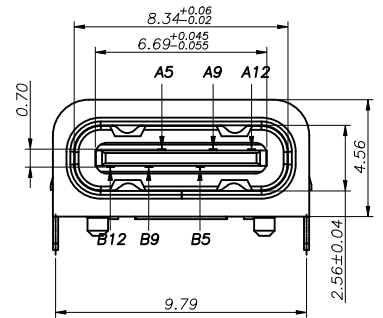

**PIN ASSIGNMENT:**

PIN NO.	A1&B12	A4&B9	A5	B5	A9&B4	A12&B1
SIGNAL NAME	GND	VBUS	CC1	CC2	VBUS	GND
PCB PAD NO.	C1	C2	C3	C4	C5	C6

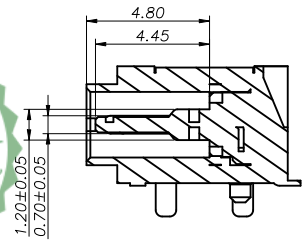
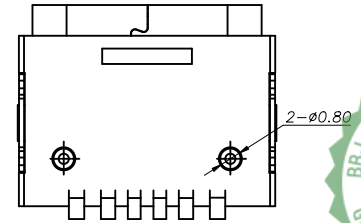

SECTION:A-A

THIS DOCUMENT IS THE SOLE PROPERTY OF BBJconn Technology Co., Ltd. CORPORATION AND SHOULD NOT BE USED IN WHOLE OR IN PART WITHOUT PRIOR WRITTEN PERMISSION.  
PDWG.NO: 0338-1

**深圳市步步精科技有限公司**

NAME: TYPE-C 6P 防水母座 板上四脚插 带柱 点胶 L=7.85 SMT 方形防水圈 IPX7

APPD. JM\_Zheng PJ. NO.: 126-221-060003-J8G  
CHKD. TSP SIZE: A4 DRW NO.:  
FINISH: SEE NOTES MAT'L.: SEE NOTES  
DR. LYX SCALE: N/A REV.: AO UNIT: mm PAGE: 1/3

REV.	ECN NO	CONTENT	DATE	ENGINEER
AO		Initial release		LYX

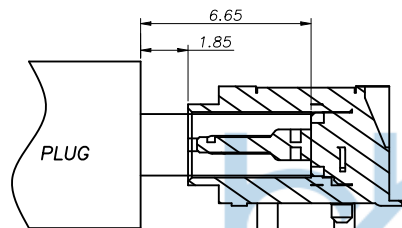

AFTER MATING

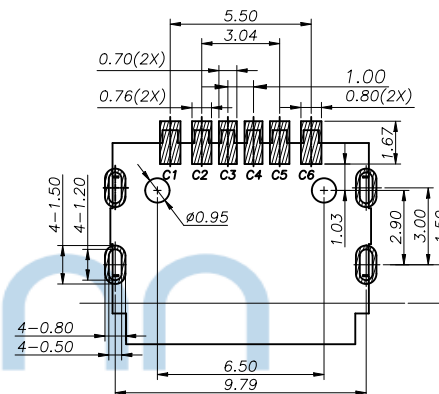

RECOMMENDED P.C.B. LAYOUT  
TOLERANCE UNSPECIFIED  $\pm 0.05\text{mm}$

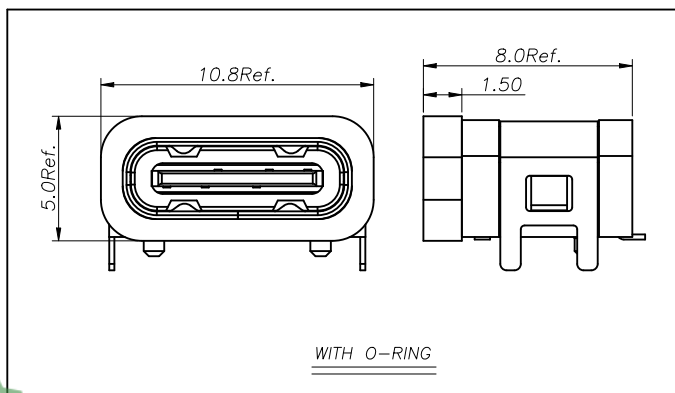

WITH O-RING



THIS DOCUMENT IS THE SOLE PROPERTY OF BBJconn Technology Co.,Ltd. Corporation AND SHOULD NOT BE USED IN WHOLE OR IN PART WITHOUT PRIOR WRITTEN PERMISSION.		 <b>深圳市步步精科技有限公司</b>	
PDWG.NO: 0338-1		.X: $\pm 0.38$ .XX: $\pm 0.25$ .XXX: $\pm 0.13$	X': $\pm 3'$ .X': $\pm 2'$ .XX': $\pm 1'$
APPD.	JM_Zheng	NAME: TYPE-C 6P 防水母座 板上四脚插 带柱 点胶 L=7.85 SMT 方形防水圈 IPX7	
CHKD.	TSP	PJ. NO.: 126-221-060003-J8G	
DR.	LYX	SIZE: A4   DRW NO.:	
		FINISH: SEE NOTES   MAT'L.: SEE NOTES	
		SCALE: N/A   REV.: AO   UNIT: mm   PAGE: 2/3	

REV.	ECN NO	CONTENT	DATE	ENGINEER
AO		Initial release		LYX

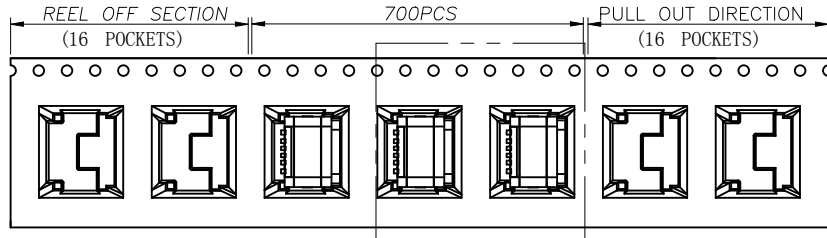

SEE DETAIL X

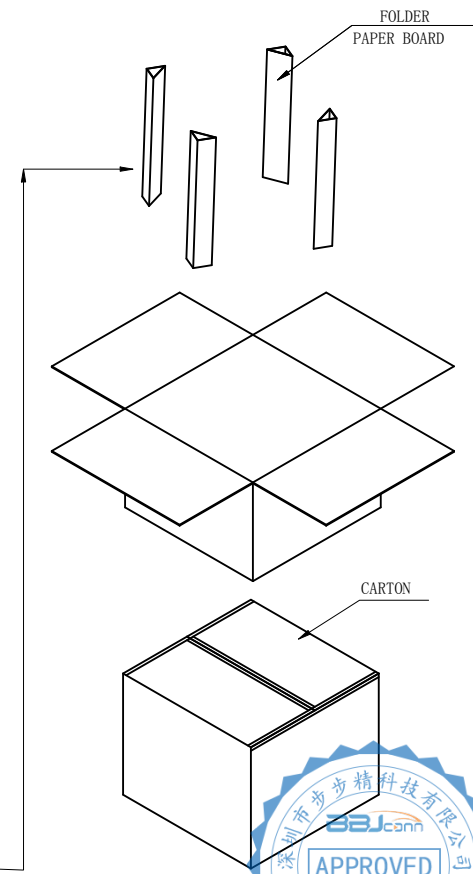
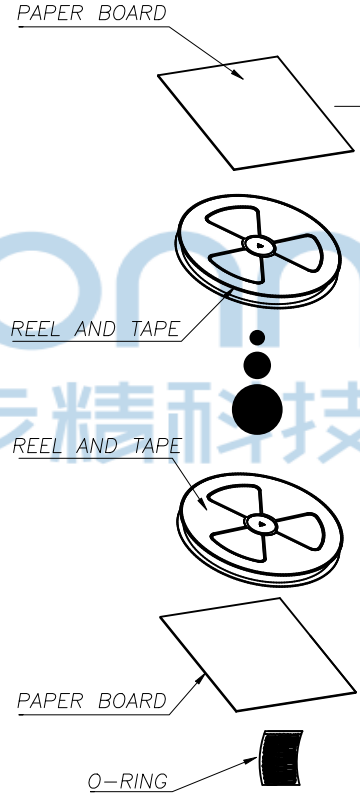
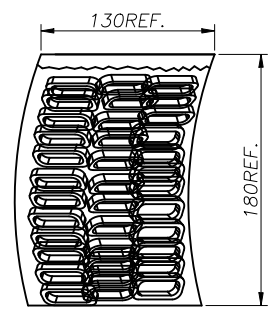
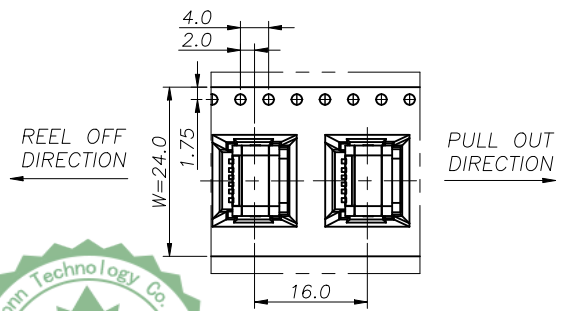
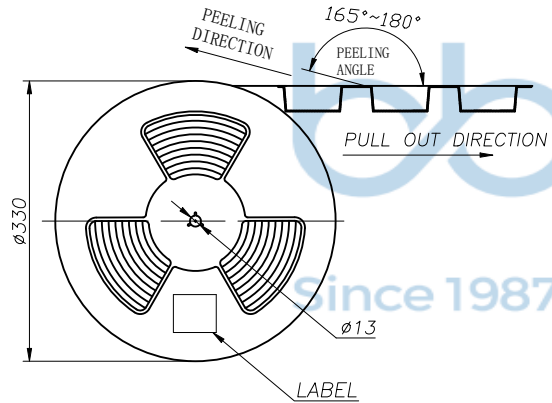

	REEL	CARTON
CONNECTOR (PCS)	700	7000



THIS DOCUMENT IS THE SOLE PROPERTY OF BBJconn Technology Co., Ltd. CORPORATION AND SHOULD NOT BE USED IN WHOLE OR IN PART WITHOUT PRIOR WRITTEN PERMISSION.		<b>深圳市步步精科技有限公司</b>	
.X: ±0.38    .X': ±3' .XX: ±0.25    .X'': ±2' .XXX: ±0.13    .X''': ±1'		NAME: TYPE-C 6P 防水母座 板上四脚插 带柱 点胶 L=7.85 SMT 方形防水圈 IPX7	
APPD.	JM_Zheng	PJ. NO.: 126-221-060003-J8G SIZE: A4   DRW NO.:	FINISH: SEE NOTES    MAT'L.: SEE NOTES
CHKD.	TSP		
PDWG.NO:	0338-1	DR.	LYX
		SCALE: N/A	REV.: AO    UNIT: mm    PAGE: 3/3