

| REV. | ECN NO | CONTENT | DATE | ENGINEER |
|------|--------|-----------------|------|----------|
| A0 | | Initial release | / | LYL |

- 规格型号: Specifications:
电气特性: Electrical:
- 额定电流: Current Rating
1.5A/contact terminal
 - 额定电压: Voltage Rating
30V DC
 - 接触阻抗: Contact Resistance
30 milliohms MAX
 - 耐电压: Dielectric Withstanding Voitage:
500 V AC AT Sea Level
 - 阻抗: Insulation Resistance:
1000MEGA ohms MIN
- 物理性能: Mechanical:
- 插拔力: Connector Mate and Unmate Force
Mate force: 3.57kgf (MAX)
Unmate force: 1.02kgf (MIN)
 - 端子保持力: Terminal Retention
1.0kgf (MIN)
- 原材料: Material:
- 塑膠: Housing:
Hing Temperature Ternmaplastics,
LCP Natural
 - 端子: Contact: Copper Alloy C2680
 - 外壳: Shell: Copper Alloy SPCC
- 端子: Contact: Plated Gold in Mating Area:
Tin On Solder Talls
端子四周鍍30" (MIN) 錫, 鍍金区域鍍100-200" 鍍金1U"
 - 外壳: Shell:
外壳四周鍍80" (MIN) 镍
Nickel Plating

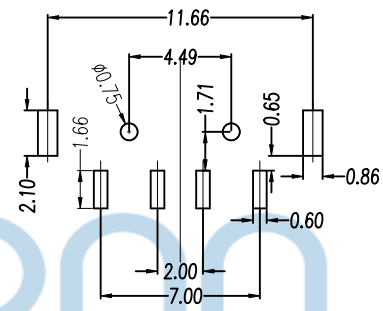

RECOMMENDED P.C.B LAYOUT

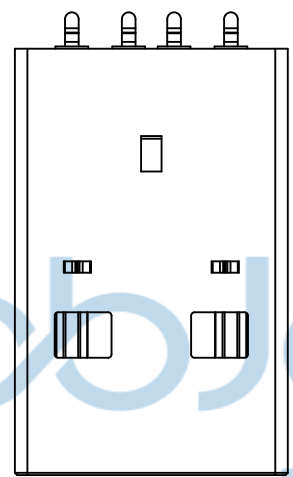
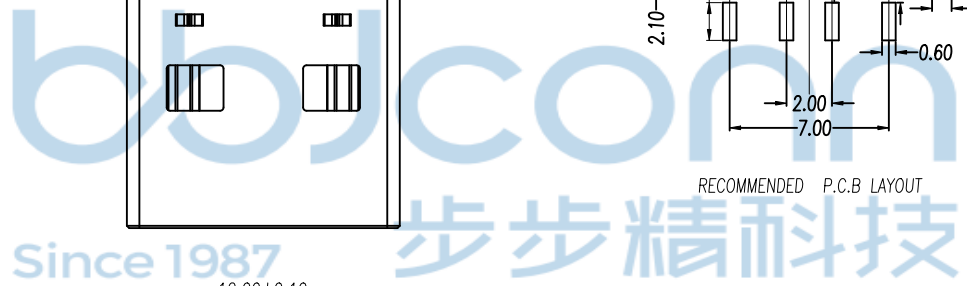
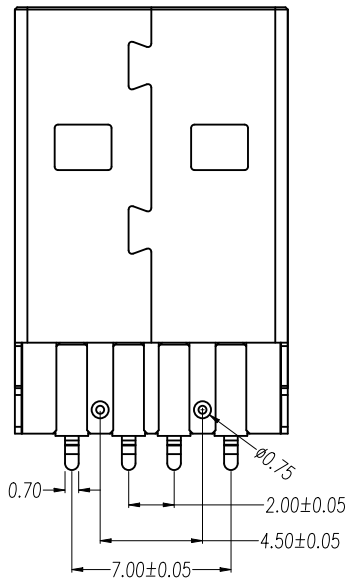
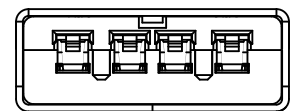
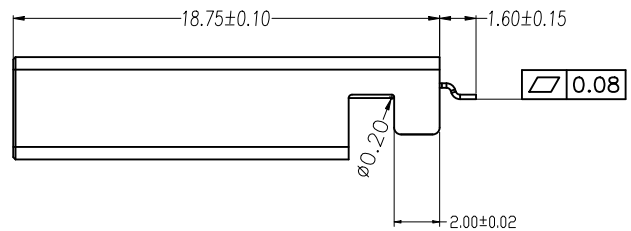
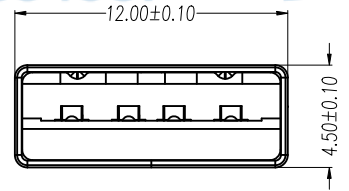
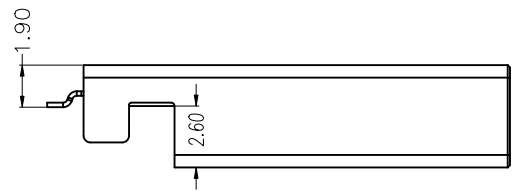

| | | | | | |
|---|----------|---|-----|--|-----------|
| THIS DOCUMENT IS THE SOLE PROPERTY OF BBJconn Technology Co., Ltd. Corporation AND SHOULD NOT BE USED IN WHOLE OR IN PART WITHOUT PRIOR WRITTEN PERMISSION. | | 深圳市步步精科技有限公司 .X: ±0.38 .X': ±3" .XX: ±0.25 .X'': ±2" .XXX: ±0.13 .X''': ±1" | | NAME: USB 2.0 公头 180度 卧式直脚 L=18.75 沉板2.6 带柱 端子SMT 平口 LCP本色 铁壳 | |
| APPD. | JM_Zheng | PJ. NO.: 127-174-040009-W7G | | SIZE: A4 DRW NO.: | |
| CHKD. | LYX | FINISH: SEE NOTES | | MAT'L.: SEE NOTES | |
| PDWG.NO: | 0383-1 | DR. | LYL | SCALE: N/A | REV.: A0 |
| | | | | UNIT: mm | PAGE: 1/2 |

1. 把已全檢好的 USB AF 180度公头系列 成品, 装入專用的吸塑盘內, 每盤裝100PCS;

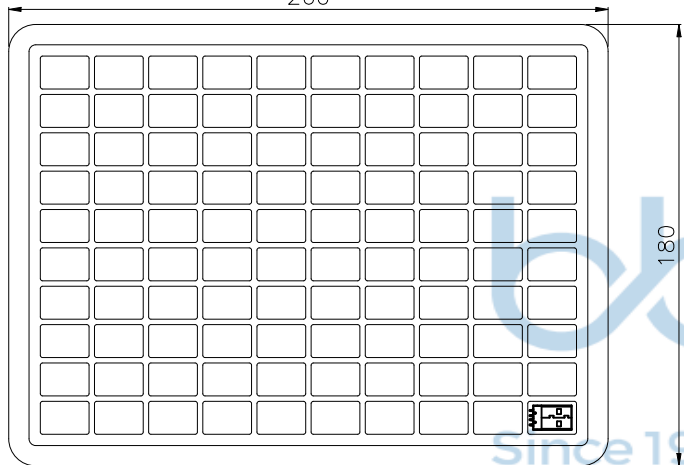

2. 产品放滿100PCS 后, 盖上下盖后使用订书机锁边, 然后层叠10盘打包1摞1000PCS的, 并用打包模捆好(如下图).

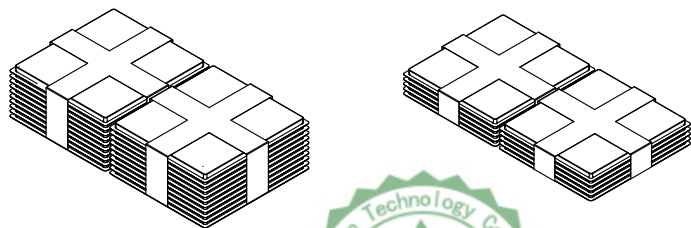

3. 将叠好的产品, 按圖示用PE模捆扎, 后装入紙箱, 每箱裝6摞, 6000PCS

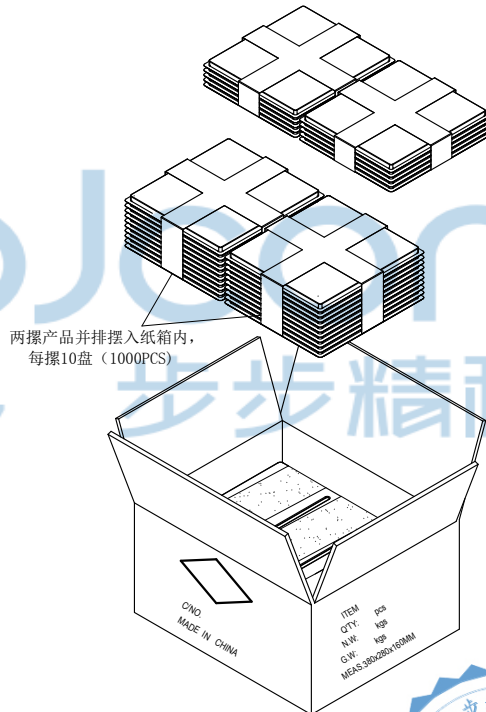

4. 外箱规格及外箱标签贴附要求.
(客户指定要求之标签及规格参照“客户包装规范”)

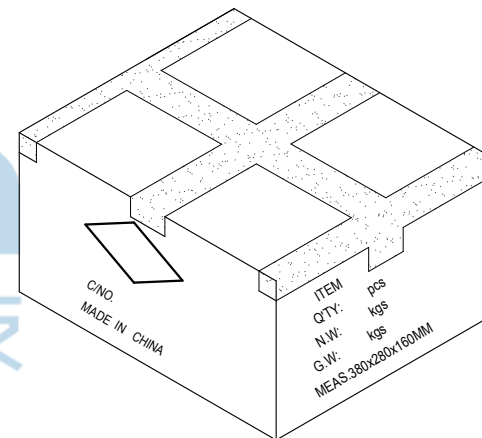

尺寸: 380*280*160mm



| 包材清单: | | | | 包装数量 | |
|-------|----|-------|--------|------|-----------|
| 品名规格: | 料号 | 单重(g) | 数量 | 成品单重 | G/PCS |
| 吸塑盒下盘 | | | 60 PCS | | 100PCS/盒 |
| 吸塑盒上盖 | | | 60 PCS | | |
| 纸箱 | | | 1 PCS | | 6000PCS/箱 |

| | | | | | | | |
|---|--|-----------------|--|--|--|--|--|
| THIS DOCUMENT IS THE SOLE PROPERTY OF BBJconn Technology Co., Ltd. Corporation AND SHOULD NOT BE USED IN WHOLE OR IN PART WITHOUT PRIOR WRITTEN PERMISSION. | | PDWG.NO: 0383-1 | | 深圳市步步精科技有限公司 APPD. JM_Zheng CHKD. LYX DR. LYL | | NAME: USB 2.0 公头 180度 卧式直脚 L=18.75 沉板2.6 带柱 端子SMT 平口 LCP本色 铁壳 PJ. NO.: 127-174-040009-W7G SIZE: A4 DRW NO.: FINISH: SEE NOTES MAT'L.: SEE NOTES SCALE: N/A REV.: A0 UNIT: mm PAGE: 2/2 | |
|---|--|-----------------|--|--|--|--|--|